

1
BUILDING 400 DEMOLITION FLOOR PLAN
1/8" = 1'-0"

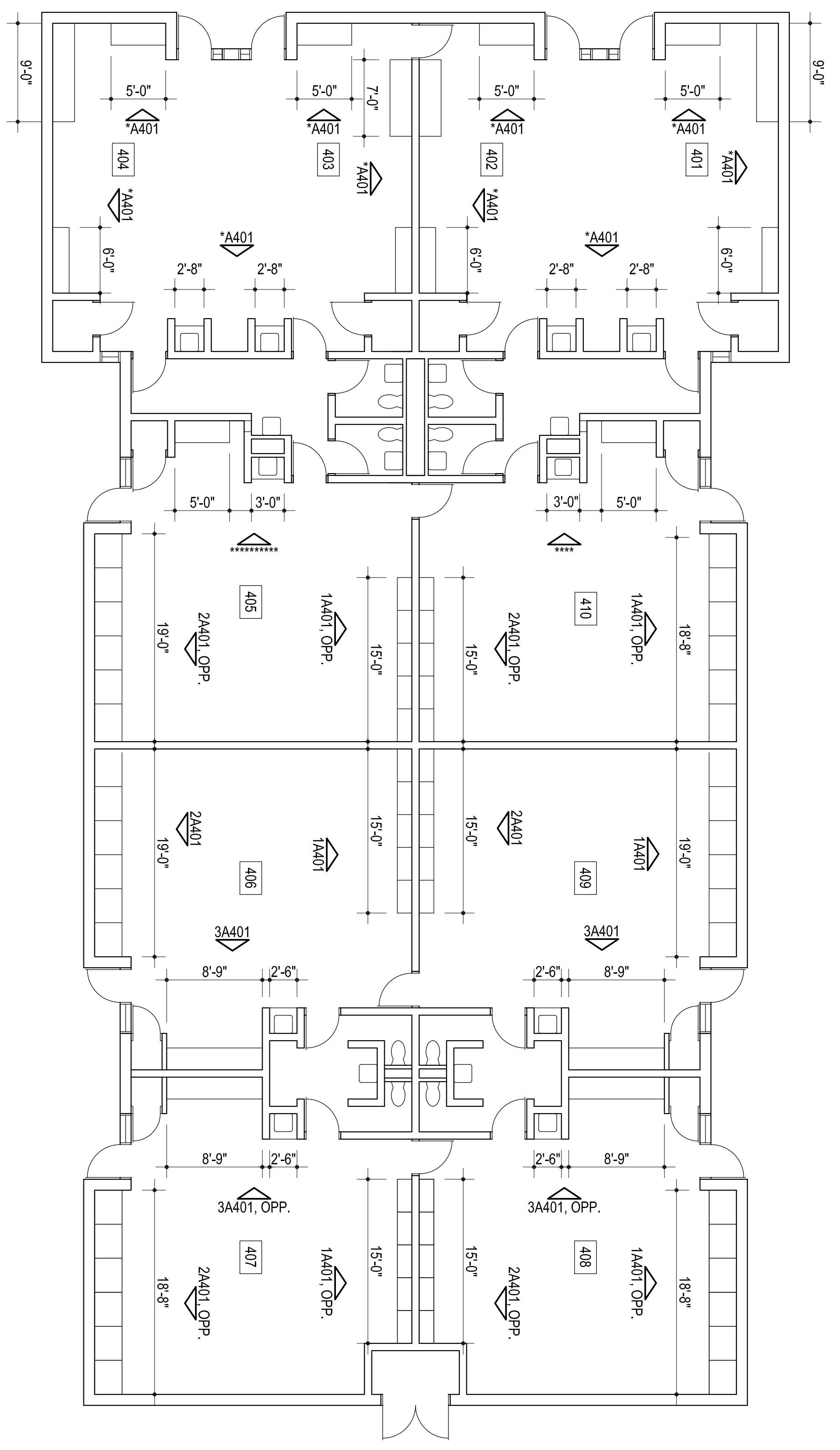

2
BUILDING 400 FLOOR PLAN
1/8" = 1'-0"

GENERAL NOTE:

- 1 REMOVE / DEMOLISH EXISTING BASE / WALL CABINETS COMPLETELY & PREPARE WALL / SLAB TO RECEIVE NEW BASE CABINETS
- 2 REMOVE / DEMOLISH EXISTING COAT HOOK UNITS & SHELF COMPLETELY & PREPARE WALL / SLAB TO RECEIVE NEW CABINETS
- 3 TEMPORARILY REMOVE EXISTING TACKBOARDS & STORE. REINSTALL @ SAME LOCATIONS AFTER INSTALLATION OF NEW BASE CABINETS & WARDROBE CABINETS / SHELVING UNITS. COORDINATE MOUNTING HEIGHTS PRIOR TO REINSTALL.
- 4 PREPARE WALLS TO RECEIVE NEW PAINT AT ENTIRE ROOM - PAINT COLOR TO BE SHERWIN-WILLIAMS - SW7008 - ALABASTER
- 5 REMOVE EXISTING SINK / FAUCET AND ASSOCIATED PIPING AS REQUIRED TO REMOVE / DEMOLISH EXISTING BASE CABINET COMPLETELY & PREPARE WALL / SLAB TO RECEIVE NEW BASE CABINETS W/ NEW SINK. PROVIDE ALL MATERIALS FOR COMPLETE INSTALLATION.
- 6 PREPARE WALLS & SHELVES TO RECEIVE NEW PAINT AT ENTIRE ROOM - PAINT COLOR TO BE SHERWIN-WILLIAMS - SW7008 - ALABASTER
- 7 REMOVE EXISTING CARPET TILES & WALL BASE AT ENTIRE ROOM. INSTALL NEW CARPET AND BASE PROVIDED BY OWNER
- 8 REPAIR EXISTING HM DOORS AND FRAMES AS REQUIRED TO PAINT EXISTING HOLLOW METAL DOORS AND FRAMES COLOR TO BE SHERWIN-WILLIAMS - SW****
- 9 REMOVE EXISTING WALL PANELS & TRIM AT WALL INDICATED. PREPARE EXISTING GYP BOARD TO REMAIN TO RECEIVE NEW PAINTER'S FINISH. COLOR TO BE SHERWIN-WILLIAMS - SW7008 - ALABASTER

GENERAL DEMOLITION NOTES:

1. ALL SALVAGEABLE ITEMS TO REMAIN THE OWNERS PROPERTY & IS TO BE DISPOSED OF / STORED AS PER OWNERS INSTRUCTIONS.
2. CARE IS TO BE TAKEN TO PROTECT ALL EXISTING ITEMS TO REMAIN. THE CONTRACTOR IS RESPONSIBLE FOR REPLACING / REPAIRING ALL EXISTING TO REMAIN ITEMS THAT ARE DAMAGED DURING CONSTRUCTION.
3. THE SUBCONTRACTORS ARE RESPONSIBLE FOR VISITING THE SITE PRIOR TO SUBMITTING A BID & OBTAINING ALL PERTINENT INFORMATION REQUIRED TO PREPARE AN ACCURATE BID. VERIFY ALL DEMOLITION & NEW WORK REQUIRED. ANY REQUIRED ADDITIONAL WORK NOT INDICATED ON THE CONTRACT DOCUMENTS MUST BE BROUGHT TO THE IMMEDIATE ATTENTION OF THE GENERAL CONTRACTOR PRIOR TO BIDDING.
4. VERIFY CLEARANCES FOR THERMOSTATS, SWITCHES, CALL BUTTONS, ETC. COORDINATE W/ ARCHITECT



313 S. E. 5th Street
MOORE, OK, 73160
ACGP@theACP.net
www.theACP.net



CG
drawn by _____
MA
checked by _____
JANUARY 2025
date _____
revisions _____



WINDING CREEK
ELEMENTARY SCHOOL
MILLWORK
REPLACEMENT

Sheet no.:
A105

OWNERSHIP USE OF DOCUMENTS:
APP EXPRESSLY RESERVES ITS
COPYRIGHT AND OTHER PROPERTY
RIGHTS OF ALL PLANS AND DRAWINGS
DESIGNED AND/OR PRODUCED. PLANS
AND DRAWINGS ARE NOT TO BE
REPRODUCED IN ANY FORM OR MANNER
WITHOUT THE EXPRESSED WRITTEN
CONSENT OF ACP.