

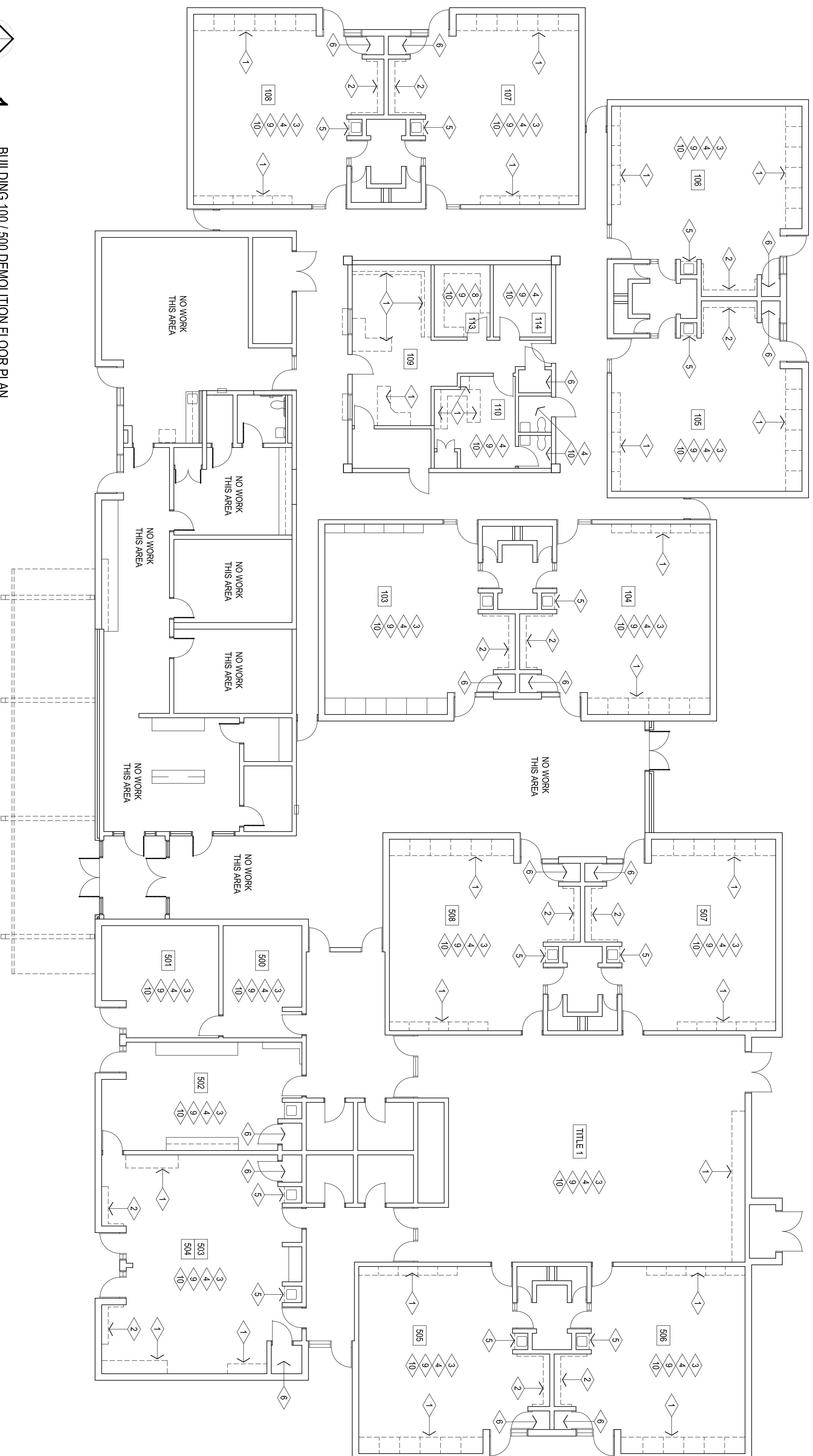

CG
drawn by _____
MA
checked by _____
JANUARY 2025
date _____
revisions _____

Sheet no.:

A101



BUILDING 100 / 500 DEMOLITION FLOOR PLAN
1/8" = 1'-0"

GENERAL DEMOLITION NOTES:

1. ALL SALVAGEABLE ITEMS TO REMAIN THE OWNERS PROPERTY & IS TO BE DISPOSED OF / STORED AS PER OWNERS INSTRUCTIONS.
2. CARE IS TO BE TAKEN TO PROTECT ALL EXISTING ITEMS TO REMAIN. THE CONTRACTOR IS RESPONSIBLE FOR REPAIRING / REPAIRING ALL EXISTING TO REMAIN ITEMS THAT ARE DAMAGED DURING CONSTRUCTION.
3. THE SUBCONTRACTORS ARE RESPONSIBLE FOR VISITING THE SITE PRIOR TO SUBMITTING A BID & OBTAINING ALL PERTINENT INFORMATION REGARD TO PREPARE AN ACCURATE BID. VERIFY ALL DEMOLITION & NEW WORK REQUIRED. ANY REQUIRED ADDITIONAL WORK NOT INDICATED ON THE CONTRACT DOCUMENTS MUST BE BROUGHT TO THE IMMEDIATE ATTENTION OF THE GENERAL CONTRACTOR PRIOR TO BIDDING.
4. VERIFY CLEARANCES FOR THERMOSTATS, SWITCHES, CALL BUTTONS, ETC. COORDINATE W/ ARCHITECT

GENERAL NOTE:

1. REMOVE / DEMOLISH EXISTING BASE / WALL CABINETS COMPLETELY & PREPARE WALL / SLAB TO RECEIVE NEW BASE CABINETS
2. REMOVE / DEMOLISH EXISTING COAT HOOK UNITS & SHELF COMPLETELY & PREPARE WALL / SLAB TO RECEIVE NEW CABINETS
3. TEMPORARILY REMOVE EXISTING TACKBOARDS & STORE. REINSTALL @ SAME LOCATIONS AFTER INSTALLATION OF NEW BASE CABINETS & WARDROBE CABINETS / SHELVING UNITS. COORDINATE MOUNTING HEIGHTS PRIOR TO REINSTALL.
4. PREPARE WALLS TO RECEIVE NEW PAINT AT ENTIRE ROOM - PAINT COLOR TO BE SHERWIN-WILLIAMS - SW7008 - ALABASTER
5. REMOVE EXISTING SINK / FAUCET AND ASSOCIATED PIPING AS REQUIRED TO REMOVE / DEMOLISH EXISTING BASE CABINET COMPLETELY & PREPARE WALL / SLAB TO RECEIVE NEW BASE CABINETS W/ NEW SINK. PROVIDE ALL MATERIALS FOR COMPLETE INSTALLATION.
6. PREPARE WALLS & SHELVES TO RECEIVE NEW PAINT AT ENTIRE ROOM - PAINT COLOR TO BE SHERWIN-WILLIAMS - SW7008 - ALABASTER
7. REMOVE / DEMOLISH EXISTING BASE CABINETS & MAILBOXES ABOVE COMPLETELY & PREPARE WALL / SLAB TO RECEIVE NEW CABINETS
8. REMOVE EXISTING SHELVES & WALL PANELS AT ENTIRE ROOM. PREPARE EXISTING GYP BOARD TO REMAIN TO RECEIVE NEW PAINTERS FINISH. COLOR TO BE SHERWIN-WILLIAMS - SW7008 - ALABASTER
9. REMOVE EXISTING CARPET TILES & WALL BASE AT ENTIRE ROOM. INSTALL NEW CARPET AND BASE PROVIDED BY OWNER
10. PAINT EXISTING HOLLOW METAL DOORS AND FRAMES COLOR TO BE SHERWIN-WILLIAMS - SW**** -