

**LEGEND**

---	EXISTING 1' CONTOUR	---	EXISTING 5' CONTOUR
---	PROPOSED 1' CONTOUR	---	PROPOSED 5' CONTOUR
---	BOUNDARY LINE	---	RIGHT OF WAY LINE
---	EASEMENT LINE	---	EXISTING CURB AND GUTTER
---	PROPOSED CURB AND GUTTER	---	PROPOSED FIRE LANE STRIPING
---	OVERHEAD ELECTRIC LINE	---	UNDERGROUND ELECTRIC LINE
---	GAS LINE	---	UNDERGROUND TELEPHONE LINE
---	UNDERGROUND FIBER OPTIC LINE	---	SANITARY SEWER LINE
---	WATERLINE	---	RETAINING WALL
---	SCREEN WALL	---	WIRE FENCE
---	CHAIN LINK FENCE	---	BENCHMARK
---	OMIT GUTTER VALLEY	---	PROP. FIRE HYDRANT
---	PROP. WHEEL STOP	---	PROP. WATER VALVE
---	PROP. FES	---	PROP. WATER METER
---	PROP. HC RAMP	---	PROP. ELECT. METER
---	PROP. POWER POLE	---	PROP. LIGHT POLE
---	PROP. SS MANHOLE	---	PROP. BOLLARD
---	PROP. GAS METER	---	PROP. TRANSFORMER
---	PROP. SIGN	---	PROP. PARKING COUNT
---	PROP. FIRE ROUTE SIGN	---	PROP. INLETS (SEE GRADING PLAN FOR TYPE)
---	VERTICAL SEPARATION REQUIREMENT	---	

\*NOTE: REFER TO SURVEYING LEGEND FOR EXISTING STRUCTURES IDENTIFICATION

**GRADING NOTES**

- A. CONTRACTOR SHALL REFER TO THE SITE SPECIFIC GEOTECHNICAL REPORT FOR EXISTING SOIL CONDITIONS, CONSIDERATIONS, AND RECOMMENDATIONS.
- B. CONTRACTOR SHALL REFER TO THE CONSTRUCTION DOCUMENTS INCLUDING BUT NOT LIMITED TO THE WRITTEN SPECIFICATIONS, CONSTRUCTION DRAWINGS, STORM WATER POLLUTION PLAN, AND GEOTECHNICAL REPORT.
- C. CONTRACTOR IS RESPONSIBLE FOR THEIR OWN HORIZONTAL AND VERTICAL CONTROL, REFERENCE POINTS AND CONSTRUCTION STAKING AS INCIDENTAL TO THE PROJECT.
- D. THE CONTRACTOR SHALL FIELD VERIFY EXISTING ELEVATIONS/PROPERTY LINES/UTILITIES/DRAINAGE PRIOR TO CONSTRUCTION START.
- E. ALL SITE EXCAVATION SHALL BE CONSIDERED UNCLASSIFIED EXCAVATION.
- F. GENERAL CONTRACTOR TO PROVIDE A UNIT PRICE FOR REMOVAL AND REPLACEMENT OF SOILS ON THIS SITE SHOULD REMOVAL BE REQUIRED.
- G. ALL WORK NOT CLASSIFIED AS A CONTRACT PAY ITEM SHALL BE CONSIDERED AS INCIDENTAL AND THE COST THEREOF SHALL BE INCLUDED IN THE UNIT PRICE BID FOR ITEMS WHICH ARE CLASSIFIED FOR PAYMENT.
- H. CONTRACTOR SHALL PROVIDE FINAL GRADES THAT DO NOT OBSTRUCT ANY UTILITY ACCESS AND PROVIDE A SMOOTH TRANSITION TO MEET AND MATCH EXISTING GRADES ON ALL SIDES.
- I. ADA ROUTES ARE NOT TO EXCEED 1:20 RUNNING SLOPE AND 2% CROSS SLOPE. HANDICAP PARKING AND ACCESS AISLES SHALL NOT EXCEED 2% IN ANY DIRECTION.
- J. ALL NATURAL GROUND SLOPES SHALL NOT EXCEED 3:1. PAVING SLOPES SHALL NOT EXCEED 8%.
- K. CONTRACTOR SHALL ENSURE THAT ALL NECESSARY EARTH DISTURBING PERMITS HAVE BEEN ACQUIRED AND MEET THE CONDITIONS/REQUIREMENTS SET FORTH IN THE PERMITS PRIOR TO CONSTRUCTION.
- L. CONTRACTOR IS REQUIRED TO CALL ONE CALL AS WELL AS THE APPROPRIATE UTILITY COMPANY AT LEAST 48 HOURS BEFORE ANY EXCAVATION/CONSTRUCTION ACTIVITIES TAKE PLACE. IT SHALL BE THE RESPONSIBILITY OF THE CONTRACTOR TO RELOCATE ALL EXISTING UTILITIES WHICH ARE IN CONFLICT WITH PROPOSED IMPROVEMENTS.
- M. THE CONTRACTOR SHALL GRADE SITE TO ENSURE ALL SURFACE WATER DRAINAGE IS AWAY FROM THE BUILDING AND PROVIDES POSITIVE DRAINAGE SO THAT NO STANDING/PONDING WATER TAKES PLACE ON SITE OR ON ADJACENT PROPERTIES.
- N. ALL CONSTRUCTION SHALL BE IN STRICT ACCORDANCE WITH THE OWNERS DESIGN GUIDELINES AND SPECIFICATIONS, AND WHERE APPLICABLE SHALL MEET THE REQUIREMENTS OF THE GOVERNING/PERMITTING AUTHORITY HAVING JURISDICTION.
- O. THE BUILDING SUBGRADE SHALL BE CONSTRUCTED TO INCLUDE A MINIMUM OF 10 FEET BEYOND THE BUILDING LIMITS AS SHOWN ON THE PLANS, OR AS DIRECTED BY THE OWNER.
- P. REFERENCE ARCHITECTURAL AND STRUCTURAL DRAWINGS FOR REQUIRED FLOOR SLAB THICKNESS.
- Q. THE BUILDING PAD SUBGRADE SHALL BE PREPARED IN STRICT ACCORDANCE WITH THE GEOTECHNICAL ENGINEERING STUDY AND THE CIVIL SPECIFICATIONS.
- R. ESTABLISH FINAL SUBGRADE ELEVATIONS TO ALLOW FOR PAVEMENT/SLAB SECTIONS AS INDICATED ON THE PLANS.
- S. IF CONFLICTS EXIST BETWEEN THE GEOTECHNICAL REPORT AND THE CONSTRUCTION DRAWINGS AND SPECIFICATIONS, THE MORE STRINGENT REQUIREMENTS SHALL APPLY.

**SPOT ELEVATION LEGEND**

TC - TOP OF CURB	FF - FINISH FLOOR
G - GUTTER	FG - FINAL GRADE
TP - TOP OF PAVEMENT	TW - TOP OF WALL
HP - HIGH POINT	BW - BOTTOM OF WALL
LP - LOW POINT	NOTE: BW IS BOTTOM OF WALL AT GRADE, NOT FOOTING
SW - SIDEWALK	
VS	VERTICAL SEPARATION REQUIREMENT

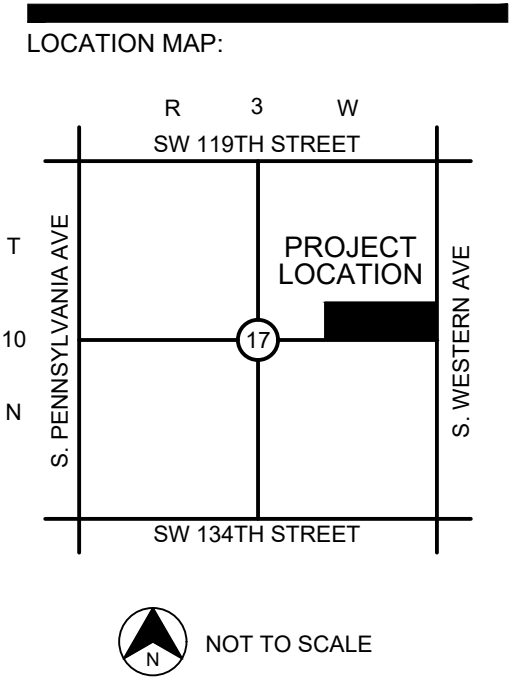

PROJECT:  
**WESTMOORE HIGH SCHOOL ENTRY ADDITION**  
 OKLAHOMA CITY, OK

PROJECT NUMBER: 25042  
 DRAWING DATE: 07.24.25  
 ISSUE DATE: 07.24.25

SEAL:

SUBMITTAL:  
**CONSTRUCTION DRAWINGS**

REVISIONS:

MARK	DATE	DESCRIPTION

THESE PLANS AND DRAWINGS ARE NOT TO BE REPRODUCED, CHANGED OR COPIED IN ANY FORM OR MANNER WHATSOEVER WITHOUT FIRST OBTAINING THE WRITTEN PERMISSION AND CONSENT OF CEDAR CREEK CONSULTING INC. THIS SHEET IS NOT TO BE USED FOR CONSTRUCTION UNLESS THE ISSUE DATE IN THE TITLE BLOCK COINCIDES WITH OR POST DATES THE DRAWING DATE. ANY CHANGES MADE FROM THESE PLANS WITHOUT CONSENT OF CEDAR CREEK CONSULTING INC. ARE UNAUTHORIZED AND SHALL RELIEVE CEDAR CREEK CONSULTING OF RESPONSIBILITY FOR ALL CONSEQUENCES ARISING OUT OF SUCH CHANGES.

DRAWING TITLE:

**GRADING PLAN**

SHEET:  
**C1.00**

