



CG

drawn by

MA

checked by

AUGUST 2025

date

revisions



WESTMOORE HIGH
SCHOOL ENTRY
UPGRADES

sheet no:

AD101

DEMOLITION PLAN

OWNERSHIP USE OF DOCUMENTS:

AGP EXPRESSLY RESERVES ITS
COPYRIGHT AND OTHER PROPERTY
RIGHTS OF ALL PLANS AND DRAWINGS
DESIGNED AND/OR PRODUCED. PLANS
AND DRAWINGS ARE NOT TO BE
REPRODUCED IN ANY FORM OR MANNER
WITHOUT THE EXPRESSED WRITTEN
CONSENT OF AGP.

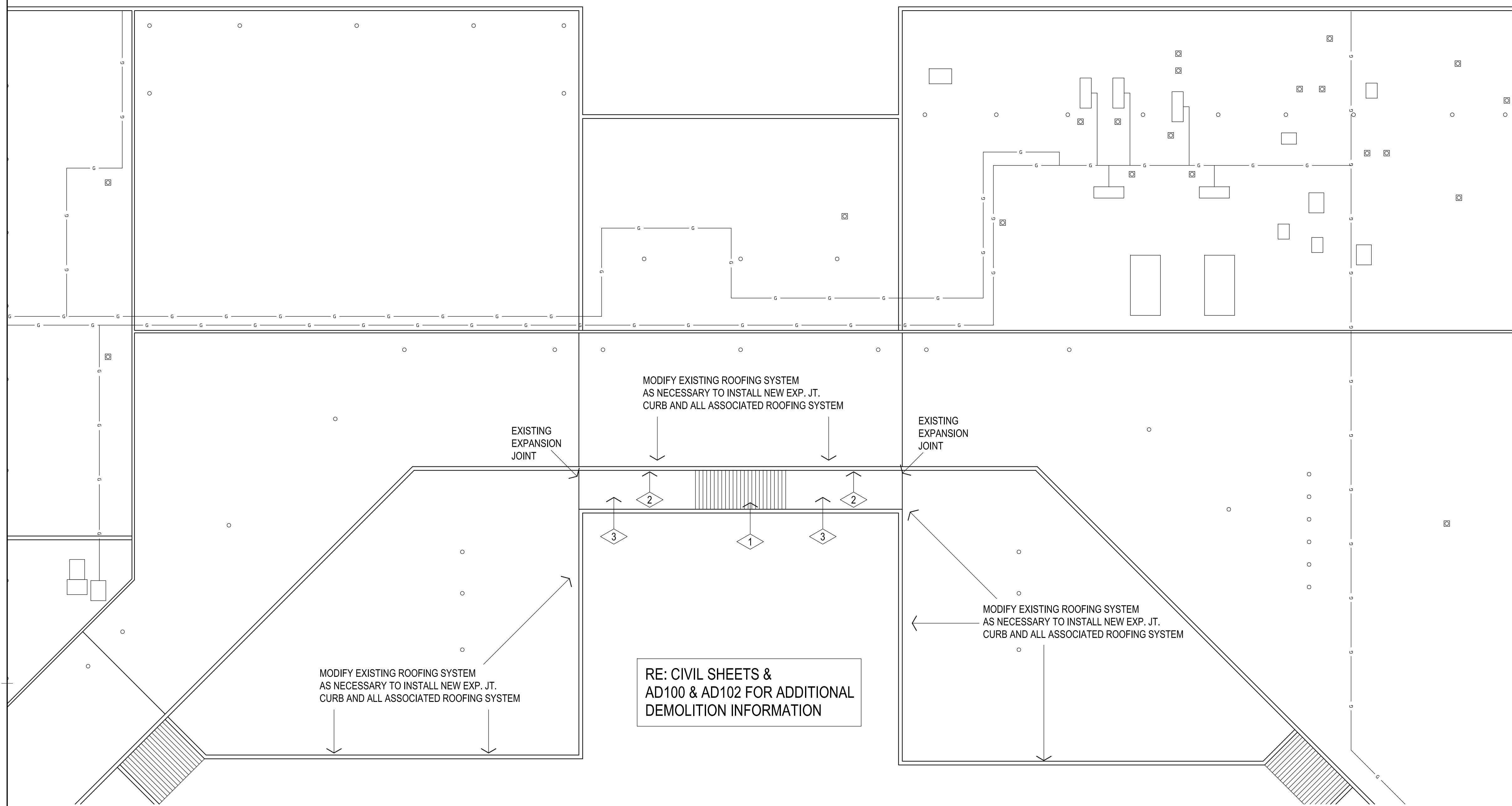

RE: CIVIL SHEETS &
AD100 & AD102 FOR ADDITIONAL
DEMOLITION INFORMATION

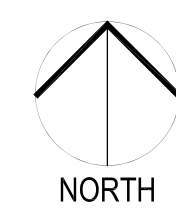

1

DEMOLITION ROOF PLAN

1/16" = 1'-0"

GENERAL NOTES:

- FILL, GRADE, & PREPARE ALL EXCAVATED AREAS TO RECEIVE NEW SITE FEATURES.
- CONTRACTOR TO VISIT SITE PRIOR TO PREPARING BID, & VERIFY ALL ITEMS TO BE DEMOLISHED. ANY ADDITIONAL ITEMS REQUIRING DEMOLITION THAT ARE NOT INCLUDED IN THESE DOCUMENTS SHOULD BE BROUGHT TO THE IMMEDIATE ATTENTION OF THE ARCHITECT AND INCLUDED IN THE BASE BID.
- EXISTING UNDERGROUND UTILITY LOCATIONS & CONTOUR INFORMATION HAVE BEEN OBTAINED FROM THE BEST AVAILABLE SOURCES. THE CONTRACTOR SHALL FIELD VERIFY ALL EXISTING CONDITIONS PRIOR TO COMMENCING WORK & COORDINATE W/ ARCHITECT.
- CONTRACTOR IS TO FIELD VERIFY ALL EXISTING ELEVATIONS PRIOR TO STARTING EARTHWORK - AND ADJUST ACCORDINGLY AS DIRECTED BY THE ARCHITECT.
- DURING ALL EXISTING UTILITY REVISIONS - TEMPORARY SERVICE IS TO BE PROVIDED @ ALL EFFECTED BUILDINGS.
- ALL SALVAGEABLE ITEMS TO REMAIN OWNER'S PROPERTY & SHALL BE STORED OR DISPOSED OF AS PER OWNER'S INSTRUCTIONS.
- CONSTRUCTION SHALL MEET ALL APPLICABLE CODES, ORDINANCES, REGULATIONS & STANDARDS REQUIRED BY THE CITY OF OKLAHOMA CITY, OKLAHOMA.
- CONSTRUCTION SHALL MEET ALL APPLICABLE REQUIREMENTS OF THE AMERICANS W/ DISABILITIES ACT INCLUDING ANY SUPPLEMENTAL REQUIREMENTS BY THE CITY OF OKLAHOMA CITY, OKLAHOMA.
- CONTRACTOR SHALL COORDINATE ACCESS TO SITE W/ OWNER PRIOR TO STARTING WORK. OBTAIN APPROVAL FROM OWNER FOR ON-SITE MATERIAL STORAGE, ETC. CONTRACTOR SHALL PROVIDE PROPER SEPARATION BTWN. WORK & STUDENTS.
- ALL EXISTING ITEMS TO REMAIN ARE TO BE PROTECTED DURING CONSTRUCTION. ANY ITEMS, CONCRETE SIDEWALKS, ASPHALT PAVING, CONC. CURB & GUTTER, ETC. SHALL BE REPAIRED / REPLACED TO MATCH EXISTING.
- ADJUST ALL CLEANOUTS AS REQUIRED FOR NEW CONSTRUCTION. PROVIDE ALL MATERIALS REQUIRED FOR A COMPLETE INSTALLATION.

DEMOLITION NOTES:

- DEMOLISH EXISTING METAL ROOF SYSTEM AND ASSOCIATED FRAMING AS REQUIRED FOR NEW CONSTRUCTION
- MODIFY EXISTING WALL PANEL SYSTEM AS REQUIRED FOR NEW STRUCTURE AND ROOFING SYSTEM. PROVIDE WATER TIGHT INSTALLATION.
- DEMOLISH EXISTING ROOFING SYSTEM AS REQUIRED FOR NEW CONSTRUCTION.