

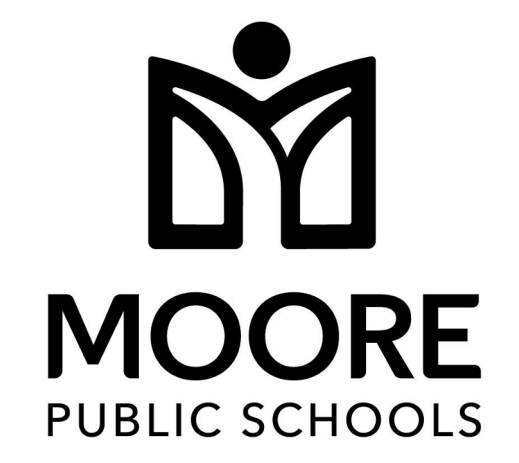

KF
drawn by
DG
checked by
MARCH 2026
date

REVISIONS

Δ	DESCRIPTION	DATE



SOUTHMOORE HIGH
SCHOOL HVAC
REPLACEMENT

sheet no:

M101

OWNERSHIP USE OF DOCUMENTS:
AGP EXPRESSLY RESERVES ITS
COPYRIGHT AND OTHER PROPERTY
RIGHTS OF ALL PLANS AND DRAWINGS
DESIGNED AND/OR PRODUCED. PLANS
AND DRAWINGS ARE NOT TO BE
REPRODUCED IN ANY FORM OR MANNER
WITHOUT THE EXPRESSED WRITTEN
CONSENT OF AGP.

GENERAL NOTES

- COORDINATE WORK WITH ALL TRADES ON SITE.
- COORDINATE CARBON DIOXIDE SENSOR LOCATION WITH EARTHSMART PRIOR TO INSTALLATION.

KEYED NOTES

- CARBON MONOXIDE DETECTOR TO BE INSTALLED ACCORDING TO ALL APPLICABLE CODES. DETECTOR SHALL BE INSTALLED CENTRALLY ON CEILING. ALSO INCLUDE BATTERY BACKUP IN EVENT PRIMARY POWER IS INTERRUPTED. ALARM SIGNAL SHALL BE ROUTED TO ADMINISTRATION OFFICE. COORDINATE WITH E.C. WITH PRIMARY POWER CONNECTION AND SYSTEM CONNECT.

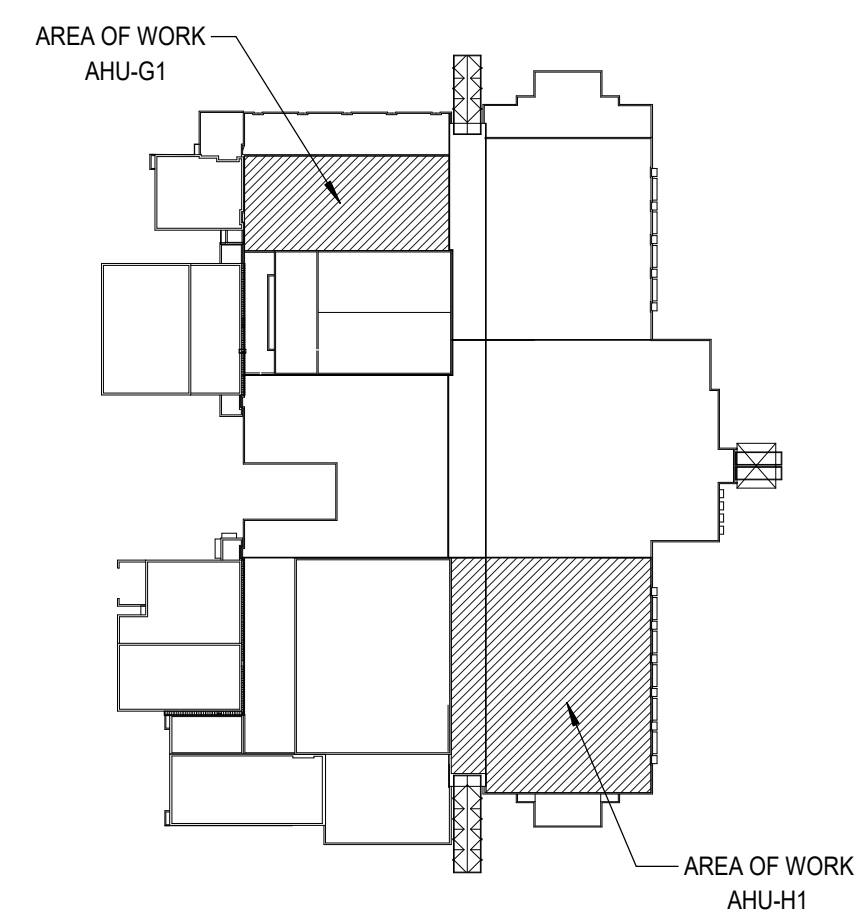

KEY PLAN
Scale: 1" = 160'-0"

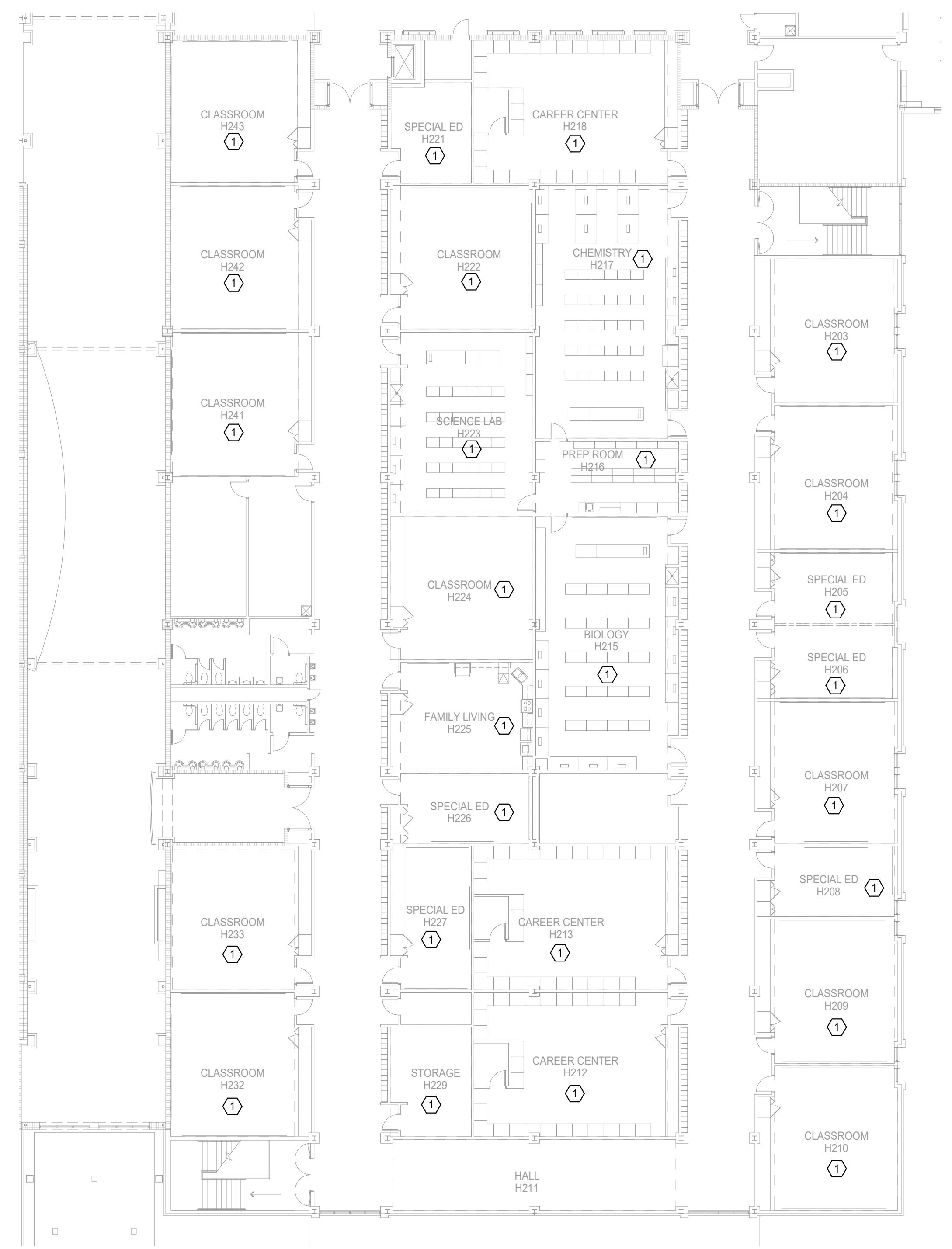

2 MECHANICAL FLOOR PLAN - LEVEL 2 AREA H
Scale: 1/16" = 1'-0"

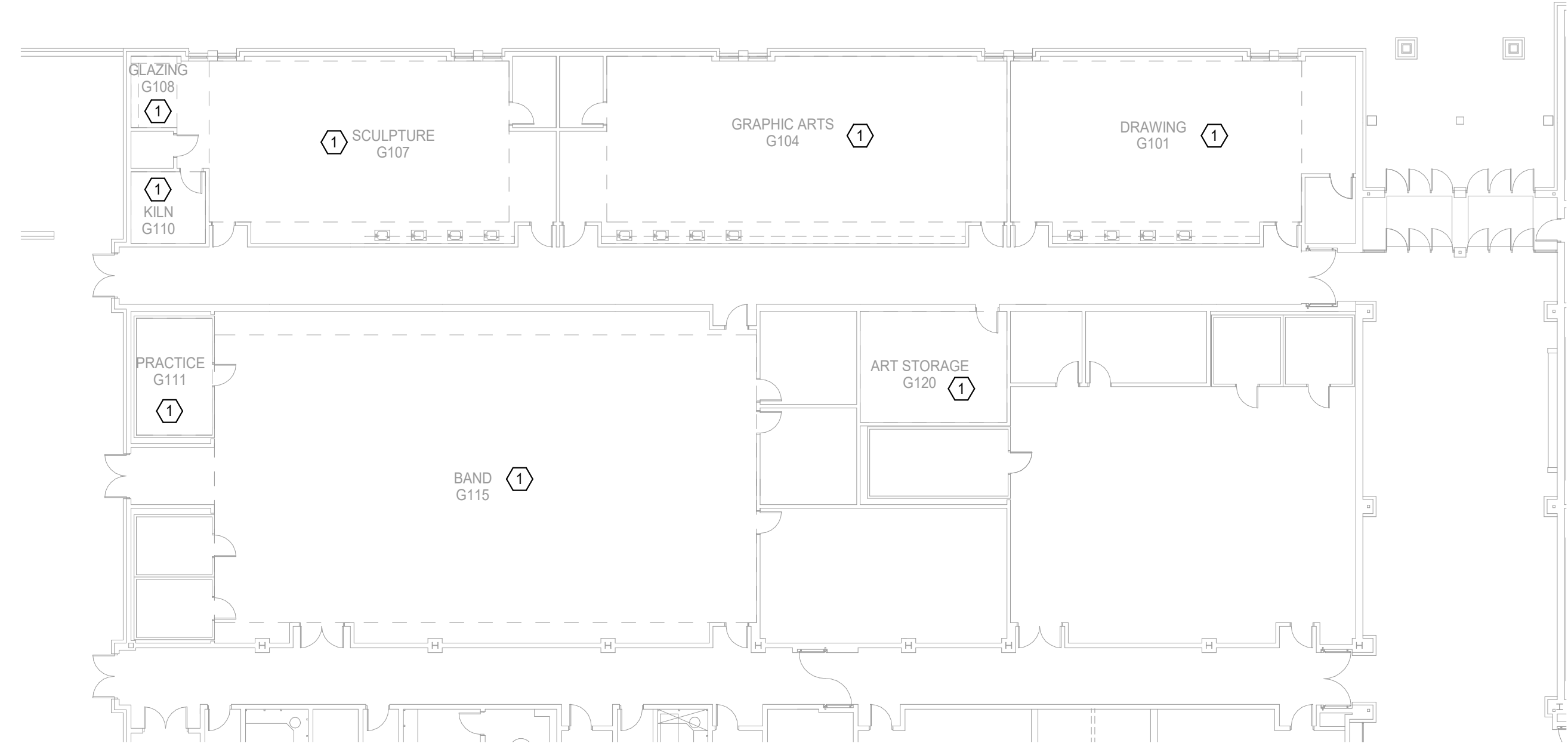

1 MECHANICAL FLOOR PLAN - LEVEL 1 AREA G
Scale: 1/16" = 1'-0"

Salas O'Brien
Salas O'Brien, Inc. - Oklahoma City
2900 S. Telephone Road, Suite 120
Moore, OK 73160
CA#: 9820 Expiration Date: 06/30/2027
Salas O'Brien Project Number: 2550-02191-00