

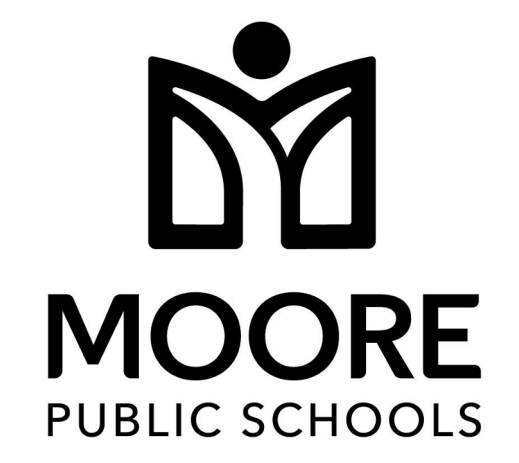

DWG
drawn by
TVO
checked by
MARCH 2026
date

REVISIONS

Δ	DESCRIPTION	DATE



SOUTHMOORE HIGH
SCHOOL HVAC
REPLACEMENT

sheet no:
E201

OWNERSHIP USE OF DOCUMENTS:
AGP EXPRESSLY RESERVES ITS
COPYRIGHT AND OTHER PROPERTY
RIGHTS OF ALL PLANS AND DRAWINGS
DESIGNED AND/OR PRODUCED. PLANS
AND DRAWINGS ARE NOT TO BE
REPRODUCED IN ANY FORM OR MANNER
WITHOUT THE EXPRESSED WRITTEN
CONSENT OF AGP.

- GENERAL NOTES**
- COORDINATE EXACT LOCATIONS OF DEVICES SHOWN WITH OTHER EQUIPMENT.
 - COORDINATE EXACT LOCATION OF MECHANICAL EQUIPMENT WITH MECHANICAL CONTRACTOR. REFER TO MECHANICAL PLANS AND MANUFACTURER FOR ADDITIONAL INFORMATION.
 - COORDINATE THE EXACT REQUIREMENTS OF ALL POWER CONNECTION FIXTURES AND DEVICES WITH THE ARCHITECT, OWNER AND MANUFACTURER PRIOR TO ROUGH-IN.
 - EXISTING CONDUIT AND WIRING MAY BE REUSED IF IN SERVICEABLE CONDITION, OTHERWISE PROVIDE NEW CONDUIT AND WIRE AS REQUIRED. NEW DEVICES AND FIXTURES SHALL BE CIRCUITED TO NEW PANELS AS INDICATED. EC SHALL FIELD VERIFY EXISTING CONDITIONS AND REPORT ANY ANOMALIES TO THE ARCHITECT AND ENGINEER PRIOR TO PROCEEDING.

- KEYED NOTES**
- CIRCUIT NEW AIR HANDLER 'AHU-G1' TO EXISTING SWITCHBOARD 'HJ 1'. PROVIDE NEW BREAKER, CONDUIT, AND WIRE AS REQUIRED TO FEED THE NEW UNIT. EXISTING CONDUIT AND WIRING RETAINED FROM DEMO MAY BE REUSED WHERE IN SERVICEABLE CONDITION AND SIZED APPROPRIATELY FOR NEW UNIT CONNECTION. REFER TO ONE-LINE DIAGRAM FOR ADDITIONAL INFORMATION.
 - CIRCUIT NEW AIR HANDLER 'AHU-H1' TO EXISTING SWITCHBOARD 'HH 1'. PROVIDE NEW BREAKER, CONDUIT, AND WIRE AS REQUIRED TO FEED THE NEW UNIT. EXISTING CONDUIT AND WIRING RETAINED FROM DEMO MAY BE REUSED WHERE IN SERVICEABLE CONDITION AND SIZED APPROPRIATELY FOR NEW UNIT CONNECTION. REFER TO ONE-LINE DIAGRAM FOR ADDITIONAL INFORMATION.

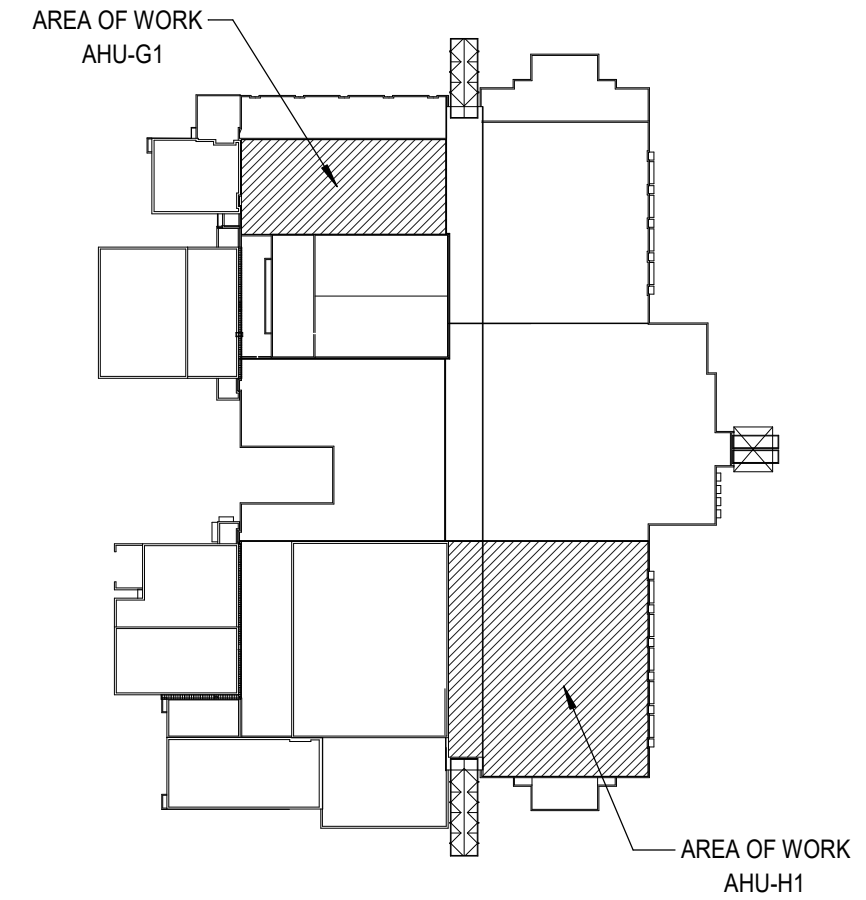

KEY PLAN
Scale: 1" = 160'-0"

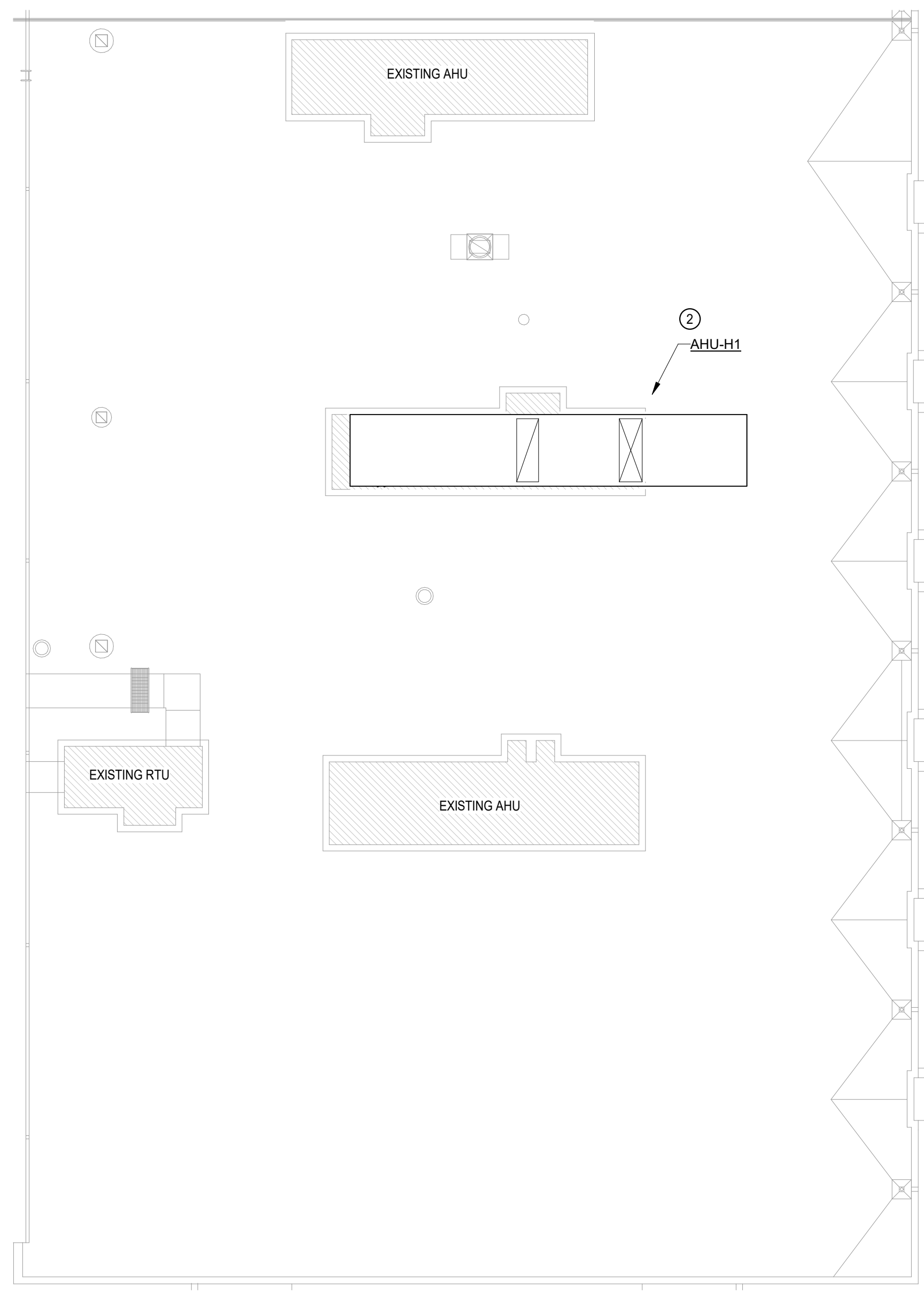

2 ELECTRICAL ROOF PLAN - AHU-H1
Scale: 1/16" = 1'-0"

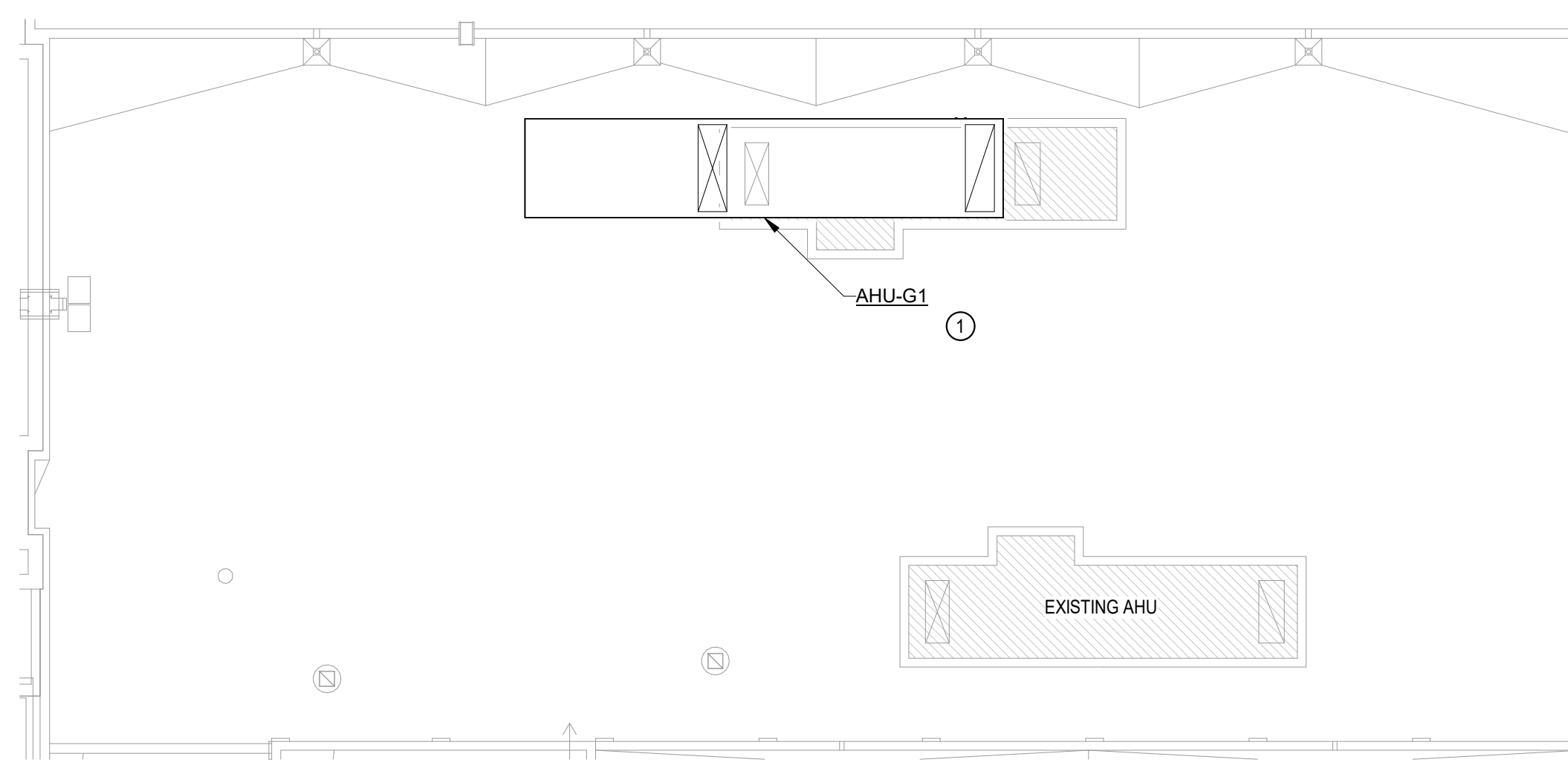

1 ELECTRICAL ROOF PLAN - AHU-G1
Scale: 1/16" = 1'-0"

Salas O'Brien
Salas O'Brien, Inc. - Oklahoma City
2900 S. Telephone Road, Suite 120
Moore, OK 73160
CA#: 9820 Expiration Date: 06/30/2027
Salas O'Brien Project Number: 2550-02191-00