

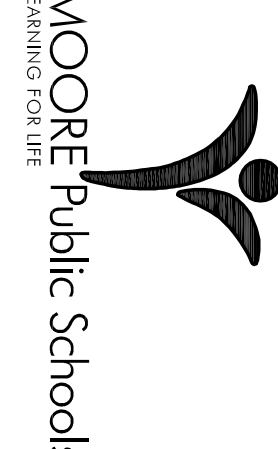

4/25/22

CG
designed by
MA
checked by
APRIL 2022
dab
revisions

MOORE PUBLIC SCHOOLS
BOARD OF EDUCATION
MOORE, OKLAHOMA



NEW 2022 CLASSROOM
ADDITION -
SOUTH LAKE
ELEMENTARY SCHOOL

Sheet No.
L101

OWNERSHIP USE OF DOCUMENTS:
AGP EXPRESSLY RESERVES ITS
COPYRIGHT AND OTHER PROPERTY
RIGHTS OF ALL PLANS AND DRAWINGS
DESIGNED AND/OR PRODUCED BY AGP.
REPRODUCTION IN ANY FORM OR MANNER
WITHOUT THE EXPRESSED WRITTEN
CONSENT OF AGP.

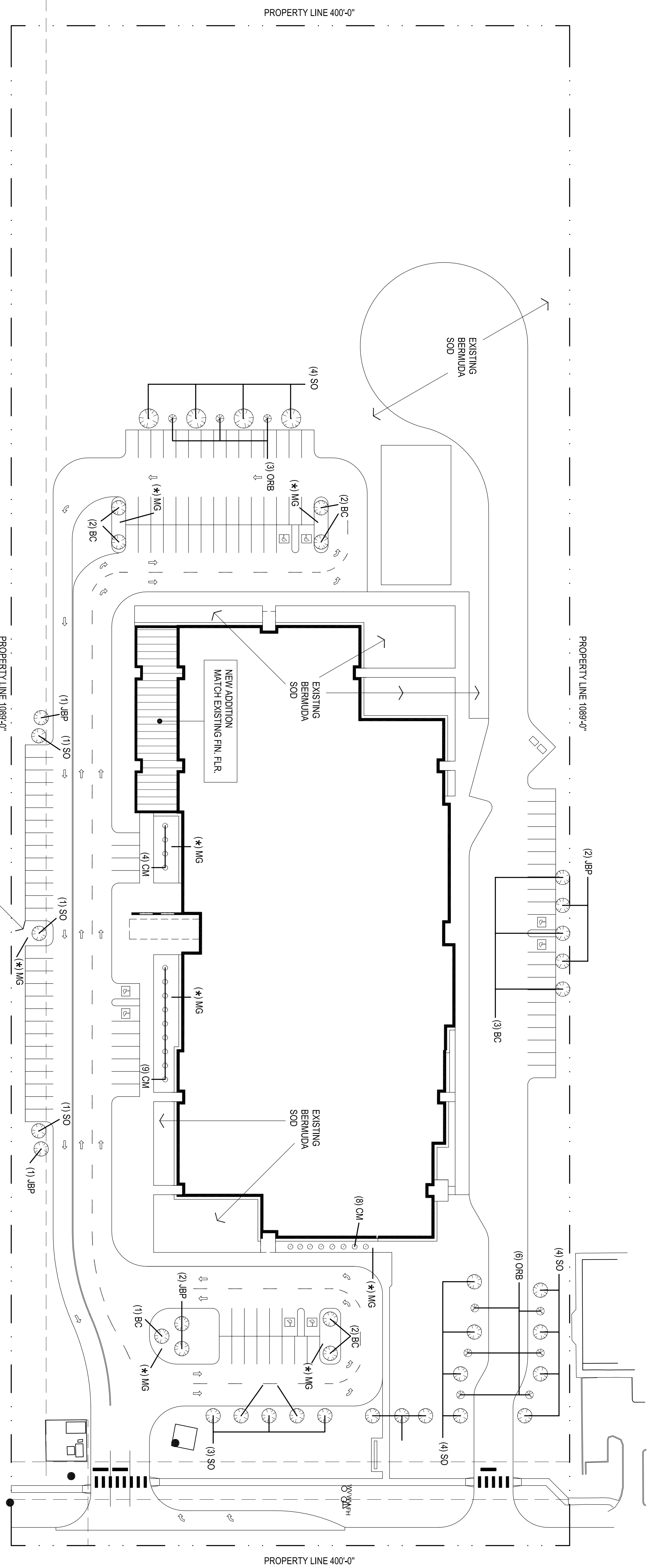

EXISTING PLANT SCHEDULE

SYM.	QTY.	BOTANICAL NAME	COMMON NAME	SIZE	COND.	SPCG.	ROOT BALL SIZE	TREE PT SIZE	NOTES
TREES									
BC	11	TAXODIUM DISTICHUM	BALD CYPRESS	3" CAL.	BB/C	AS	24"-26"	32" - 38"	UNIFORM BRANCHING HABITS.
CM	26	LAGERSTROEMIA INDICA	CREAPE MYRTLE	8" HT., MT.	BB/C	AS	24"-26"	32" - 38"	3 TRUNK MINIMUM - 1.5" TO 2" CAL.
ORB	17	CERCIS CANADENSIS OKLAHOMA	OKLAHOMA REDBUD	2" CAL.	BB/C	AS	24"-26"	32" - 38"	UNIFORM BRANCHING HABITS.
SO	27	QUERCUS SHUMARDII	SHUMARD OAK	3" CAL.	BB/C	AS	24"-26"	32" - 38"	UNIFORM BRANCHING HABITS.
JBP	12	PINUS THUNBERGII	JAPANESE BLACK PINE	2" CAL.	BB/C	AS	24"-26"	32" - 38"	UNIFORM BRANCHING HABITS.
GROUND COVERS									
MG	-	LIRIOPE VARIEGATA	MONKEY GRASS	12" HT	C	18" O.C.	N/A	N/A	FULL CONT. DEVELOPED ROOTS.

AS = AS SHOWN, BB = BALLED AND BURLAPPED, C = CONTAINER, CAL. = CALIPER, GAL. = GALLON, HT = HEIGHT, MT = MULTI-TRUNK, N/A = NOT APPLICABLE, O.C. = ON CENTER, S.F. = SQUARE FEET

EXISTING LANDSCAPE MATERIAL SCHEDULE

EXISTING LANDSCAPING NOTES:

288,000 S.F. DEVELOPED AREA
SITE SIZE: 288,800 / 200 = 1,440 POINTS
EXISTING PARKING LOT: 121 SPACES = 242 POINTS
POINTS REQ'D. 1440 + 186 = 1686 POINTS

EXISTING LANDSCAPING
36 - 3" TREES = 940 PTS
21 - 2" TREES = 522 POINTS
23 - ORNAMENTAL TREES = 207 POINTS
1000 - ORNAMENTAL GRASSES = 500

6896 SY - TURF GRASS = 882 PTS
MAX 25% ALLOWED = 431 PTS
TOTAL EXISTING POINTS PROVIDED = 1930 PTS
(572 EVERGREEN POINTS)