

□

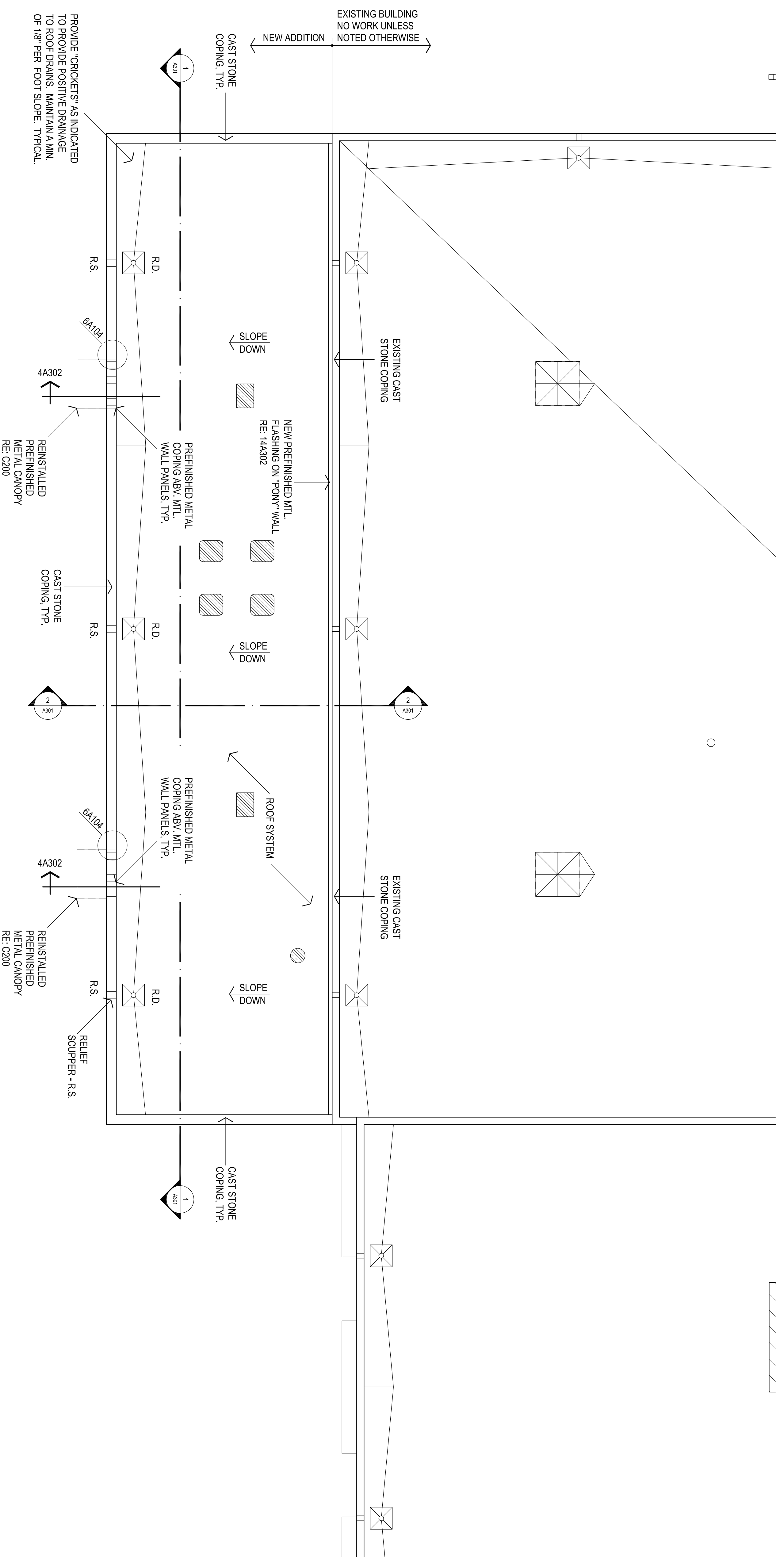

1
ROOF PLAN
1/8" = 1'-0"

NOTES:

1. RE: MECH & ELEC. FOR ADDITIONAL ROOF MOUNTED ITEMS, CONTRACTOR TO COORDINATE ALL ROOF MOUNTED ITEMS & PENETRATIONS W/ APPLICABLE TRADES. PROVIDE "CRICKETS" AT HIGH SIDE OF ALL CURBS.
2. PROVIDE RELIEF SCUPPER (R.S.) AT ALL ROOF DRAIN (RD) LOCATIONS. TYP. - RE: 2, 3 & 5A105
3. _____ ROOF MOUNTED GAS LINE- REFER 4A105 FOR SUPPORT PAINT ALL GAS LINES "SAFETY" YELLOW COORDINATE W/ ARCHITECT
4. _____ INDICATES WALKWAY PAD LOCATIONS - CUT PADS INTO 5'-0" MAX LENGTHS & PLACE 2" APART TO COVER AREAS INDICATED.
5. CONTRACTOR TO COORDINATE ROOF VENT PENETRATIONS W/ ARCHITECT.

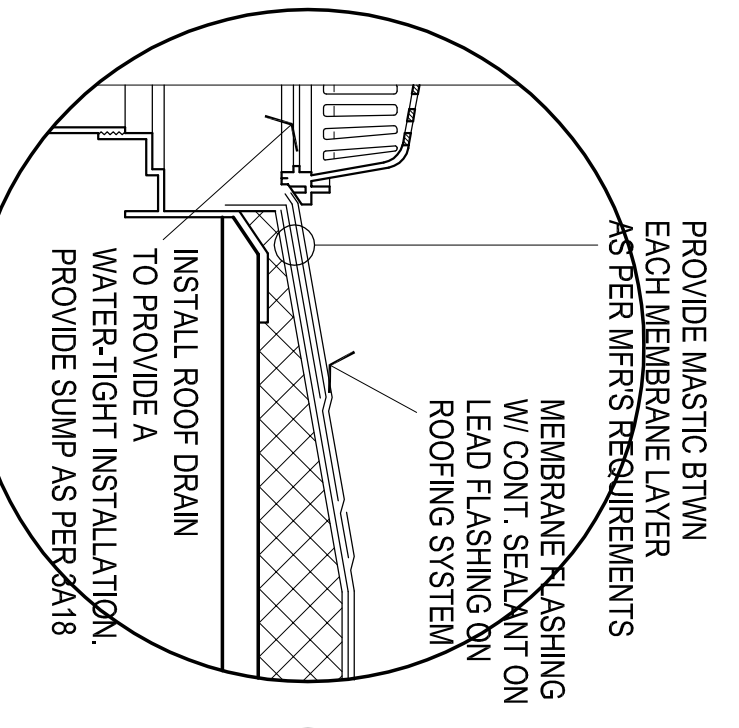

2
ROOF DRAIN
NO SCALE

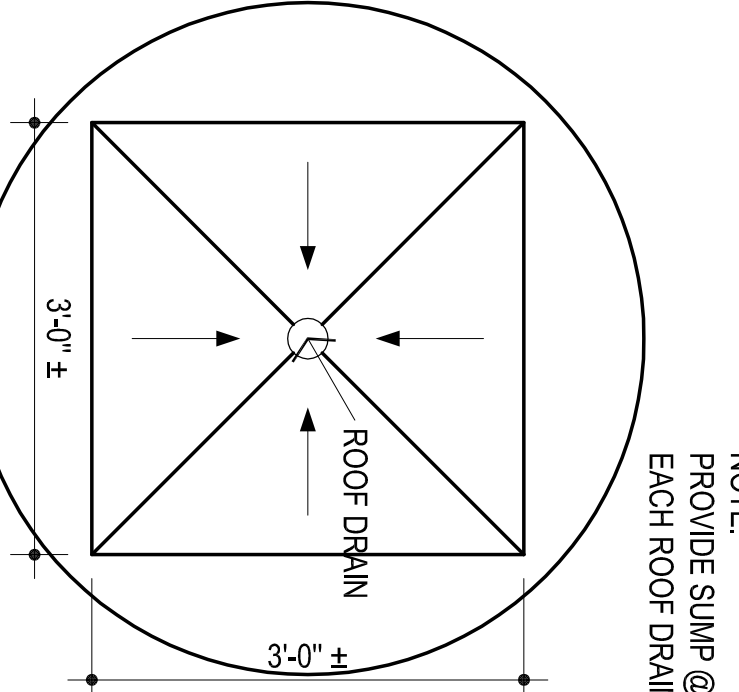

3
ROOF DRAIN SUMP
NO SCALE

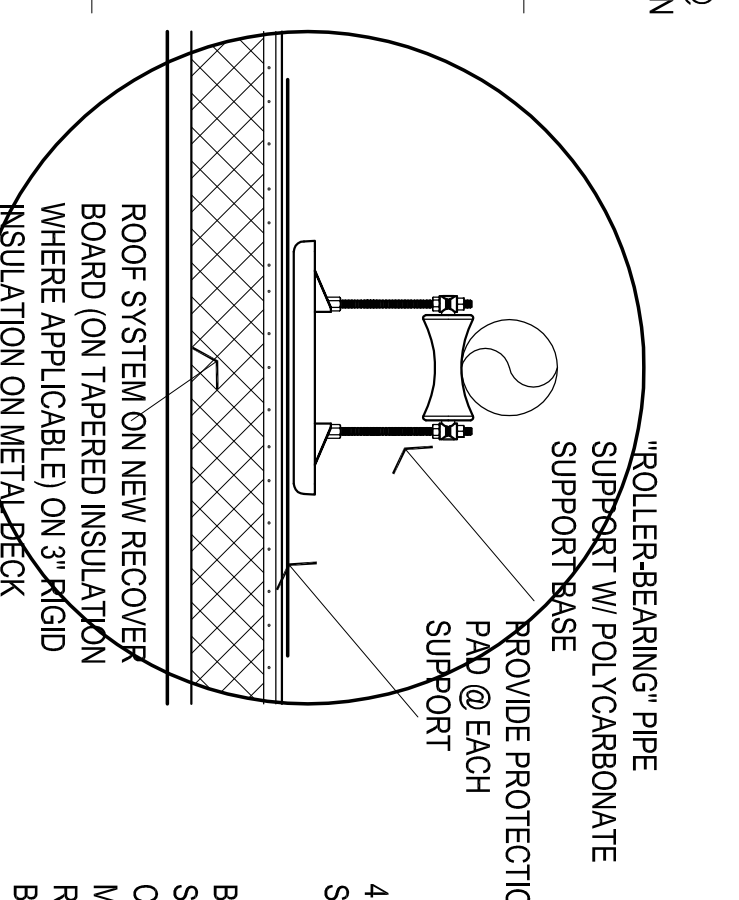

4
ADJUSTABLE PIPE SUPPORTS - FRONT VIEW
NO SCALE

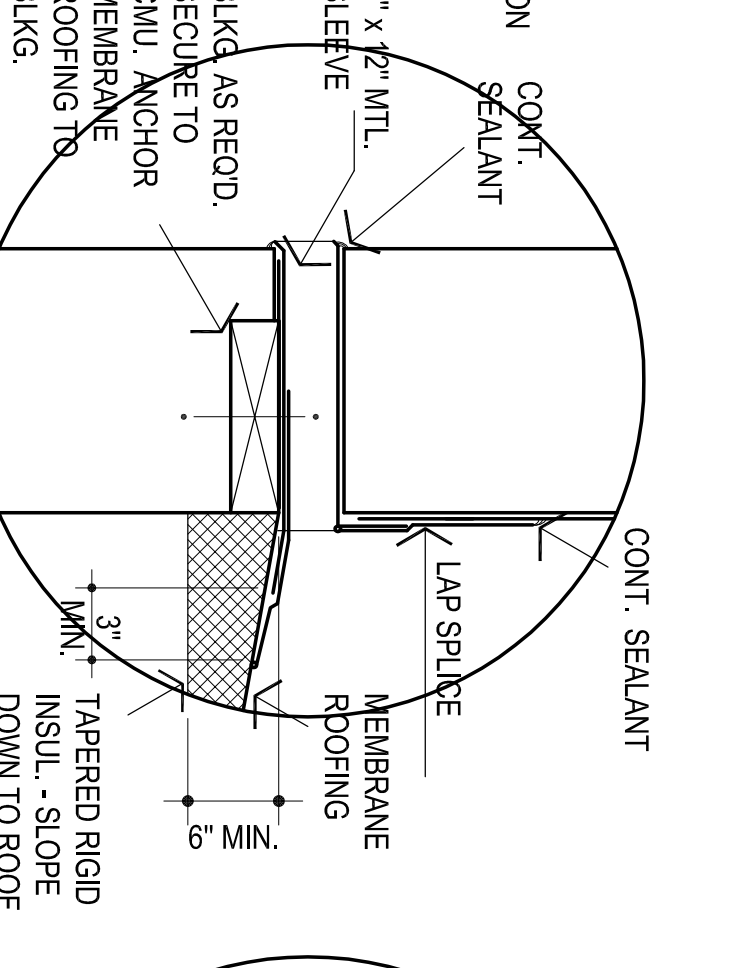

5
RELIEF SCUPPER
NOT TO SCALE

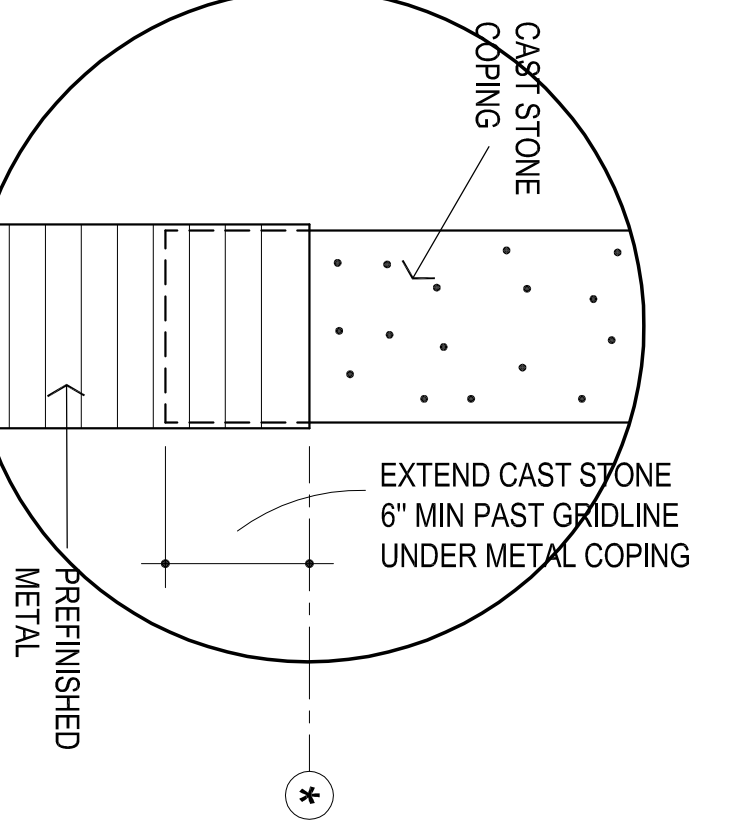

6
NO SCALE

AGP
the Abila Griffin
Partnership L.L.C.
201 N. BROADWAY
SUITE 210
MOORE, OK. 73160
405.735.3477
AGP@theAGP.net
www.theAGP.net

KFC ENGINEERING
STRUCTURAL
SALAS O'BRIEN
MECHANICAL ELECTRICAL

STATE OF OKLAHOMA
MICHAEL L. ABILA
2839
REGISTERED PROFESSIONAL ARCHITECT
4/25/22

CG
designed by
MA
checked by
APRIL 2022
0488
revisions
ADDENDUM #1

MOORE PUBLIC SCHOOLS
BOARD OF EDUCATION
MOORE, OKLAHOMA

MOORE Public Schools
LEARNING FOR LIFE

NEW 2022 CLASSROOM
ADDITION -
SOUTH LAKE
ELEMENTARY SCHOOL

Sheet No:
A104

OWNERSHIP USE OF DOCUMENTS:
AGP EXPRESSLY RESERVES ITS
COPYRIGHT AND OTHER PROPERTY
RIGHTS OF ALL PLANS AND DRAWINGS
DESIGNED AND/OR PRODUCED BY
AGP. ANY REPRODUCTION OF ANY
REPRODUCED IN ANY FORM OR MANNER
WITHOUT THE EXPRESSED WRITTEN
CONSENT OF AGP.