

ABBREVIATIONS

ABOVE	AT
ADJUSTABLE	ACU.
ANCHOR	ANCH.
APPROXIMATE	APPROX.
BOARD	BD.
BLOCKING	BLK.G.
BOTTOM	BL.
BOTTOM CENTERLINE	BLT.
CEILING	C.
CONCRETE MASONRY UNIT	CMU
CONTINUOUS	CONT.
DRINKING FOUNTAIN	D.F.
DIMENSION	DM.
DOOR	DR.
DRAWING	DWG.
DOWEL	DWL.
EACH	EACH
ELECTRICAL	ELECT.
ELEVATION	ELEV.
EQUAL	EQ.
EXPANSION JOINT	EXP.
EACH WAY	E.W.
EXISTING	EXIST.
EXPANSION	EXP.
FLOOR DRAIN	FD.
FIRE EXTINGUISHER CABINET	FE.
FIRE EXTINGUISHER	F.F.
FINISH FLOOR LINE	FFL.
FINISH	FIN.
FRAMING	FRM.G.
GAUGE	GA.
GALVANIZED	GA.LV.
GYPSUM BOARD	GYP.BD.
HANDICAP	H.C.
HARDWOOD	HARDW.
HARDWARE	HARDW.
HORIZONTAL	HORIZ.
HEIGHT	HT.
INSULATION	INSUL.
JOIST	JST.
JOINT	JT.
LAVATORY	LAV.
MATERIAL	MATL.
MAXIMUM	MAX.
MECHANICAL	MECH.
MANUFACTURING	MFG.
MANUFACTURER	MFR.
MINIMUM	MIN.
MISCELLANEOUS	MISC.
METAL	MTL.
NOT IN CONTRACT	N.I.C.
NUMBER	NO./#
NOT TO SCALE	N.T.S.
ON CENTER	O.C.
OPENING	OPN.G.
OPPOSITE	OPP.
POWER POLE	P.P.
PREFINISHED	PREFIN.
PAPER TOWEL	P.T.
PLYWOOD	P.W./PLY WD.
REFER	RECD.
REQUIRED	REQD.
ROOM	RM.
SPLASH BLOCK	SB.
SCHEDULE	SCHED.
STANDARD	STD.
STEEL	STL.
STAY JOINT	S.J.
TOP OF CURB	T.O.C.
TYPICAL	TYP.
TOILET PAPER HOLDER	T.P.H.
UNLESS NOTED OTHERWISE	U.N.O.
VENT THROUGH ROOF	VTR.
WATERCLOSET	W.C.
WOOD	W.D.
WELDED WIRE FABRIC	WWF.

MATERIALS LEGEND

	MASONRY VENEER
	C.M.U.
	CONCRETE
	FRAME PARTITION, METAL STUDS
	GYPSUM BOARD
	PARTICLE BOARD
	RIGID INSULATION
	WOOD BLOCKING / FRAMING, CONTINUOUS
	WOOD BLOCKING, DISCONTINUOUS
	FINISH WOOD
	SMALL SCALE STRUCTURAL STEEL / MISCELLANEOUS METAL
	LARGE SCALE STRUCTURAL STEEL
	BATT INSULATION
	ACOUSTICAL CEILING TILE
	EARTH FILL

SYMBOLS LEGEND

	EXISTING SPOT ELEVATION
	FINISH SPOT ELEVATION
	EXISTING GRADE CONTOUR
	FINISH GRADE CONTOUR
	EXISTING TREE TO BE PROTECTED
	EXISTING TREE TO BE REMOVED
	PROJECT LIMITS
	CHANLINK FENCE
	BARBED WIRE FENCE
	CONCRETE PAVING
	ASPHALT PAVING
	CONCRETE SIDEWALK
	EXISTING PAVING/SIDEWALK TO REMAIN
	EXISTING PAVING TO BE REMOVED
	NEW BUILDING
	EXISTING BUILDING - NO WORK
	ROOM NUMBER
	ROOM NUMBER, LARGE
	SCALE PLAN REFERENCE
	ROOM NUMBER/INTERIOR ELEVATION REFERENCE
	WALL SECTION/DETAIL CUT MARK
	LARGE SCALE DETAIL MARK
	STRUCTURAL GRID COORDINATES
	BUILDING SECTION CUT MARK
	DOOR NUMBER
	WINDOW MARK
	FRAME MARK
	GLAZING MATERIAL MARK
	EQUIPMENT MARK
	EXTERIOR ELEVATION MARK
	TEST HOLE
	BENCH MARK/BUILDING ELEVATION (SECTION)

GENERAL NOTES:

- ALL REQUIRED HANDICAP ACCESSIBLE ITEMS TO COMPLY WITH AMERICANS WITH DISABILITIES ACT AND ARCHITECTURAL BARRIERS ACT ACCESSIBILITY GUIDELINES.
- THE CONTRACTOR SHALL USE ANY LEAD-BASED PAINT OR ASBESTOS CONTAINING MATERIAL ON THIS PROJECT.
- THESE CONTRACT DOCUMENTS INCLUDING BUT NOT LIMITED TO THE DRAWINGS, PROJECT MANUAL AND ANY SUBSEQUENT ADDENDA ARE ISSUED AS A "WHOLE" AND SHALL BE BID AS SUCH. EACH DISCIPLINE / SUBCONTRACTOR SHALL REVIEW THE ENTIRE SET OF CONTRACT DOCUMENTS AND INCLUDE APPLICABLE WORK IN THEIR BID REGARDLESS OF LOCATION WITHIN THE CONTRACT DOCUMENTS. REVIEWING ONLY A PORTION OF THE CONTRACT DOCUMENTS SHALL NOT SOLVE THE CONTRACTOR OR SUBCONTRACTOR OF THE REQUIREMENT TO PERFORM THE WORK OF THEIR RESPECTIVE DISCIPLINES.
- LOCATIONS OF EXISTING BUILDINGS, SITE FEATURES, & UNDERGROUND UTILITIES HAVE BEEN OBTAINED FROM EXISTING AVAILABLE SOURCES. THE CONTRACTOR IS TO FIELD VERIFY EXISTING LOCATIONS PRIOR TO STARTING CONSTRUCTION AND NOTIFY THE ARCHITECT IMMEDIATELY IF ANY EXISTING BUILDING OR SITE FEATURE CONFLICTS WITH THE NEW CONSTRUCTION.
- THE CONTRACTOR SHALL VERIFY ALL EXISTING SITE UTILITIES AND PROTECT DURING CONSTRUCTION. COORDINATE NEW UTILITY REQUIREMENTS WITH APPLICABLE UTILITY COMPANIES (WATER, GAS, ELECTRICITY, SANITARY, SEWER, TELEPHONE, CABLE, SITE DRAINAGE AND OTHERS AS REQUIRED). COMPLY WITH ALL APPLICABLE REGULATIONS. INCLUDE ALL CONNECTION FEES AND OTHER CHARGES IN BID.
- REFER TO MECHANICAL AND ELECTRICAL DRAWINGS FOR UTILITY INFORMATION.
- REFER TO MECHANICAL AND ELECTRICAL DRAWINGS FOR ADDITIONAL REQUIREMENTS AND CONCRETE TO BE PROVIDED BY CONTRACTOR.
- GENERAL CONTRACTOR TO VERIFY LOCATIONS OF EXISTENTS, ENCUMBRANCES AND SET BACKS PRIOR TO STARTING CONSTRUCTION.
- CONFLICTS BETWEEN DRAWINGS AND SPECIFICATIONS SHALL BE BROUGHT TO ARCHITECTS ATTENTION. FAILURE TO BID ITEMS NOTED ON DRAWINGS AND OMITTED FROM SPECIFICATIONS DOES NOT REMOVE RESPONSIBILITY TO PROVIDE AND INSTALL SUCH CHANGES IN BID.

GENERAL NOTES (CONT):

- CONSTRUCTION STAGING AREA & VEHICLE ACCESS SHALL BE CONFIRMED WITH OWNER, AND CONSTRUCTION MANAGER IF APPLICABLE. PRIOR TO CONSTRUCTION.
- FINISH GRADE AT BUILDING PERIMETERS SHALL BE 6" BELOW FINISH FLOOR UNLESS SPECIFICALLY NOTED OTHERWISE ON CIVIL DRAWINGS. DEVELOP POSITIVE DRAINAGE AWAY FROM NEW AND/OR EXISTING BUILDINGS.
- ALL GRID LINES IDENTIFIED BY A LETTER OR NUMBER ARE PARALLEL, UNLESS OTHERWISE NOTED.
- SIZES OF HOUSKEEPING PADS AND BASES FOR MECHANICAL EQUIPMENT ARE APPROXIMATE. CONTRACTOR SHALL VERIFY EXACT LOCATION AND REQUIRED SIZE OF ALL CONCRETE PADS AND BASES WITH EQUIPMENT MANUFACTURERS BEFORE POURING. ALL PADS TO BE PROVIDED BY THE CONTRACTOR.
- CONTRACTOR SHALL COORDINATE THE INSTALLATION OF THE VARIOUS TRADE ITEMS WITHIN THE SPACE ABOVE THE CEILING INCLUDING, BUT NOT LIMITED TO STRUCTURAL MEMBERS AND SPRAY-ON INSULATION OR FIREPROOFING, MECHANICAL DUCTS AND BATT INSULATION, CONDENSATE TRAYS, RACEWAY, SPRINKLER SYSTEMS, LIGHT FIXTURES, CEILING SYSTEMS, AND ANY SPECIAL STRUCTURAL SUPPORTS (REQUIRED) AND SHALL BE RESPONSIBLE FOR MAINTAINING THE FINISH CEILING HEIGHT ABOVE THE FINISH FLOOR INDICATED IN THE DRAWINGS AND FINISH SCHEDULE.
- ALL METAL STUDS WALLS WHERE PLUMBING OCCURS OR STRUCTURAL COLUMNS ARE LOCATED SHALL BE MINIMUM 6" METAL STUDS. NOTIFY ARCHITECT OF ANY DISCREPANCIES OR CONFLICTS.
- PROVIDE AND INSTALL ACCESS PANELS WHERE REQUIRED BY BUILDING CODE OR FOR THE PROPER OPERATION OF MECHANICAL OR ELECTRICAL EQUIPMENT AND AS SHOWN ON THE DRAWINGS. CONTRACTOR SHALL COORDINATE SIZE, LOCATION, AND TYPE OF ACCESS PANEL WITH OTHER CONTRACTORS WORK AND RECEIVE APPROVAL OF THE ARCHITECT. ACCESS PANEL SHALL BE AS SPECIFIED.
- 3/4" FIRE-RETARDANT TREATED PLYWOOD BACKING 8'-0" HIGH SHALL BE PROVIDED AND INSTALLED ON ALL WALLS OF TELEPHONE AND ELECTRICAL ROOMS UNLESS SPECIFICALLY SHOWN OTHERWISE ON ELECTRICAL DRAWINGS.
- ALL WOOD WITHIN THIS PROJECT (IE. PLYWOOD, BLOCKING, ETC.) SHALL BE FIRE-RETARDANT TREATED.
- FOR ILLUSTRATION AND DEFINITION OF TYPICAL SYMBOLS USED ON THE ARCHITECTURAL DRAWINGS, SEE "SYMBOLS AND ABBREVIATIONS" SHEET. ADDITIONAL SYMBOLS NOT SHOWN OR DENIED THESE MAY OCCUR AND ARE DENIED ON OTHER DRAWINGS.
- REFER TO SPECIFICATIONS FOR ADDITIONAL PAINT ITEMS NOT SHOWN ON ROOM FINISH SCHEDULE.
- THE SPECIFICATIONS AND ALL CONSULTANT DRAWINGS ARE SUPPLEMENTAL TO THE ARCHITECTURAL DRAWINGS. IT SHALL BE THE CONTRACTOR'S RESPONSIBILITY TO COORDINATE WITH THE ARCHITECTURAL DRAWINGS BEFORE THE INSTALLATION OF ANY OF THE CONSULTANT'S WORK AND TO BRING ANY DISCREPANCIES OR CONFLICTS TO THE ARCHITECT'S ATTENTION FOR CLARIFICATION. IMPROPERLY INSTALLED WORK SHALL BE CORRECTED BY THE CONTRACTOR AT NO EXPENSE TO THE ARCHITECT. HIS CONSULTANTS, OR THE OWNER.
- THE ARCHITECTURAL DRAWINGS ARE A PART OF A LARGER SET OF DRAWINGS WHICH, WHEN COMPLETE, CONSISTS OF ALL DRAWINGS LISTED BY THE INDEX OF DRAWINGS. THE WORK DESCRIBED BY THE DRAWINGS OF ANY ONE DISCIPLINE MAY BE AFFECTED BY THE WORK DESCRIBED ON DRAWINGS OF ANOTHER DISCIPLINE AND MAY REQUIRE REFERENCE TO DRAWINGS OF ANOTHER DISCIPLINE. PARTIAL SETS OF DRAWINGS SHALL NOT BE DISTRIBUTED AND UTILIZED BY THE CONTRACTOR. IT IS THE CONTRACTOR'S RESPONSIBILITY TO REVIEW AND COORDINATE THE WORK OF ALL SUBCONTRACTORS, TRADES, AND SUPPLIERS WITH THE REQUIREMENTS OF THE CONTRACT BEFORE COMMENCING CONSTRUCTION AND TO ASSURE THAT ALL PARTIES ARE AWARE OF ALL REQUIREMENTS REGARDLESS OF WHERE THE REQUIREMENTS OCCUR IN THE CONTRACT DOCUMENTS.
- THE ARCHITECTURAL DRAWINGS ESTABLISH AND COORDINATE THE FINISHED APPEARANCE AND EXACT LOCATIONS OF ALL EXPOSED ELEMENTS OF THE WORK INCLUDING THAT WORK WHICH IS ILLUSTRATED PRIMARILY ON DRAWINGS OF OTHER DISCIPLINES. LOCATIONS SHOWN ON OTHER DRAWINGS ARE SCHEMATIC, UNLESS OTHERWISE NOTED ON THE ARCHITECTURAL DRAWINGS. THE ARCHITECTURAL DRAWINGS TAKE PRECEDENCE FOR THE FINISHED APPEARANCE AND EXACT LOCATION OF ALL PARTS OF THE WORK. EXCEPTIONS, DIMENSIONED LOCATIONS SHOWN ON DRAWINGS OF OTHER DISCIPLINES SHALL GOVERN ONLY WHERE: (A) SPECIFICALLY AND INDIVIDUALLY INDICATED BY SYMBOL, KEYED NOTE OR NOTATION ON THE ARCHITECTURAL DRAWINGS, (B) OCCURRING WITHIN A ROOM OR OTHER IDENTIFIED SPACE FOR WHICH ARCHITECTURAL SHEET OR SCHEDULE NOTES INDICATE THAT DIMENSIONS PROVIDED ELSEWHERE SHALL GOVERN, AND (C) OCCURRING WITHIN A ROOM OR OTHER IDENTIFIED SPACE FOR WHICH ARCHITECTURAL SHEET OR SCHEDULE NOTES INDICATE THAT DIMENSIONS PROVIDED ELSEWHERE SHALL GOVERN.
- WORK NOT SPECIFICALLY INDICATED ON A PART OF THE DRAWINGS BUT REASONABLY IMPLIED TO BE SIMILAR TO WORK SHOWN ON THE DRAWINGS IN CORRESPONDING AND OTHER PLACES SHALL BE CONSTRUCTED SIMILARLY.
- PROVIDE FIRE EXTINGUISHERS WITH A RATING OF NOT LESS THAN 2A WITHIN 75 FOOT TRAVEL DISTANCE TO ALL PORTIONS OF THE BUILDING. PROVIDE PORTABLE FIRE EXTINGUISHERS AS THE BUILDING IS CONSTRUCTED.

PROJECT LOCATION

SOUTHGATE ELEMENTARY
30.0 N. NORMAN
MOORE, OKLAHOMA 73160

Legal Description:
SOUTH GATE ALL BLK 40

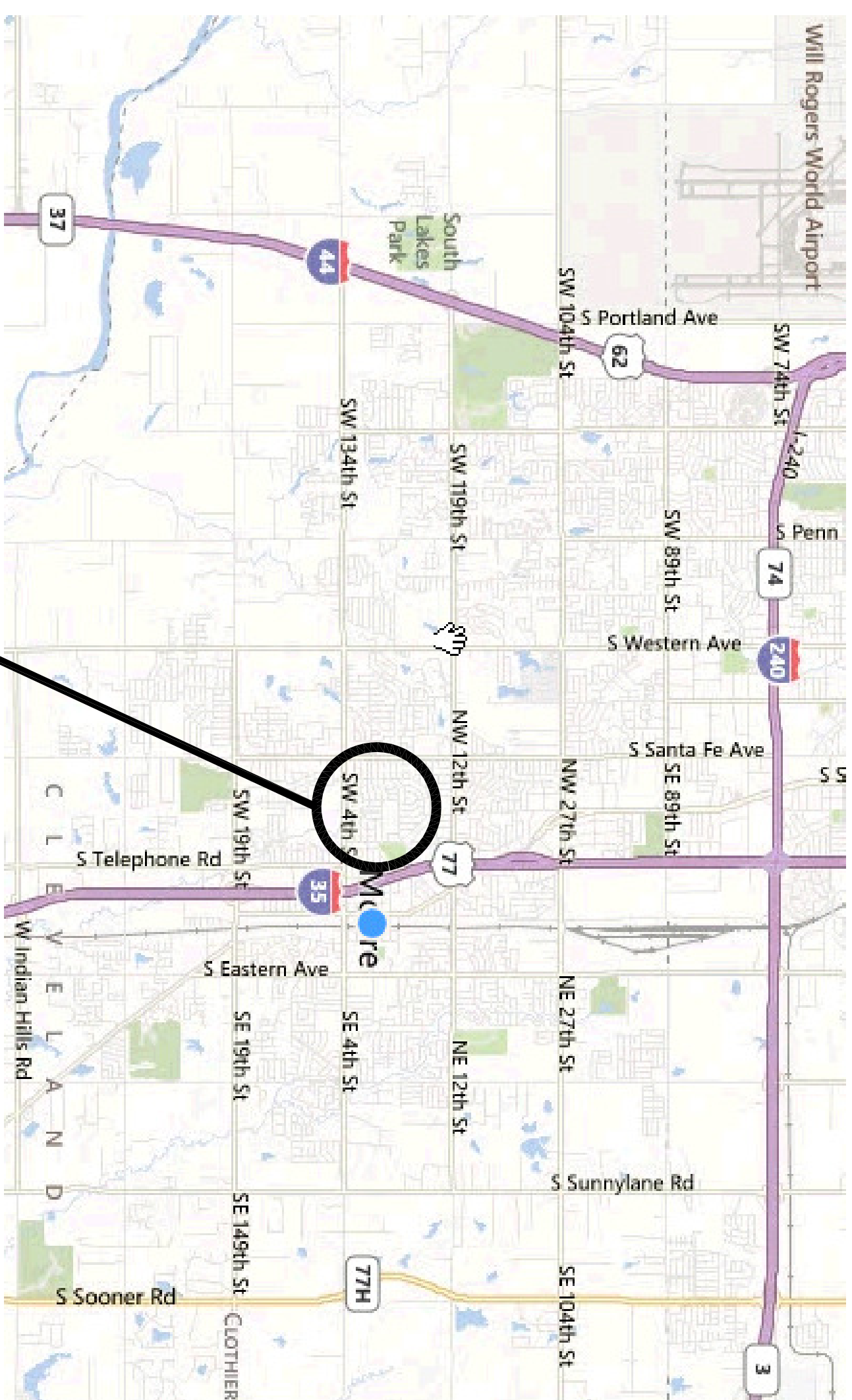

VICINITY MAP

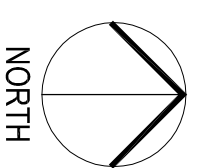

the Abla Griffin
Partnership L.L.C.

201 N. BROADWAY
SUITE 210
MOORE, OK. 73160
405.735.3477
ACGP@theACGP.net
www.theACGP.net

KFC ENGINEERING

STRUCTURAL

SALVA O'BRIEN

MECHANICAL/ELECTRICAL



CG
designed by
MA
checked by
MARC 2622
0818
revisions

MOORE PUBLIC SCHOOLS
BOARD OF EDUCATION
MOORE, OKLAHOMA

MOORE Public Schools
LEARNING FOR LIFE

OFFICE
ADDITION -
SOUTHGATE
ELEMENTARY SCHOOL

Sheet No.

G100

OWNERSHIP USE OF DOCUMENTS:

ACGP EXPRESSLY RESERVES ITS
COPYRIGHT AND OTHER PROPERTY
RIGHTS OF ALL PLANS AND DRAWINGS
DESIGNED AND/OR PRODUCED BY
ACGP. THESE PLANS AND DRAWINGS
REPRODUCED IN ANY FORM OR MANNER
WITHOUT THE EXPRESSED WRITTEN
CONSENT OF ACP.