

CG  
designed by  
MA  
checked by  
SEPTEMBER 2023  
0818  
revisions

MOORE PUBLIC SCHOOLS  
BOARD OF EDUCATION  
MOORE, OKLAHOMA



OFFICE  
ADDITION -  
SKYRANCH  
ELEMENTARY SCHOOL

Sheet No.  
**A104**

OWNERSHIP USE OF DOCUMENTS:  
AGP EXPRESSLY RESERVES ITS  
COPYRIGHT AND OTHER PROPERTY  
RIGHTS OF ALL PLANS AND DRAWINGS  
DESIGNED AND/OR PRODUCED HEREIN.  
NO PART OF THIS DOCUMENT SHALL BE  
REPRODUCED IN ANY FORM OR MANNER  
WITHOUT THE EXPRESSED WRITTEN  
CONSENT OF AGP.

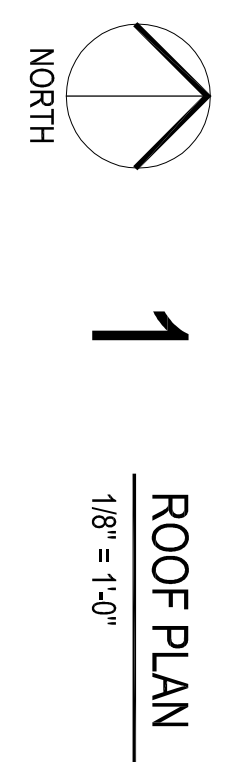
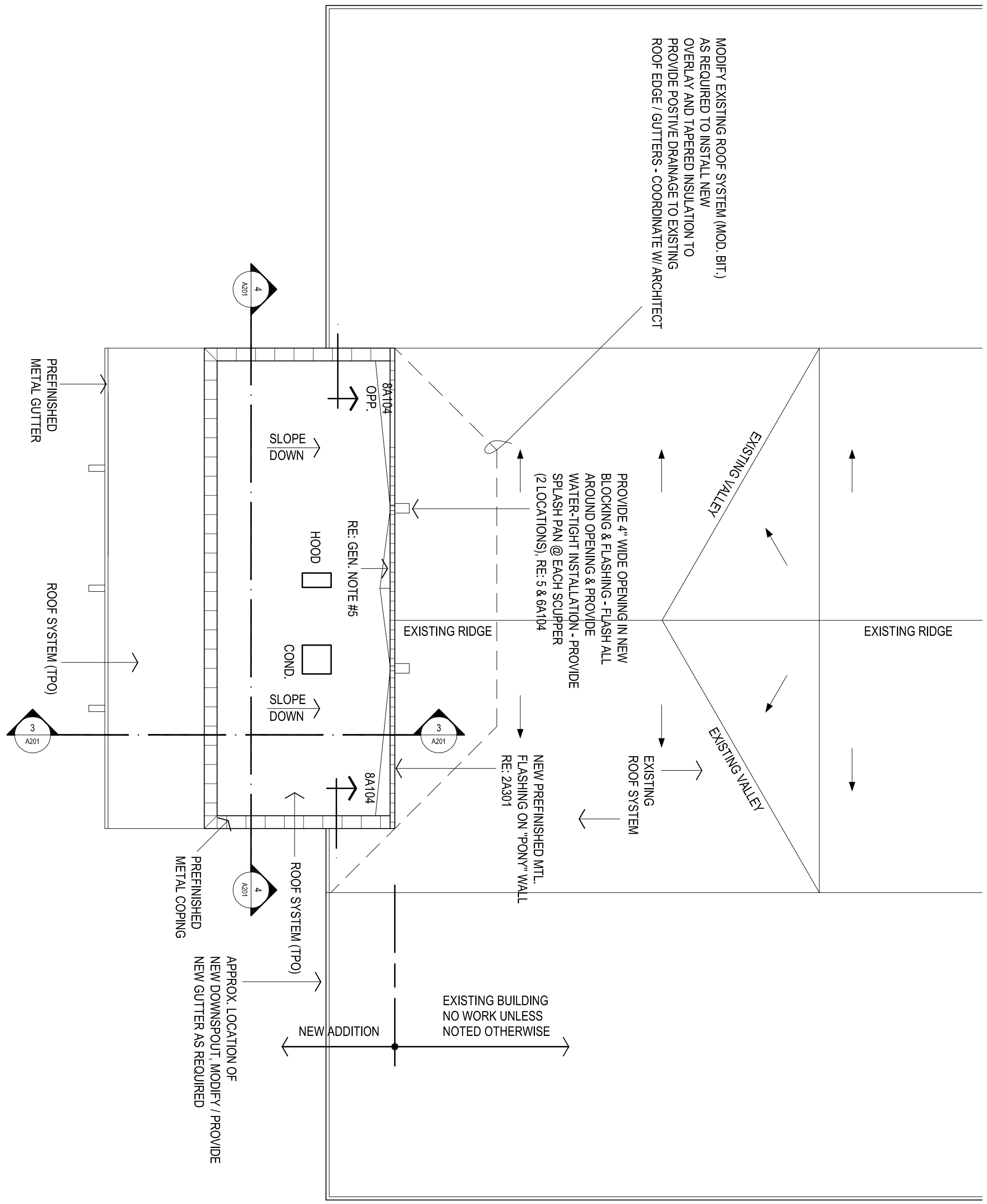

- NOTES:
1. RE: MECH & ELEC. FOR ADDITIONAL ROOF MOUNTED ITEMS. CONTRACTOR TO COORDINATE ALL ROOF MOUNTED ITEMS & PENETRATIONS W/ APPLICABLE TRADES. PROVIDE "CRICKETS" AT HIGH SIDE OF ALL CURBS.
  2. \_\_\_\_\_ G  
GAS LINE: REFER 4A105 FOR SUPPORT  
PAINT ALL GAS LINES "SAFETY" YELLOW COORDINATE W/ ARCHITECT
  3. CONTRACTOR TO COORDINATE ROOF VENT PENETRATIONS
  4. REROUTE EXISTING GAS LINES AS REQUIRED FOR NEW ADDITION & NEW ROOFING. PROVIDE ALL MATERIALS AS REQUIRED FOR A COMPLETE AND WATER TIGHT INSTALLATION.
  5. PROVIDE "CRICKETS" AS INDICATED TO PROVIDE POSITIVE DRAINAGE TO SCUPPERS. MAINTAIN A MIN. OF 1/8" PER FOOT SLOPE. TYPICAL.

