



CS
designed by _____
MA
checked by _____
SEPTEMBER 2023
0808
revisions _____

MOORE PUBLIC SCHOOLS
BOARD OF EDUCATION
MOORE, OKLAHOMA

MOORE Public Schools
LEARNING FOR LIFE

OFFICE
ADDITION -
SKYRANCH
ELEMENTARY SCHOOL

Sheet No.

A101

OWNERSHIP USE OF DOCUMENTS:

AGP EXPRESSLY RESERVES ITS
COPYRIGHT AND OTHER PROPERTY
RIGHTS OF ALL PLANS AND DRAWINGS
DESIGNED AND/OR PRODUCED HEREON.
REPRODUCTION OR TRANSMISSION
WITHOUT THE EXPRESSED WRITTEN
CONSENT OF AGP.

GENERAL NOTES:

1. FILL, GRADE & PREPARE ALL EXCAVATED AREAS TO RECEIVE NEW SITE FEATURES.
2. CONTRACTOR TO VISIT SITE PRIOR TO PREPARING BID, & VERIFY ALL ITEMS TO BE DEMOLISHED. ANY ADDITIONAL ITEMS REQUIRING DEMOLITION THAT ARE NOT INCLUDED IN THESE DOCUMENTS SHOULD BE BROUGHT TO THE IMMEDIATE ATTENTION OF THE ARCHITECT AND INCLUDED IN THE BASE BID.
3. EXISTING UNDERGROUND UTILITY LOCATIONS & CONTOUR INFORMATION HAVE BEEN OBTAINED FROM THE BEST AVAILABLE SOURCES. THE CONTRACTOR SHALL FIELD VERIFY ALL EXISTING CONDITIONS PRIOR TO COMMENCING WORK & COORDINATE W/ ARCHITECT.
4. CONTRACTORS TO FIELD VERIFY ALL EXISTING ELEVATIONS PRIOR TO STARTING EARTHWORK - AND ADJUST ACCORDINGLY AS DIRECTED BY THE ARCHITECT.
5. DURING ALL EXISTING UTILITY REVISIONS - TEMPORARY SERVICE IS TO BE PROVIDED @ ALL EFFECTED BUILDINGS.
6. ALL SALVAGEABLE ITEMS TO REMAIN OWNERS PROPERTY & SHALL BE STORED OR DISPOSED OF AS PER OWNERS INSTRUCTIONS.
7. CONSTRUCTION SHALL MEET ALL APPLICABLE CODES, ORDINANCES, REGULATIONS & STANDARDS REQUIRED BY THE CITY OF MOORE, OKLAHOMA.
8. CONSTRUCTION SHALL MEET ALL APPLICABLE REQUIREMENTS OF THE AMERICANS W/ DISABILITIES ACT INCLUDING ANY SUPPLEMENTAL REQUIREMENTS BY THE CITY OF MOORE, OKLAHOMA.
9. CONTRACTOR SHALL COORDINATE ACCESS TO SITE W/ OWNER PRIOR TO STARTING WORK. OBTAIN APPROVAL FROM OWNER FOR ON-SITE MATERIAL STORAGE, ETC. CONTRACTOR SHALL PROVIDE PROPER SEPARATION BTWN. WORK & STUDENTS.

DEMOLITION NOTES:

1. REMOVE EXISTING SOFFIT AND FRAMING. PREPARE AREA TO RECEIVE NEW ADDITION. RE: 11A301, PROTECT SOFFIT TO REMAIN. PATCH / REPLACE AS REQUIRED MATCH EXISTING.
2. REMOVE ALL EXISTING WALL MOUNTED ITEMS TO BE SALVAGED. RE: ELECTRICAL & COORDINATE W/ ARCHITECT & OWNER.
3. DEMOLISH EXISTING CONCRETE STOOP & PREPARE SUBSTRATE TO RECEIVE NEW CONCRETE SLAB. RE: A102 & STRUCTURAL
4. REMOVE EXIST. STORE FRONT SYSTEM AND PREPARE FOR NEW CONSTRUCTION
5. DEMOLISH EXISTING CONCRETE SIDEWALKS TO LIMITS INDICATED. FILL & COMPACT VOIDS & PREPARE FOR OFFICE ADDITION. WHERE APPLICABLE. PROTECT EXISTING CONCRETE SIDEWALKS TO REMAIN. REPAIR / REPLACE ANY SIDEWALKS DAMAGED DURING CONSTRUCTION W/ NEW TO MATCH EXISTING.
6. RELOCATE EXISTING BENCHES & PLANTERS AS DIRECTED BY OWNER.
7. DEMOLISH EXISTING CEILING TILES & GRID TO LIMITS INDICATED
8. DEMOLISH EXISTING CONCRETE CURB & PREPARE SUBSTRATE TO RECEIVE NEW CONCRETE CURB. RE: C100
9. REMOVE EXISTING 14H4 OPEN WEB STEEL JOISTS. RE: STRUCTURAL NUMBER NOT USED
10. REMOVE EXISTING SURFACE MOUNTED KNOX BOX AND RELOCATE AS PER AHJ AND OWNER.
12. REMOVE EXISTING LIGHT FIXTURES CONDUIT AND ASSOCIATED MATERIALS AT UNDERSIDE OF EXISTING SOFFIT. TERMINATE AT NEAREST JUNCTION BOX INSIDE BUILDING AS REQUIRED BY CODE.
13. REMOVE EXISTING LIGHT FIXTURES AND ASSOCIATED MATERIALS AT EXISTING CORRIDOR. REMOVE CONDUIT AND ASSOCIATED MATERIALS AT NEAREST JUNCTION BOX INSIDE BUILDING AS REQUIRED BY CODE. RE: ELECTRICAL FOR NEW FIXTURES
14. MODIFY EXISTING W14X26 BEAM AS NECESSARY FOR NEW ADDITION RE: STRUCTURAL
15. REMOVE EXISTING CURB AND GUTTER AS REQUIRED FOR NEW H.C. RAMP. RE: C100

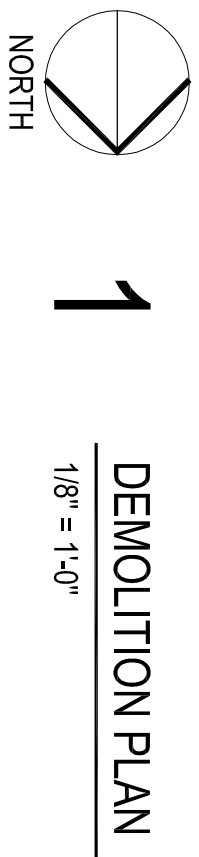
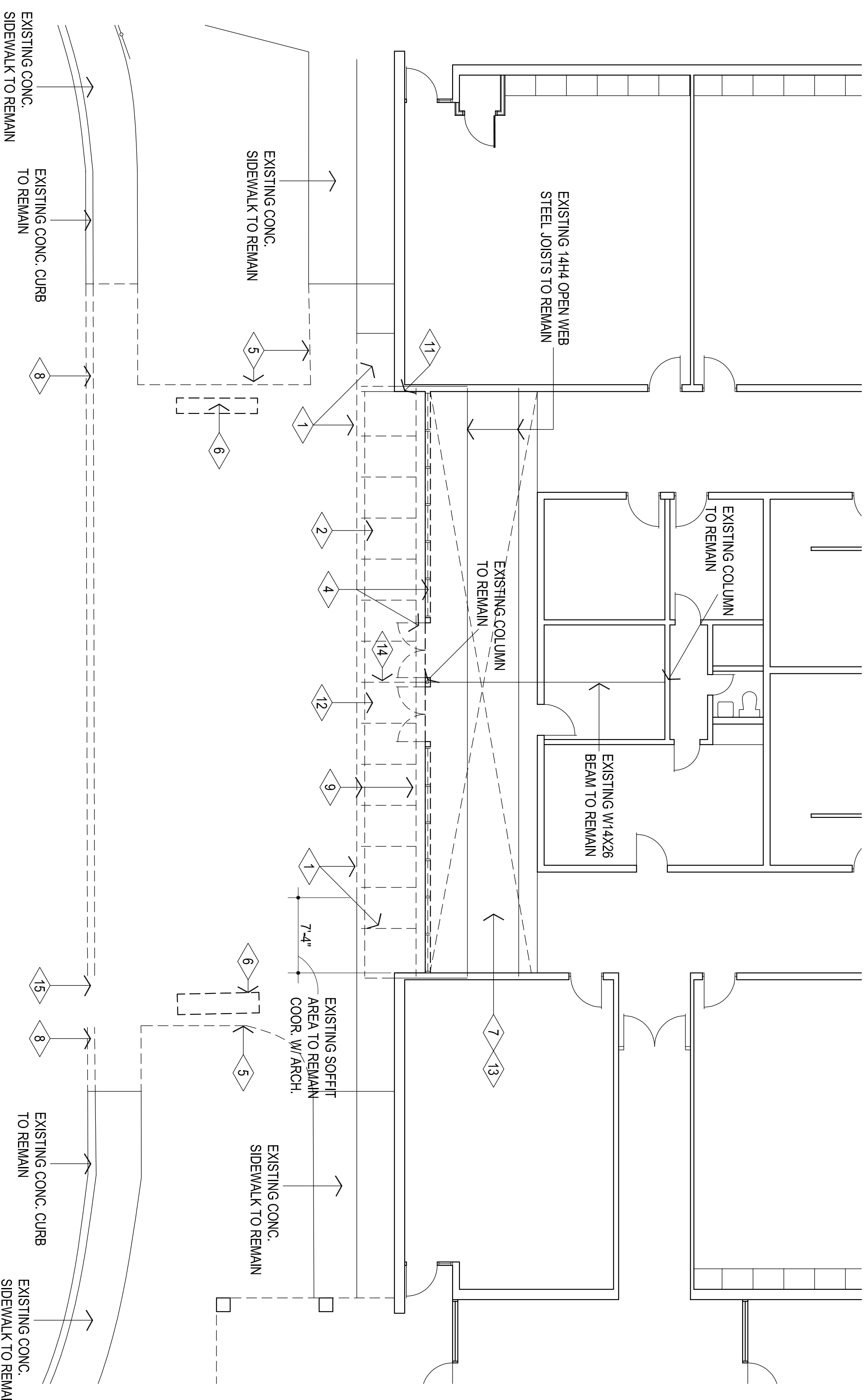

DEMOLITION PLAN
1/8" = 1'-0"