

ABBREVIATIONS

ABV	ABOVE	HWND	HARDWOOD
ACOUNT.	ACOUNTABLE	HWR	HARDWARE
ADJ.	ADJUSTABLE	HORIZ.	HORIZONTAL
ANCHOR	ANCHOR	HT	HEIGHT
APPROX.	APPROXIMATE	INSUL.	INSULATION
BD.	BOARD	JST.	JOIST
BLG.	BLOCKING	JT.	JOINT
BL.	BEAM	L.V.	LAVATORY
BT.	BOTTOM	MAX.	MAXIMUM
C	CENTERLINE	MACH.	MECHANICAL
CL.G.	CEILING	MFG.	MANUFACTURING
CONC.	CONCRETE	MFR.	MANUFACTURER
CONU.	CONCRETE MASONRY UNIT	MIS.	MISCELLANEOUS
COL.	COLUMN	MISC.	MISCELLANEOUS
CONT.	CONTINUOUS	MTL.	METAL
D.F.	DRINKING FOUNTAIN	N.I.C.	NOT IN CONTRACT
DM.	DRINKING FOUNTAIN	N.O./#	NUMBER NOT TO SCALE
DR.	DRUM	N.T.S.	NOT TO SCALE
DWG.	DRAWING	O.C.	ON CENTER
DWL.	DOWEL	OPN.	OPENING
EA.	EACH	OP.	OPERATE
ELECT.	ELECTRICAL	P.P.	POWER POLE
ELEV.	ELEVATION	PREFN.	PREFINISHED
EQ.	EQUAL	P.T.	PAPER TOWEL
E.I.	EACH WAY	P.W./PLY WD.	PLYWOOD
E.W.	EXPANSION JOINT	REDD.	REFERRED
EXST.	EXISTING	RELD.	REFERRED
EXP.	EXPANSION	RM.	ROOM
EXT.	EXTERIOR	S.B.	SPLASH BLOCK
FD.	FLOOR DRAIN	SCHD.	SCHEDULE
FE.	FIRE EXTINGUISHER	STD.	STANDARD
FEL.	FIRE EXTINGUISHER CABINET	STL.	STEEL
FFC.	FINISH FLOOR LINE	S.U.	SAWJOINT
FN.	FINISH	T.C.	TOP OF CURB
FRMG.	FRAMING	T.P.H.	TYPICAL
GA.	GAUGE	TYP.	TYPICAL
GB.	GRAB BAR	UNO.	UNLESS NOTED OTHERWISE
GALV.	GALVANIZED	VTR.	VENT THROUGH ROOF
GYP.	GYP-SUM BOARD	W.C.	WATERCLOSET
HC.	HANDICAP	WD.	WOOD
		WWF.	WELDED WIRE FABRIC

MATERIALS LEGEND

	MASONRY VENEER
	C.M.U.
	CONCRETE
	FRAME PARTITION, METAL STUDS
	GYP-SUM BOARD
	PARTICLE BOARD
	RIGID INSULATION
	WOOD BLOCKING / FRAMING, CONTINUOUS
	WOOD BLOCKING, DISCONTINUOUS
	FINISH WOOD
	SMALL SCALE STRUCTURAL STEEL / MISCELLANEOUS METAL
	LARGE SCALE STRUCTURAL STEEL
	BATT INSULATION
	ACOUSTICAL CEILING TILE
	EARTH FILL

SYMBOLS LEGEND

	EXISTING SPOT ELEVATION
	FINISH SPOT ELEVATION
	EXISTING GRADE CONTOUR
	FINISH GRADE CONTOUR
	EXISTING TREE TO BE PROTECTED
	EXISTING TREE TO BE REMOVED
	PROJECT LIMITS
	CHANLINK FENCE
	BARBED WIRE FENCE
	CONCRETE PAVING
	ASPHALT PAVING
	CONCRETE SIDEWALK
	EXISTING PAVING/SIDEWALK TO REMAIN
	EXISTING PAVING TO BE REMOVED
	NEW BUILDING
	EXISTING BUILDING - NO WORK
	ROOM NUMBER
	ROOM NUMBER, LARGE
	SCALE PLAN REFERENCE
	ROOM NUMBER/INTERIOR ELEVATION REFERENCE
	WALL SECTION/DETAIL CUT MARK
	LARGE SCALE DETAIL MARK
	STRUCTURAL GRID COORDINATES
	BUILDING SECTION CUT MARK
	DOOR NUMBER
	WINDOW MARK
	FRAME MARK
	GLAZING MATERIAL MARK
	EQUIPMENT MARK
	EXTERIOR ELEVATION MARK
	TEST HOLE
	BENCH MARK/BUILDING ELEVATION (SECTION)

GENERAL NOTES:

- ALL REQUIRED HANDICAP ACCESSIBLE ITEMS TO COMPLY WITH AMERICANS WITH DISABILITIES ACT AND ARCHITECTURAL BARRIERS ACT ACCESSIBILITY GUIDELINES.
- THE CONTRACTOR SHALL NOT USE ANY LEAD-BASED PAINT OR ASBESTOS CONTAINING MATERIAL ON THIS PROJECT.
- THESE CONTRACT DOCUMENTS INCLUDING BUT NOT LIMITED TO THE DRAWINGS, PROJECT MANUAL AND ANY SUBSEQUENT ADDENDA ARE ISSUED AS A "WHOLE" AND SHALL BE BID AS SUCH. EACH DISCIPLINE / SUBCONTRACTOR SHALL REVIEW THE ENTIRE SET OF CONTRACT DOCUMENTS AND INCLUDE APPLICABLE WORK IN THEIR BID REGARDLESS OF LOCATION WITHIN THE CONTRACT DOCUMENTS. REVIEWING ONLY A PORTION OF THE CONTRACT DOCUMENTS SHALL NOT ABSOLVE THE CONTRACTOR OR SUBCONTRACTOR OF THE REQUIREMENT TO PERFORM THE WORK OF THEIR RESPECTIVE DISCIPLINES.
- LOCATIONS OF EXISTING BUILDINGS, SITE FEATURES, & UNDERGROUND UTILITIES HAVE BEEN OBTAINED FROM EXISTING AVAILABLE SOURCES. THE CONTRACTOR IS TO FIELD VERIFY EXISTING LOCATIONS PRIOR TO STARTING CONSTRUCTION AND NOTIFY THE ARCHITECT IMMEDIATELY IF ANY EXISTING BUILDING OR SITE FEATURE CONFLICTS WITH THE NEW CONSTRUCTION.
- THE CONTRACTOR SHALL VERIFY ALL EXISTING SITE UTILITIES AND PROTECT DURING CONSTRUCTION. COORDINATE NEW UTILITY REQUIREMENTS WITH APPLICABLE UTILITY COMPANIES (WATER, GAS, ELECTRICITY, SANITARY, SEWER, TELEPHONE, CABLE, SITE DRAINAGE AND OTHERS AS REQUIRED). COMPLY WITH ALL APPLICABLE REGULATIONS. INCLUDE ALL CONNECTION FEES AND OTHER CHARGES IN BID.
- REFER TO MECHANICAL AND ELECTRICAL DRAWINGS FOR UTILITY INFORMATION.
- REFER TO MECHANICAL AND ELECTRICAL DRAWINGS FOR ADDITIONAL REQUIREMENTS AND CONCRETE TO BE PROVIDED BY CONTRACTOR.
- GENERAL CONTRACTOR TO VERIFY LOCATIONS OF EXISTENTS, ENCUMBRANCES AND SET BACKS PRIOR TO STARTING CONSTRUCTION.
- CONFLICTS BETWEEN DRAWINGS AND SPECIFICATIONS SHALL BE BROUGHT TO ARCHITECTS ATTENTION. FAILURE TO BID ITEMS NOTED ON DRAWINGS AND OMITTED FROM SPECIFICATIONS DOES NOT REMOVE RESPONSIBILITY TO PROVIDE AND INSTALL SUCH CHANGES IN BID.

GENERAL NOTES (CONT):

- CONSTRUCTION STAGING AREA & VEHICLE ACCESS SHALL BE CONFIRMED WITH OWNER, AND CONSTRUCTION MANAGER IF APPLICABLE. PRIOR TO CONSTRUCTION, FINISH GRADE AT BUILDING PERIMETERS SHALL BE 6" BELOW FINISH FLOOR UNLESS SPECIFICALLY NOTED OTHERWISE ON CIVIL DRAWINGS. DEVELOP POSITIVE DRAINAGE AWAY FROM NEW AND/OR EXISTING BUILDINGS!
- ALL GRID LINES IDENTIFIED BY A LETTER OR NUMBER ARE PARALLEL, UNLESS OTHERWISE NOTED.
- SIZES OF HOUSKEEPING PADS AND BASES FOR MECHANICAL EQUIPMENT ARE APPROXIMATE. CONTRACTOR SHALL VERIFY EXACT LOCATION AND REQUIRED SIZE OF ALL CONCRETE PADS AND BASES WITH EQUIPMENT MANUFACTURERS BEFORE POURING. ALL PADS TO BE PROVIDED BY THE CONTRACTOR.
- CONTRACTOR SHALL COORDINATE THE INSTALLATION OF THE VARIOUS TRADE ITEMS WITHIN THE SPACE ABOVE THE CEILING INCLUDING, BUT NOT LIMITED TO STRUCTURAL MEMBERS AND SPRAY-ON INSULATION OR FIBERGLASS, MECHANICAL DUCTS AND BATT INSULATION, RACEWAY, SPRINKLER SYSTEMS, LIGHT FIXTURES, CEILING SYSTEMS, AND ANY SPECIAL STRUCTURAL SUPPORTS (REQUIRED) AND SHALL BE RESPONSIBLE FOR MAINTAINING THE FINISH CEILING HEIGHT ABOVE THE FINISH FLOOR INDICATED IN THE DRAWINGS AND FINISH SCHEDULE.
- ALL METAL STUDS WHERE PLUMBING OCCURS OR STRUCTURAL COLUMNS ARE LOCATED SHALL BE MINIMUM 6" METAL STUDS. NOTIFY ARCHITECT OF ANY DISCREPANCIES OR CONFLICTS.
- PROVIDE AND INSTALL ACCESS PANELS WHERE REQUIRED BY BUILDING CODE OR FOR THE PROPER OPERATION OF MECHANICAL OR ELECTRICAL EQUIPMENT, AND AS SHOWN ON THE DRAWINGS. CONTRACTOR SHALL COORDINATE SIZE, LOCATION, AND TYPE OF ACCESS PANEL WITH OTHER CONTRACTORS WORK AND RECEIVE APPROVAL OF THE ARCHITECT. ACCESS PANEL SHALL BE AS SPECIFIED.
- 3/4" FIRE-RETARDANT TREATED PLYWOOD BACKING 8'-0" HIGH SHALL BE PROVIDED AND INSTALLED ON ALL WALLS OF TELEPHONE AND ELECTRICAL ROOMS UNLESS SPECIFICALLY SHOWN OTHERWISE ON ELECTRICAL DRAWINGS.
- ALL WOOD WITHIN THIS PROJECT (IE. PLYWOOD, BLOCKING, ETC.) SHALL BE FIRE-RETARDANT TREATED.
- FOR ILLUSTRATION AND DEFINITION OF TYPICAL SYMBOLS USED ON THE ARCHITECTURAL DRAWINGS, SEE "SYMBOLS AND ABBREVIATIONS" SHEET. ADDITIONAL SYMBOLS NOT SHOWN OR DENIED THESE MAY OCCUR AND ARE DENIED ON OTHER DRAWINGS.
- REFER TO SPECIFICATIONS FOR ADDITIONAL PAINT ITEMS NOT SHOWN ON ROOM FINISH SCHEDULE.
- THE SPECIFICATIONS AND ALL CONSULTANT DRAWINGS ARE SUPPLEMENTAL TO THE ARCHITECT'S WORK AND TO BRING ANY DISCREPANCIES OR CONFLICTS TO THE ARCHITECT'S ATTENTION FOR CLARIFICATION. IMPROPERLY INSTALLED WORK SHALL BE CORRECTED BY THE CONTRACTOR AT NO EXPENSE TO THE ARCHITECT. HIS CONSULTANTS, OR THE OWNER.
- THE ARCHITECTURAL DRAWINGS ARE A PART OF A LARGER SET OF DRAWINGS WHICH, WHEN COMPLETE, CONSISTS OF ALL DRAWINGS LISTED BY THE INDEX OF DRAWINGS. THE WORK DESCRIBED BY THE DRAWINGS OF ANY ONE DISCIPLINE MAY BE AFFECTED BY THE WORK DESCRIBED ON DRAWINGS OF ANOTHER DISCIPLINE AND MAY REQUIRE REFERENCE TO DRAWINGS OF ANOTHER DISCIPLINE. PARTIAL SETS OF DRAWINGS SHALL NOT BE DISTRIBUTED AND UTILIZED BY THE CONTRACTOR. IT IS THE CONTRACTOR'S RESPONSIBILITY TO REVIEW AND COORDINATE THE WORK OF ALL SUBCONTRACTORS, TRADES, AND SUPPLIERS WITH THE REQUIREMENTS OF THE CONTRACT BEFORE COMMENCING CONSTRUCTION AND TO ASSURE THAT ALL PARTIES ARE AWARE OF ALL REQUIREMENTS REGARDLESS OF WHERE THE REQUIREMENTS OCCUR IN THE CONTRACT DOCUMENTS.
- THE ARCHITECTURAL DRAWINGS ESTABLISH AND COORDINATE THE FINISHED APPEARANCE AND EXACT LOCATIONS OF ALL EXPOSED ELEMENTS OF THE WORK INCLUDING THAT WORK WHICH IS ILLUSTRATED PRIMARILY ON DRAWINGS OF OTHER DISCIPLINES. LOCATIONS SHOWN ON OTHER DRAWINGS ARE SCHEMATIC, UNLESS OTHERWISE NOTED ON THE ARCHITECTURAL DRAWINGS. TAKE PRECEDENCE FOR THE FINISHED APPEARANCE AND EXACT LOCATION OF ALL PARTS OF THE WORK. EXCEPTIONS, DIMENSIONED LOCATIONS SHOWN ON DRAWINGS OF OTHER DISCIPLINES SHALL GOVERN ONLY WHERE: (A) SPECIFICALLY AND INDIVIDUALLY INDICATED BY SYMBOL, KEYED NOTE OR NOTATION ON THE ARCHITECTURAL DRAWINGS; (B) OCCURRING WITHIN A ROOM OR OTHER IDENTIFIED SPACE FOR WHICH ARCHITECTURAL SHEET OR SCHEDULE NOTES INDICATE THAT DIMENSIONS PROVIDED ELSEWHERE SHALL GOVERN; AND (C) OCCURRING WITHIN A ROOM OR OTHER IDENTIFIED SPACE FOR WHICH ARCHITECTURAL SHEET OR SCHEDULE NOTES INDICATE THAT DIMENSIONS PROVIDED ELSEWHERE SHALL GOVERN.
- WORK NOT SPECIFICALLY INDICATED ON A PART OF THE DRAWINGS BUT REASONABLY IMPLIED TO BE SIMILAR TO WORK SHOWN ON THE DRAWINGS IN CORRESPONDING AND OTHER PLACES SHALL BE CONSTRUCTED SIMILARLY.
- PROVIDE FIRE EXTINGUISHERS WITH A RATING OF NOT LESS THAN 2A WITHIN 75 FOOT TRAVEL DISTANCE TO ALL PORTIONS OF THE BUILDING. PROVIDE PORTABLE FIRE EXTINGUISHERS AS THE BUILDING IS CONSTRUCTED.

PROJECT LOCATION

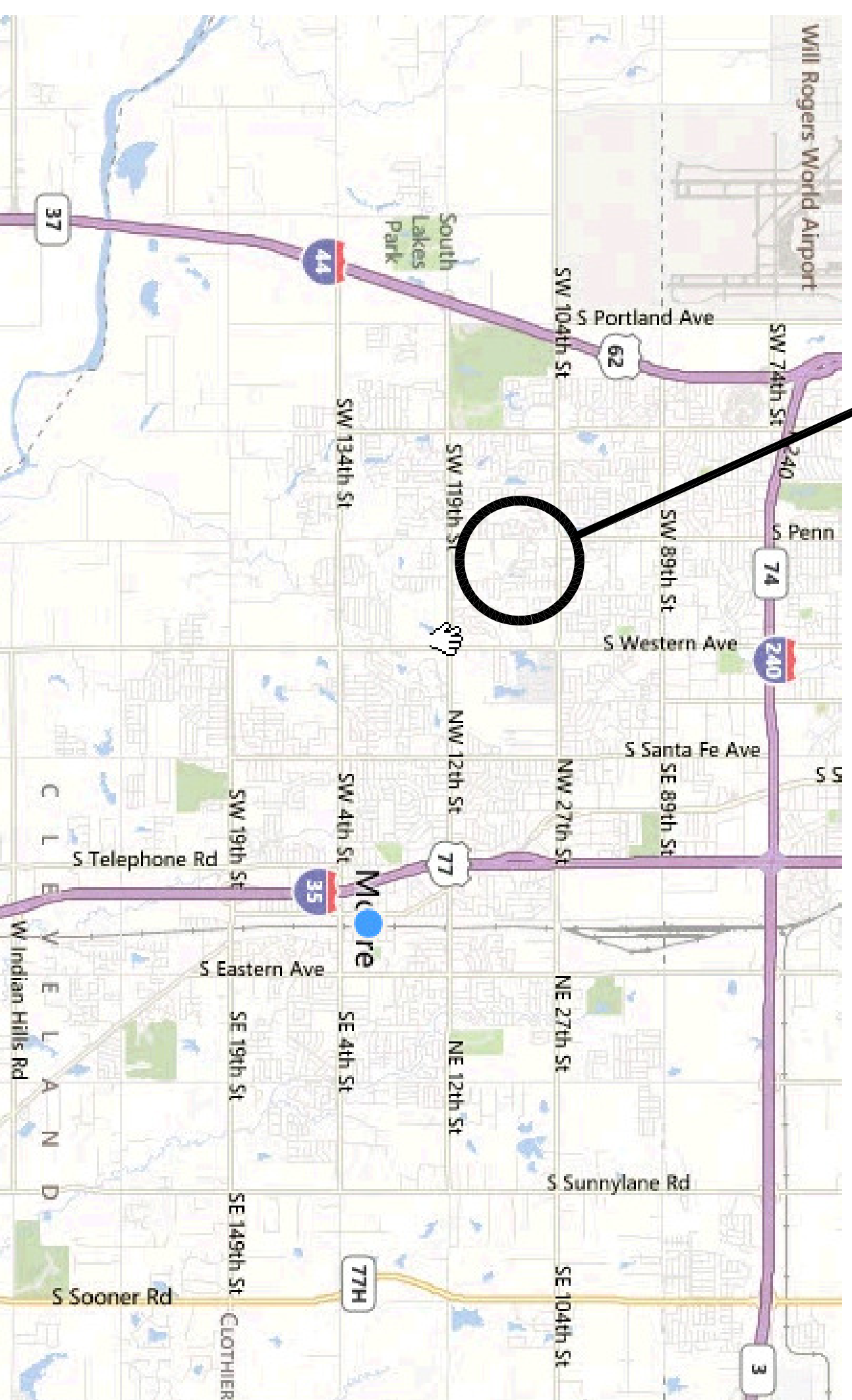

VICINITY MAP

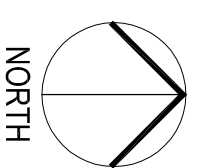

RED OAK ELEMENTARY SCHOOL
11224 S. PENN
OKLAHOMA CITY, OKLAHOMA 73170



the Abba Griffin Partnership L.L.C.

201 N. BROADWAY
SUITE 210
MOORE, OK, 73160
405.735.3477
ACGP@theACGP.net
www.theACGP.net

KFC ENGINEERING

STRUCTURAL

SALVA OGBRIEN

PLUMBING / MECHANICAL / ELECTRICAL



CS

drawn by

MA

checked by

MAY 2024

date

revisions

MOORE PUBLIC SCHOOLS
BOARD OF EDUCATION
MOORE, OKLAHOMA

MOORE Public Schools
LEARNING FOR LIFE

RED OAK
ELEMENTARY SCHOOL
SECURITY UPGRADES

Sheet No.

G100

OWNERSHIP USE OF DOCUMENTS:

AGP EXPRESSLY RESERVES ITS COPYRIGHT AND OTHER PROPERTY RIGHTS OF ALL PLANS AND DRAWINGS DESIGNED AND/OR PRODUCED BY AGP. THESE PLANS AND DRAWINGS ARE REPRODUCED IN ANY FORM OR MANNER WITHOUT THE EXPRESSED WRITTEN CONSENT OF AGP.