

FIRE SYSTEM INFORMATION - JOB#8170091			
FIRE SYSTEM NO	TAG	TYPE	SIZE
1	ITEM-28	TANK F.S	4.0/4.0

INSTALLATION			
MAX FP	DESIGN FP	SYSTEM	LOCATION
40	37	FIRE CABINET RIGHT	RIGHT, HOOD 1

GAS VALVES(S)			
FIRE SYSTEM NO	TAG	TYPE	SIZE
1	ITEM-28	SC ELECTRICAL	2.000

**FIRE SYSTEM PARTS LIST KEY**

FIRE SYSTEM NO	TAG	KEY NUMBER - PART DESCRIPTION	QTY BY FACTORY	QTY BY DIST
0-0-0	0-0	TANK FIRE SUPPRESSION POST-DISCHARGE PROCEDURE UTILITY CABINET LABEL SHEET.	1	0
0-0-0	0-0	TANK FIRE SUPPRESSION MAINTENANCE GUIDE UTILITY CABINET LABEL SHEET.	1	0
0-0-0	12-1230921-32144-01	960 BUET FIRE THERMOSTAT WITH 12 FOOT WIRE LEADS. NO. CLOSE DN TEMP RISE AT 360°F. (A00344310).	1	0
0-0-0	32-00002	QUIK SEAL - 1/2" (QJ).	1	0
0-0-0	4429K422	1/2" X 1/4" BRASS REDUCING BUSHING	2	0
0-0-0	79525	1/2" 90 DEG PRESS ELBOW WITH 1/2" NPT FEMALE CONNECTION, VIEGA	1	0
0-0-0	79580	1/2" X 1/2" PRG-PRESS TEE X 1/2" NPT FEMALE CONNECTION, VIEGA	2	0
0-0-0	87-120042-001	SECONDARY ACTUATOR VALVE (SVA) - SINGLE ACTUATOR, REQUIRES FRIBARK® RELEASE ACTUATOR, TANK FIRE SUPPRESSION.	1	0
0-0-0	87-120045-001	HOSE, SECONDARY ACTUATOR HOSE, 75' BRAIDED STAINLESS STEEL, TANK FIRE SUPPRESSION.	1	0
0-0-0	87-300001-001	TANK - PRESSURIZED TANK USED FOR TANK FIRE SUPPRESSION.	2	0
0-0-0	87-300030-001	PRIMARY ACTUATOR KIT (PAK) - ACTUATOR AND RELEASE SOLENOID ASSEMBLY, ONE NEEDED PER FIRE SYSTEM, SUPERVISED, TANK FIRE SUPPRESSION.	1	0
0-0-0	87-300033-001	DIN CONNECTOR, CAMFIELD PART #53560-201-EU0A, TANK FIRE SUPPRESSION, SUBMINATURE SOLENOID CONNECTION (CED VENDOR 30272)	1	0
0-0-0	87-300152-001	HARDWARE, SVA BOLTS, TANK FIRE SUPPRESSION.	8	0
0-0-0	9097200PC	PRD PRESS 1/2" PRESS X PRESS 90 ELBOW LD.	6	0
0-0-0	9097200PC	PRD PRESS FCG11 1/2" PRESS TEE LD.	7	0
0-0-0	98694415	HARDWARE, DATANKLOCK LOCKING BRACKET SQUARE NUTS 5/16" ZINC, TANK FIRE SUPPRESSION.	4	0
0-0-0	A0034332	JUNCTION BOX FOR MANUAL PULL STATION, 15" DEEP BACK BOX, RED COLOUR.	1	0
0-0-0	A31484	1/4" NPT SCHROEDER VALVE AND CAP, JB INDUSTRIES, 1/4" FLARE X 1/4" NPT HALF UNION, USED ON TANK SERVICE PART.	1	0
0-0-0	B1145	3/8" BLACK IRON 90 ELL.	3	0
0-0-0	0-0	DATANKLOCK DISCHARGE ADAPTER TANK LOCKING PLATE FOR FIRE SYSTEM TANK INSTALLATION IN UTILITY CABINETS, TANK FIRE SUPPRESSION.	2	0
0-0-0	0-0	TANK STRAP TANK STRAP - USED FOR TANK FIRE SUPPRESSION.	6	0
0-0-0	0-0	TES-UTANKBRACKET TANK BRACKET FOR FIRE SYSTEM TANK INSTALLATION IN UTILITY CABINETS, TANK FIRE SUPPRESSION.	2	0
0-0-0	0-0	WK-283952-000 DISCHARGE ADAPTER, TANK FIRE SUPPRESSION.	2	0
16-16	16-16	79210 1/2" X 3/8" NPT MALE ADAPTER, VIEGA	8	0
16-16	16-16	DL-F NOZZLE - TANK PROTECTION APPLIANCE COVERAGE NOZZLE (INCLUDES METAL BLOW OFF CAP, LANYARD, USED WITH CHROME-PLATED PIPE).	8	0
26-26	26-26	05A-3/8 OILK SEAL - 3/8" (QJ).	8	0
34-34	34-34	A0034331 RED COLOUR - 2AVDF SINGLE ACTION MANUAL ACTUATION DEVICE (PUSH/PULL STATION) WITH PROTECTIVE COVER, ONE (1) NORMALLY OPEN CONTACT.	1	0

**TANK MANUAL ACTIVATION DEVICE DETAIL**

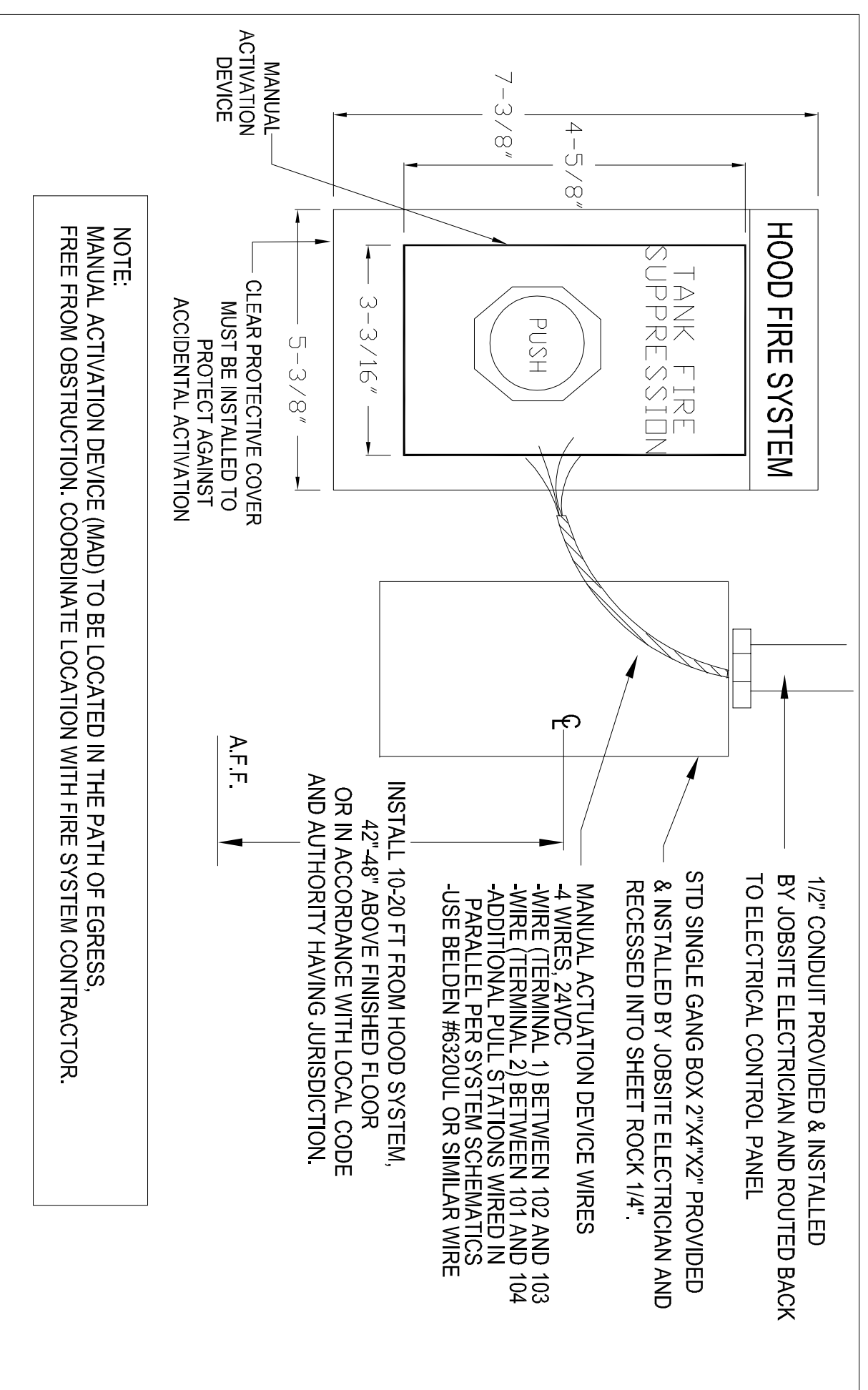

**VERIFY VERIFY GAS VALVE SIZE REQUIRED**

**GAS VALVE FOR FISH →**

GAS VALVE SIZING				GAS VALVE DIMENSIONS				INSTALLATION			PART NUMBERS					
TYPE	SIZE	VOLTAGE	MIN INLET PRESSURE	MAX INLET PRESSURE	FLOW AT 1 IN.W.C. DROP NATURAL GAS	FLOW AT 1 IN.W.C. DROP PROPANE	DIM 'A'	DIM 'B'	DIM 'C'	DIM 'D'	DIM 'E'	DIM 'G'	PIPE ORIENTATION	GAS VALVE PART NUMBER	STRAINER PART NUMBER	GAS VALVE/STRAINER KIT
ELECTRICAL	2"	120 VAC	0.75 PSI (0.51 IN.W.C.)	1.5 PSI (1.08 IN.W.C.)	2340/500 BTUHR	1380/348 BTUHR	7-5/8"	6-3/8"	7-1/4"	7-13/16"	15-5/8"	13-11/16"	HORIZONTAL/VERTICAL	8214280	4417K68	(SC)E6V2

ELECTRIC GAS VALVES ONLY SOLENOID ORIENTATION  
 3/4" X 2" 120VAC GAS VALVES CAN BE MOUNTED WITH THE SOLENOID IN AN HORIZONTAL, 3/12" X 3" 120VAC STRAINERS A MINIMUM OF 4" CLEARANCE DISTANCE MUST BE PROVIDED AT ALL POINTS AS WELL AS PRESSURE RATING SPECIFIC GRAVITY OF NATURAL GAS = 0.94  
 2" GAS VALVES MUST BE MOUNTED WITH THE SOLENOID VERTICAL AND UPRIGHT.  
 SPECIFIC GRAVITY OF LP = 1.52

ALL GAS VALVES/STRAINERS  
 PROPER CLEARANCE MUST BE PROVIDED IN ORDER TO SERVICE THE  
 STRAINERS A MINIMUM OF 4" CLEARANCE DISTANCE MUST BE PROVIDED AT ALL POINTS AS WELL AS PRESSURE RATING SPECIFIC GRAVITY OF NATURAL GAS = 0.94  
 SPECIFIC GRAVITY OF LP = 1.52

CALCULATIONS  
 TO CALCULATE GAS FLOW FOR OTHER THAN 1 IN.W.C. PRESSURE DROP  
 NEW BTUHR = (BTUHR AT 1 IN.W.C. PRESSURE DROP) X NEW PRESSURE DROP<sup>0.5</sup>  
 NEW BTUHR = (BTUHR AT 0.881 X 0.84) / NEW SPECIFIC GRAVITY<sup>0.5</sup>

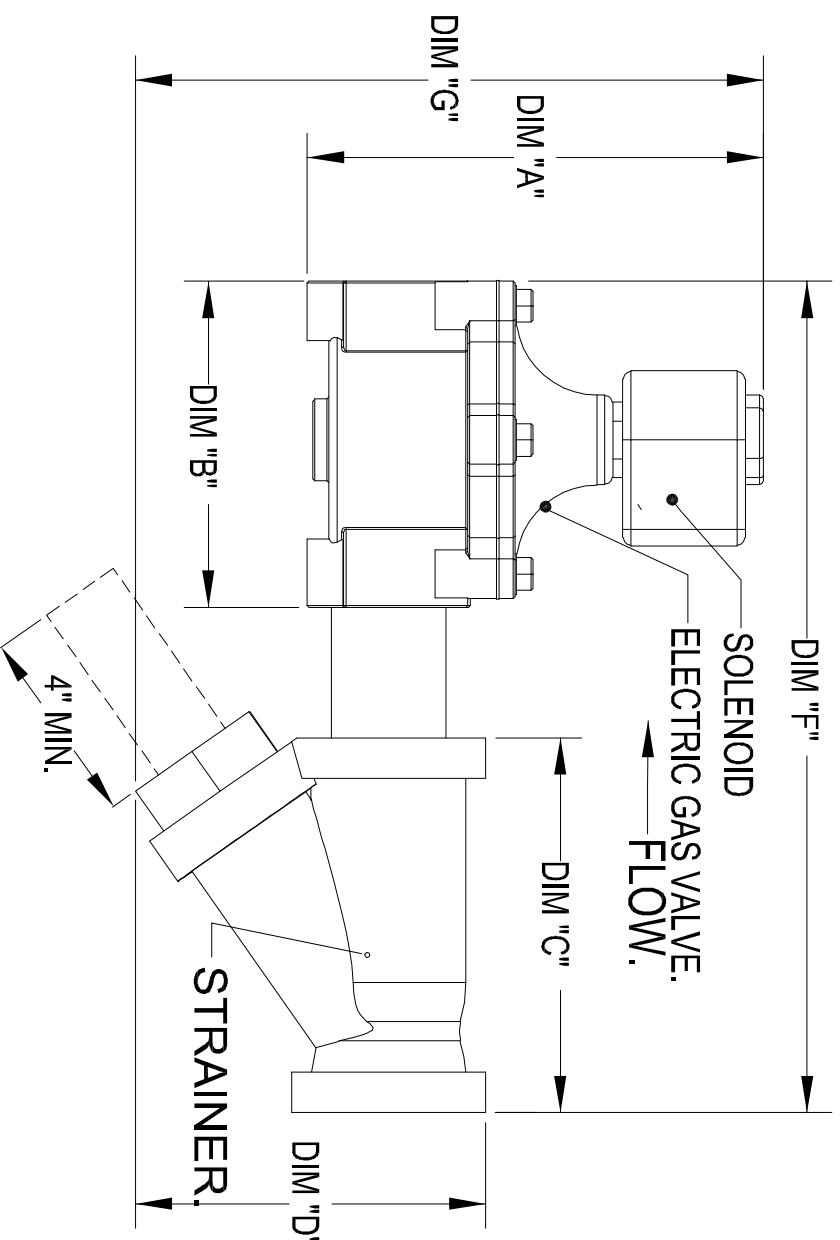

REVISIONS	DATE	DESCRIPTION
1		
2		
3		
4		

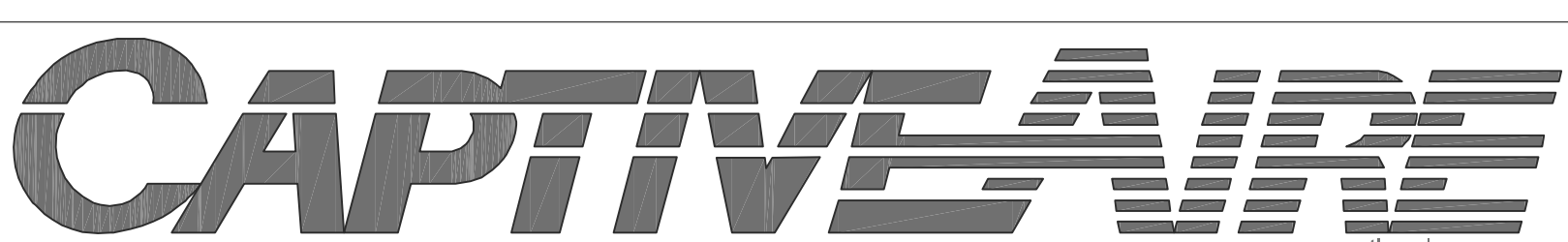

Tulsa Office

12101 East 51st Street, Suite 101A, Tulsa, OK, 74146 PHONE: (918) 258 - 0291 FAX: 9192275947 EMAIL: reg80@captiveaire.com

DATE:	8/12/2025
DWG.#:	8170091
DRAWN BY:	RJH-80
SCALE:	3/4" = 1'-0"
MASTER DRAWING	
SHEET NO.	4

Old School Building  
 201 N Broadway Ave,  
 Moore, OK, 73160

**AGP**  
 the Abia Griffin  
 Partnership L.L.C.  
 313 S. E. 5th Street  
 MOORE, OK, 73160  
 405.735.3477  
 AGP@theAGP.net  
 www.theAGP.net

CDAR CREEK  
 CIVIL  
 KFC ENGINEERING  
 STRUCTURAL  
 SALLAS OBREN  
 MECHANICAL/ELECTRICAL

RS  
 drawn by  
 RS  
 checked by  
 November 2025  
 date  
 revisions

**MOORE**  
 PUBLIC SCHOOLS

OLD SCHOOL  
 UPGRADES

Sheet no:  
**FS504**

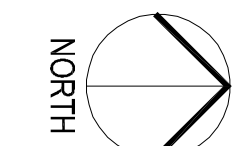

**FOODSERVICE EQUIPMENT VENTILATOR PLAN**

1  
 1/4" = 1'-0"

OWNERSHIP USE OF DOCUMENTS:  
 ACP EXPRESSLY RESERVES ITS  
 COPYRIGHT AND OTHER PROPERTY  
 RIGHTS OF ALL PLANS AND DRAWINGS  
 DESIGNED AND/OR PRODUCED. PLANS  
 AND DRAWINGS ARE NOT TO BE  
 REPRODUCED IN ANY FORM OR MANNER  
 WITHOUT THE EXPRESS WRITTEN  
 CONSENT OF ACP.