



CG  
drawn by

MA  
checked by

NOVEMBER 2025  
date

revisions

\_\_\_\_\_  
\_\_\_\_\_  
\_\_\_\_\_



OLD SCHOOL  
REPLACEMENT

sheet no:

**AD100**

DEMOLITION PLAN

OWNERSHIP USE OF DOCUMENTS:

AGP EXPRESSLY RESERVES ITS  
COPYRIGHT AND OTHER PROPERTY  
RIGHTS OF ALL PLANS AND DRAWINGS  
DESIGNED AND/OR PRODUCED. PLANS  
AND DRAWINGS ARE NOT TO BE  
REPRODUCED IN ANY FORM OR MANNER  
WITHOUT THE EXPRESSED WRITTEN  
CONSENT OF AGP.

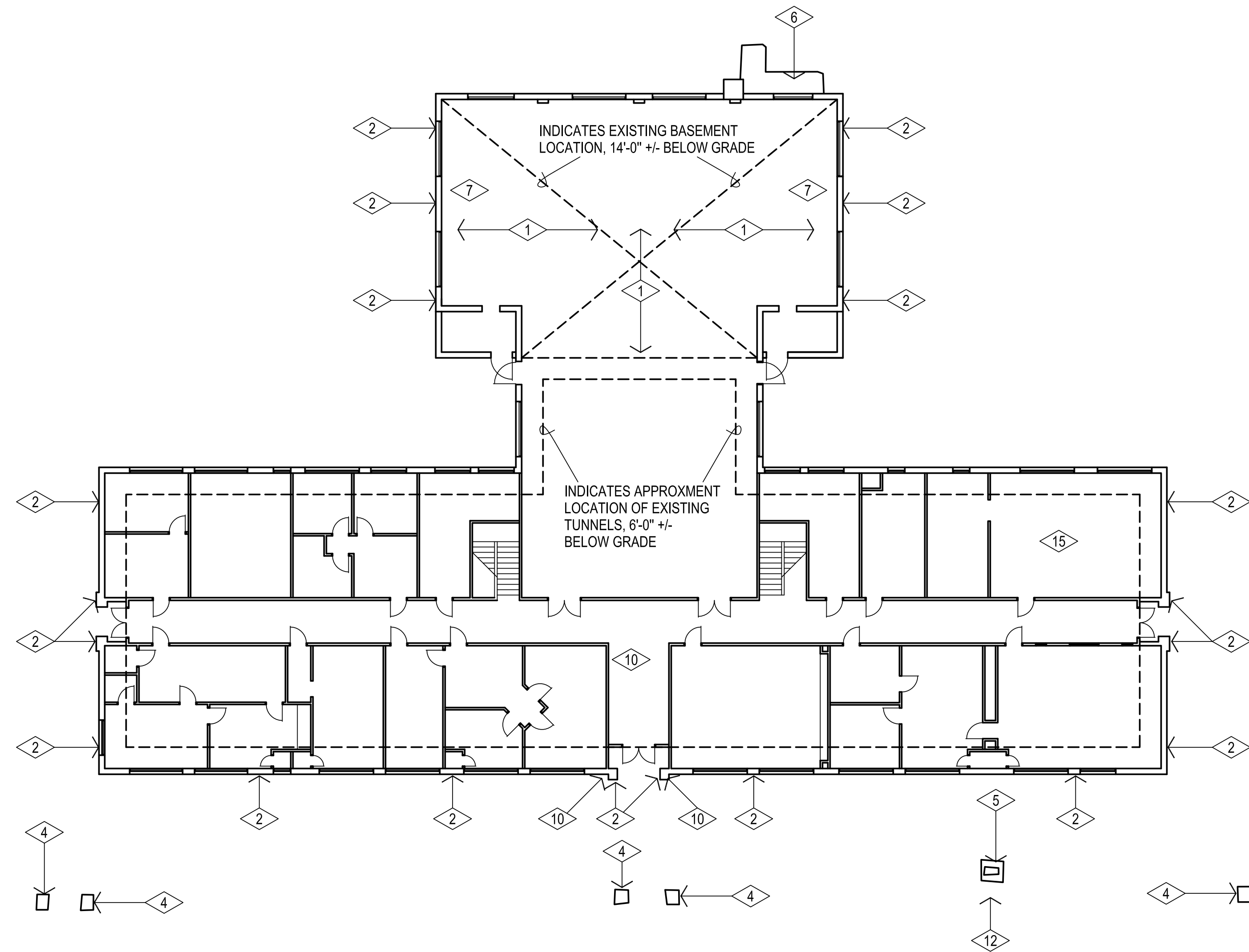

**1** EXISTING DEMOLITION FIRST FLOOR  
1/16" = 1'-0"

**2** EXISTING DEMOLITION SECOND FLOOR  
1/16" = 1'-0"

GENERAL NOTES:

- FILL GRADE, & PREPARE ALL EXCAVATED AREAS TO RECEIVE NEW SITE FEATURES.
- CONTRACTOR TO VISIT SITE PRIOR TO PREPARING BID, & VERIFY ALL ITEMS TO BE DEMOLISHED. ANY ADDITIONAL ITEMS REQUIRING DEMOLITION THAT ARE NOT INCLUDED IN THESE DOCUMENTS SHOULD BE BROUGHT TO THE IMMEDIATE ATTENTION OF THE ARCHITECT AND INCLUDED IN THE BASE BID.
- EXISTING UNDERGROUND UTILITY LOCATIONS & CONTOUR INFORMATION HAVE BEEN OBTAINED FROM THE BEST AVAILABLE SOURCES. THE CONTRACTOR SHALL FIELD VERIFY ALL EXISTING CONDITIONS PRIOR TO COMMENCING WORK & COORDINATE W/ ARCHITECT.
- CONTRACTOR IS TO FIELD VERIFY ALL EXISTING ELEVATIONS PRIOR TO STARTING EARTHWORK - AND ADJUST ACCORDINGLY AS DIRECTED BY THE ARCHITECT.
- DURING ALL EXISTING UTILITY REVISIONS - TEMPORARY SERVICE IS TO BE PROVIDED @ ALL EFFECTED BUILDINGS.
- ALL SALVAGEABLE ITEMS TO REMAIN OWNER'S PROPERTY & SHALL BE STORED OR DISPOSED OF AS PER OWNER'S INSTRUCTIONS.
- CONSTRUCTION SHALL MEET ALL APPLICABLE CODES, ORDINANCES, REGULATIONS & STANDARDS REQUIRED BY THE CITY OF MOORE, OKLAHOMA.
- CONSTRUCTION SHALL MEET ALL APPLICABLE REQUIREMENTS OF THE AMERICANS W/ DISABILITIES ACT INCLUDING ANY SUPPLEMENTAL REQUIREMENTS BY THE CITY OF MOORE, OKLAHOMA.
- CONTRACTOR SHALL COORDINATE ACCESS TO SITE W/ OWNER PRIOR TO STARTING WORK. OBTAIN APPROVAL FROM OWNER FOR ON-SITE MATERIAL STORAGE, ETC. CONTRACTOR SHALL PROVIDE PROPER SEPARATION BTWN. WORK & STUDENTS.

( RE: CIVIL SHEETS FOR ADDITIONAL DEMOLITION INFORMATION )

DEMOLITION NOTES:

- EXISTING WOOD FLOORING TO BE CAREFULLY REMOVED / RECLAIMED FOR USE IN NEW BUILDING. CONTRACTOR TO PROTECT AND STORE MATERIAL. COORDINATE WITH ARCHITECT PRIOR TO COMMENCING WORK.
- EXISTING CAST STONE AT EXTERIOR WALL TO BE CAREFULLY REMOVED / RECLAIMED AND STORED FOR USE AT NEW BUILDING. REFER SHEET AD101. COORDINATE WITH ARCHITECT PRIOR TO COMMENCING WORK.
- EXISTING LOCKERS TO BE CAREFULLY REMOVED / RECLAIMED FOR USE AT NEW BUILDING. COORDINATE WITH ARCHITECT PRIOR TO COMMENCING WORK.
- EXISTING BRICK COLUMNS WITH CAST STONE CAP & PLAQUES TO BE CAREFULLY REMOVED / RECLAIMED AND STORED FOR USE AT NEW BUILDING SITE. COORDINATE WITH ARCHITECT PRIOR TO COMMENCING WORK.
- EXISTING STONE MONUMENT & PLAQUE TO BE REMOVED AND RELOCATED AT NEW LOCATION ON EXISTING SITE. COORDINATE WITH ARCHITECT PRIOR TO COMMENCING WORK.
- EXISTING CONC. STAIRS, FOOTINGS, RAILING, ETC. TO BE DEMOLISHED. EXTREME CARE IS TO BETAKEN TO PROTECT EXISTING GYMNASIUM WALLS, FOUNDATION, ETC. DURING DEMOLITION OF OLD SCHOOL BUILDING ESPECIALLY AT FOUNDATION, RETAINING WALLS AT BASEMENT ACCESS BELOW GRADE. COORDINATE ANY ISSUES THAT ARISE WITH ARCHITECT PRIOR TO PERFORMING WORK.
- EXISTING BASKETBALL BACKBOARD AND ASSOCIATED FRAME TO BE CAREFULLY REMOVED AND STORED FOR USE AT THE NEW BUILDING. COORDINATE WITH ARCHITECT PRIOR TO COMMENCING WORK.
- EXISTING TOP OF MASONRY CAST STONE TO BE CAREFULLY REMOVED / RECLAIMED AND STORED FOR USE AT NEW BUILDING. REFER SHEET AD101. COORDINATE WITH ARCHITECT PRIOR TO COMMENCING WORK.
- EXISTING BRICK VENEER TO BE CAREFULLY REMOVED / RECLAIMED FOR USE IN NEW BUILDING. 5,000 SQ. FT. MINIMUM OF UNDAMAGED, CLEAN, ETC VENEER IS REQUIRED FOR USE IN NEW BUILDING. CONTRACTOR TO PROTECT AND STORE MATERIAL. EXISTING VENEER TO BE RECLAIMED MUST BE REMOVED FROM A MINIMUM OF 10 LOCATIONS (APPROX. 500 SQ. FT EA.) OF THE ENTIRE EXISTING BUILDING COORDINATE WITH ARCHITECT PRIOR TO COMMENCING WORK.
- EXISTING EXTERIOR BUILDING SIGN INTERIOR / EXTERIOR / PLAQUES TO BE CAREFULLY REMOVED / RECLAIMED FOR USE AT NEW BUILDING. COORDINATE WITH ARCHITECT PRIOR TO COMMENCING WORK.
- EXISTING " 19 MOORE 28 " CAST STONE SIGN TO BE CAREFULLY REMOVED / RECLAIMED FOR USE AT NEW BUILDING. COORDINATE WITH ARCHITECT PRIOR TO COMMENCING WORK.
- EXISTING TIME CAPSULE TO BE CAREFULLY REMOVED / RECLAIMED FOR USE AT NEW BUILDING. COORDINATE WITH ARCHITECT PRIOR TO COMMENCING WORK.
- EXISTING STEEL BEAMS AT AUDITORIUM AND BALCONY SHALL BE CAREFULLY REMOVED / RECLAIMED FOR USE AT NEW BUILDING. COORDINATE WITH ARCHITECT PRIOR TO COMMENCING WORK.
- EXISTING STEEL STAIRS, RAILINGS, SUPPORTS BEAMS & COLUMNS AND ASSOCIATED FOOTING, LANDING, ETC. TO BE DEMOLISHED.
- AFTER REMOVAL OF ALL SALVAGED MATERIALS, THE EXISTING 2 STORY BUILDING PLUS BASEMENT SHALL BE DEMOLISHED COMPLETELY & ALL MATERIALS ( EXCEPT THOSE AS NOTED OTHERWISE ) SHALL BE REMOVED FROM THE SITE / PROPERTY & DISPOSED OF AS NOTED IN THE SPECIFICATIONS.