

ABBREVIATIONS

ABV	ABOVE	HDWD	HARDWOOD
ACUST	ACOUSTICAL	HDWR	HARDWARE
ADJ	ADJUSTABLE	HOHZ	HORIZONTAL
ANCH	ANCHOR	HT	HEIGHT
APPROX	APPROXIMATE	INSUL	INSULATION
BD	BOARD	JST	JOIST
BLKG	BLOCKING	JT	JOINT
BM	BEAM	LAV	LAVATORY
BOT	BOTTOM	MATL	MATERIAL
Q	CENTERLINE	MAX	MAXIMUM
CLG	CEILING	MECH	MECHANICAL
CONC	CONCRETE	MFG	MANUFACTURING
CMU	CONCRETE MASONRY UNIT	MFR	MANUFACTURER
COL	COLUIMN	MNI	MINIMUM
CONT	CONTINUOUS	MISC	MISCELLANEOUS
D.F.	DRINKING FOUNTAIN	MTL	METAL
DM	DIMENSION	N.I.C.	NOT IN CONTRACT
DR	DOOR	NO./#	NUMBER
DWG	DRAWING	N.T.S.	NOT TO SCALE
OPNG	OPENING	O.C.	ON CENTER
DOVEL	DOVEL	OPNG	OPENING
EACH	EACH	OPP	OPPOSITE
ELECT	ELECTRICAL	PP	POWER POLE
ELEV	ELEVATION	PREFN	PREFINISHED
EQ	EQUAL	P.T.	PAPER TOWEL
E.I.	EXPANSION JOINT	P.W./P.Y. WD	PLYWOOD
E.W.	EACH WAY	RE	REFER
EXIST	EXISTING	REOD	REQUIRED
EXP	EXPANSION	RM	ROOM
EXT	EXTERIOR	S.B.	SPLASH BLOCK
FD	FLOOR DRAIN	SCHED	SCHEDULE
FE	FIRE EXTINGUISHER	STD	STANDARD
FEC	FIRE EXTINGUISHER CABINET	STL	STEEL
FL	FINISH FLOOR LINE	S.J.	SAWJOINT
FRM	FRAMING	T.C.	TOP OF CURB
GA	GALVANIZED	T.P.H.	TOILET PAPER HOLDER
G.B.	GRAB BAR	TYP	TYPICAL
GALV	GALVANIZED	U.N.O.	UNLESS NOTED OTHERWISE
GYP	GYP BOARD	VTR	VENT THROUGH ROOF
H.C.	HANDICAP	W	WITH
		WC	WATERCLOSET
		WD	WOOD
		WVF	WELDED WIRE FABRIC

MATERIALS LEGEND

FOR PLANS AND DETAILS

	MASONRY VENEER
	C.M.U.
	CONCRETE
	FRAME PARTITION, METAL STUDS
	GYP/SM BOARD
	PARTICLE BOARD
	RIGID INSULATION
	WOOD BLOCKING / FRAMING, CONTINUOUS
	WOOD BLOCKING, DISCONTINUOUS
	FINISH WOOD
	SMALL SCALE STRUCTURAL STEEL / MISCELLANEOUS METAL
	LARGE SCALE STRUCTURAL STEEL
	BATT INSULATION
	ACOUSTICAL CEILING TILE
	EARTH FILL

SYMBOLS LEGEND

	EXISTING SPOT ELEVATION
	FINISH SPOT ELEVATION
	EXISTING GRADE CONTOUR
	FINISH GRADE CONTOUR
	EXISTING TREE TO BE PROTECTED
	EXISTING TREE TO BE REMOVED
	PROJECT LIMITS
	CHAINLINK FENCE
	BARBED WIRE FENCE
	CONCRETE PAVING
	ASPHALT PAVING
	CONCRETE SIDEWALK
	EXISTING PAVING/SIDEWALK TO REMAIN
	EXISTING PAVING TO BE REMOVED
	NEW BUILDING
	EXISTING BUILDING - NO WORK
	ROOM NUMBER
	ROOM NUMBER/LARGE SCALE PLAN REFERENCE
	ROOM NUMBER/INTERIOR ELEVATION REFERENCE
	247 WALL SECTION/DETAIL CUT MARK
	145 LARGE SCALE DETAIL MARK
	145 STRUCTURAL GRID COORDINATES
	144 BUILDING SECTION CUT MARK
	6 DOOR NUMBER
	6 WINDOW MARK
	6 FRAME MARK
	62 GLAZING MATERIAL MARK
	4 EQUIPMENT MARK
	418 EXTERIOR ELEVATION MARK
	#4 TEST HOLE
	11'2 ELEV. BENCH MARK/BUILDING ELEVATION (SECTION)

GENERAL NOTES:

- ALL REQUIRED HANDICAP ACCESSIBLE ITEMS TO COMPLY WITH AMERICANS WITH DISABILITIES ACT AND ARCHITECTURAL BARRIERS ACT ACCESSIBILITY GUIDELINES.
- THE CONTRACTOR SHALL NOT USE ANY LEAD-BASED PAINT OR ASBESTOS CONTAINING MATERIAL ON THIS PROJECT.
- THESE CONTRACT DOCUMENTS INCLUDING BUT NOT LIMITED TO THE DRAWINGS, PROJECT MANUAL, AND ANY SUBSEQUENT ADDENDA ARE ISSUED AS A "WHOLE" AND SHALL BE BID AS SUCH. EACH DISCIPLINE / SUBCONTRACTOR SHALL REVIEW THE ENTIRE SET OF CONTRACT DOCUMENTS AND INCLUDE APPLICABLE WORK IN THEIR BID REGARDLESS OF LOCATION WITHIN THE CONTRACT DOCUMENTS. REVIEWING ONLY PORTION OF THE CONTRACT DOCUMENTS SHALL NOT ABSOLVE THE CONTRACTOR OR SUBCONTRACTOR OF THE REQUIREMENT TO PERFORM THE WORK OR THEIR RESPECTIVE DISCIPLINES.
- LOCATIONS OF EXISTING BUILDINGS, SITE FEATURES, & UNDERGROUND UTILITIES HAVE BEEN OBTAINED FROM EXISTING AVAILABLE SOURCES. THE CONTRACTOR IS TO FIELD VERIFY EXISTING LOCATIONS PRIOR TO STARTING CONSTRUCTION AND NOTIFY THE ARCHITECT IMMEDIATELY IF ANY EXISTING BUILDING OR SITE FEATURE CONFLICTS WITH THE NEW CONSTRUCTION.
- THE CONTRACTOR SHALL VERIFY ALL EXISTING SITE UTILITIES AND PROTECT DURING CONSTRUCTION. COORDINATE NEW UTILITY REQUIREMENTS WITH APPLICABLE UTILITY COMPANIES (WATER, GAS, ELECTRICITY, SANITARY SEWER, TELEPHONE, CABLE, SITE DAMAGE AND OTHERS AS REQUIRED). COMPLY WITH ALL APPLICABLE REGULATIONS. INCLUDE ALL CONNECTION FEES AND OTHER CHARGES IN BID.
- REFER TO CIVIL, MECHANICAL, AND ELECTRICAL DRAWINGS FOR UTILITY INFORMATION.
- REFER TO CIVIL, MECHANICAL, AND ELECTRICAL DRAWINGS FOR ADDITIONAL REQUIREMENTS AND CONCRETE TO BE PROVIDED BY CONTRACTOR.
- GENERAL CONTRACTOR TO VERIFY LOCATIONS OF EASEMENTS, ENCUMBRANCES AND SET BACKS PRIOR TO STARTING CONSTRUCTION.
- CONFLICTS BETWEEN DRAWINGS AND SPECIFICATIONS SHALL BE BROUGHT TO ARCHITECT'S ATTENTION. FAILURE TO BID ITEMS NOTED ON DRAWINGS AND OMITTED FROM SPECIFICATIONS DOES NOT REMOVE RESPONSIBILITY TO PROVIDE AND INSTALL SUCH.

GENERAL NOTES (CONT):

- CONSTRUCTION STAGING AREA & VEHICLE ACCESS SHALL BE CONFIRMED WITH OWNER, AND CONSTRUCTION MANAGER IF APPLICABLE. PRIOR TO CONSTRUCTION, FINISH GRADE AT BUILDING PERIMETERS SHALL BE 6" BELOW FINISH FLOOR UNLESS SPECIFICALLY NOTED OTHERWISE ON CIVIL DRAWINGS. DEVELOP POSITIVE DRAINAGE AWAY FROM NEW AND/OR EXISTING BUILDINGS).
- ALL GRID LINES IDENTIFIED BY A LETTER OR NUMBER ARE PARALLEL UNLESS OTHERWISE NOTED.
- SIZES OF HOUSEKEEPING PADS AND BASIS FOR MECHANICAL EQUIPMENT ARE APPROXIMATE. CONTRACTOR SHALL VERIFY EXACT LOCATION AND REQUIRED SIZE OF ALL CONCRETE PADS AND BASIS WITH EQUIPMENT MANUFACTURERS BEFORE POURING. ALL PADS (& ASSOCIATED BOLLARDS @ EXTERIOR LOCATIONS) TO BE PROVIDED BY THE CONTRACTOR.
- CONTRACTOR SHALL COORDINATE THE INSTALLATION OF THE VARIOUS TRADE ITEMS WITHIN THE SPACE ABOVE THE CEILING (INCLUDING, BUT NOT LIMITED TO STRUCTURAL MEMBERS AND SPRAY ON INSULATION OR FIREPROOFING, MECHANICAL DUCTS AND BATT INSULATION, CONDITTS, RACEWAY, SPRINKLER SYSTEMS, LIGHT FIXTURES, CEILING SYSTEMS, AND ANY SPECIAL STRUCTURAL SUPPORTS REQUIRED) AND SHALL BE RESPONSIBLE FOR MAINTAINING THE FINISH CEILING HEIGHT ABOVE THE FINISH FLOOR INDICATED IN THE DRAWINGS AND FINISH SCHEDULE.
- ALL METAL STUDS WALLS WHERE PLUMBING OCCURS OR STRUCTURAL COLUMNS ARE LOCATED SHALL BE MINIMUM 6" METAL STUDS. NOTIFY ARCHITECT OF ANY DISCREPANCIES OR CONFLICTS.
- PROVIDE AND INSTALL ACCESS PANELS, WHERE REQUIRED BY BUILDING CODE OR FOR THE PROPER OPERATION OF MECHANICAL OR ELECTRICAL EQUIPMENT, AND AS SHOWN ON THE DRAWINGS. CONTRACTOR SHALL COORDINATE SIZE, LOCATION, AND TYPE OF ACCESS PANEL WITH OTHER CONTRACTORS' WORK AND RECEIVE APPROVAL OF THE ARCHITECT. ACCESS PANEL SHALL BE AS SPECIFIED.
- 3/4" FIRE-RETARDANT TREATED PLYWOOD BACKING 8'-0" HIGH SHALL BE PROVIDED AND INSTALLED ON ALL WALLS OF TELEPHONE AND ELECTRICAL ROOMS UNLESS SPECIFICALLY SHOWN OTHERWISE ON ELECTRICAL DRAWINGS.
- ALL WOOD WITHIN THIS PROJECT (IE. PLYWOOD, BLOCKING, ETC.) SHALL BE FIRE-RETARDANT TREATED.
- FOR ILLUSTRATION AND DEFINITION OF TYPICAL SYMBOLS USED ON THE ARCHITECTURAL DRAWINGS, SEE 'SYMBOLS AND ABBREVIATIONS' SHEET. ADDITIONAL SYMBOLS NOT SHOWN OR DEFINED THERE MAY OCCUR AND ARE DEFINED ON OTHER DRAWINGS.
- REFER TO SPECIFICATIONS FOR ADDITIONAL PAINT ITEMS NOT SHOWN ON ROOM FINISH SCHEDULE.
- THE SPECIFICATIONS AND ALL CONSULTANT DRAWINGS ARE SUPPLEMENTAL TO THE ARCHITECTURAL DRAWINGS. IT SHALL BE THE CONTRACTOR'S RESPONSIBILITY TO COORDINATE WITH THE ARCHITECTURAL DRAWINGS BEFORE THE INSTALLATION OF ANY OF THE CONSULTANTS' WORK AND TO BRING ANY DISCREPANCIES OR CONFLICTS TO THE ARCHITECT'S ATTENTION FOR CLARIFICATION. IMPROPERLY INSTALLED WORK SHALL BE CORRECTED BY THE CONTRACTOR AT NO EXPENSE TO THE ARCHITECT, HIS CONSULTANTS, OR THE OWNER.
- THE ARCHITECTURAL DRAWINGS ARE A PART OF A LARGER SET OF DRAWINGS WHICH, WHEN COMPLETE, CONSISTS OF ALL DRAWINGS LISTED BY THE INDEX OF DRAWINGS. THE WORK DESCRIBED BY THE DRAWINGS OF ANY ONE DISCIPLINE MAY BE AFFECTED BY THE WORK DESCRIBED ON DRAWINGS OF ANOTHER DISCIPLINE AND MAY REQUIRE REFERENCE TO DRAWINGS OF ANOTHER DISCIPLINE. PARTIAL SETS OF DRAWINGS SHALL NOT BE DISTRIBUTED AND UTILIZED BY THE CONTRACTOR. IT IS THE CONTRACTOR'S RESPONSIBILITY TO REVIEW AND COORDINATE THE WORK OF ALL SUBCONTRACTORS, TRADES, AND SUPPLIERS WITH THE REQUIREMENTS OF THE CONTRACT BEFORE COMMENCING CONSTRUCTION AND TO ASSURE THAT ALL PARTIES ARE AWARE OF ALL REQUIREMENTS, REGARDLESS OF WHERE THE REQUIREMENTS OCCUR IN THE CONTRACT DOCUMENTS.
- THE ARCHITECTURAL DRAWINGS ESTABLISH AND COORDINATE THE FINISHED APPEARANCE AND EXACT LOCATIONS OF ALL EXPOSED ELEMENTS OF THE WORK, INCLUDING THAT WORK WHICH IS ILLUSTRATED PRIMARILY ON DRAWINGS OF OTHER DISCIPLINES. LOCATIONS SHOWN ON OTHER DRAWINGS ARE SCHEMATIC. UNLESS OTHERWISE NOTED ON THE ARCHITECTURAL DRAWINGS, THE ARCHITECTURAL DRAWINGS TAKE PRECEDENCE FOR THE FINISHED APPEARANCE AND EXACT LOCATION OF ALL PARTS OF THE WORK. EXCEPTIONS: DIMENSIONED LOCATIONS SHOWN ON DRAWINGS OF OTHER DISCIPLINES SHALL GOVERN ONLY WHEN: (A) SPECIFICALLY AND INDIVIDUALLY INDICATED BY SYMBOL, KENED NOTE, OR NOTATION ON THE ARCHITECTURAL DRAWINGS, (B) OCCURRING WITHIN A ROOM OR OTHER IDENTIFIED SPACE FOR WHICH ARCHITECTURAL SHEET OR SCHEDULE NOTES INDICATE THAT DIMENSIONS PROVIDED ELSEWHERE SHALL GOVERN, (C) OCCURRING WITHIN A ROOM OR OTHER IDENTIFIED SPACE FOR AND OTHER PLACES SHALL BE CONSTRUCTED SIMILARLY.
- PROVIDE FIRE EXTINGUISHERS WITH A RATING OF NOT LESS THAN 2A WITHIN 75 FOOT TRAVEL DISTANCE TO ALL PORTIONS OF THE BUILDING. PROVIDE PORTABLE FIRE EXTINGUISHERS AS THE BUILDING IS CONSTRUCTED.
- FOR THIS PROJECT, THE TERM "CONTRACTOR" SHALL BE UNDERSTOOD TO REFER TO THE "CONSTRUCTION MANAGER /MANAGEMENT COMPANY"
- CONTRACTOR SHALL COORDINATE SCHEDULE ALL CONSTRUCTION WITH THE OWNERS REQUIREMENTS FOR ALL SPORTS TO REMAIN ACTIVE DURING CONSTRUCTION.

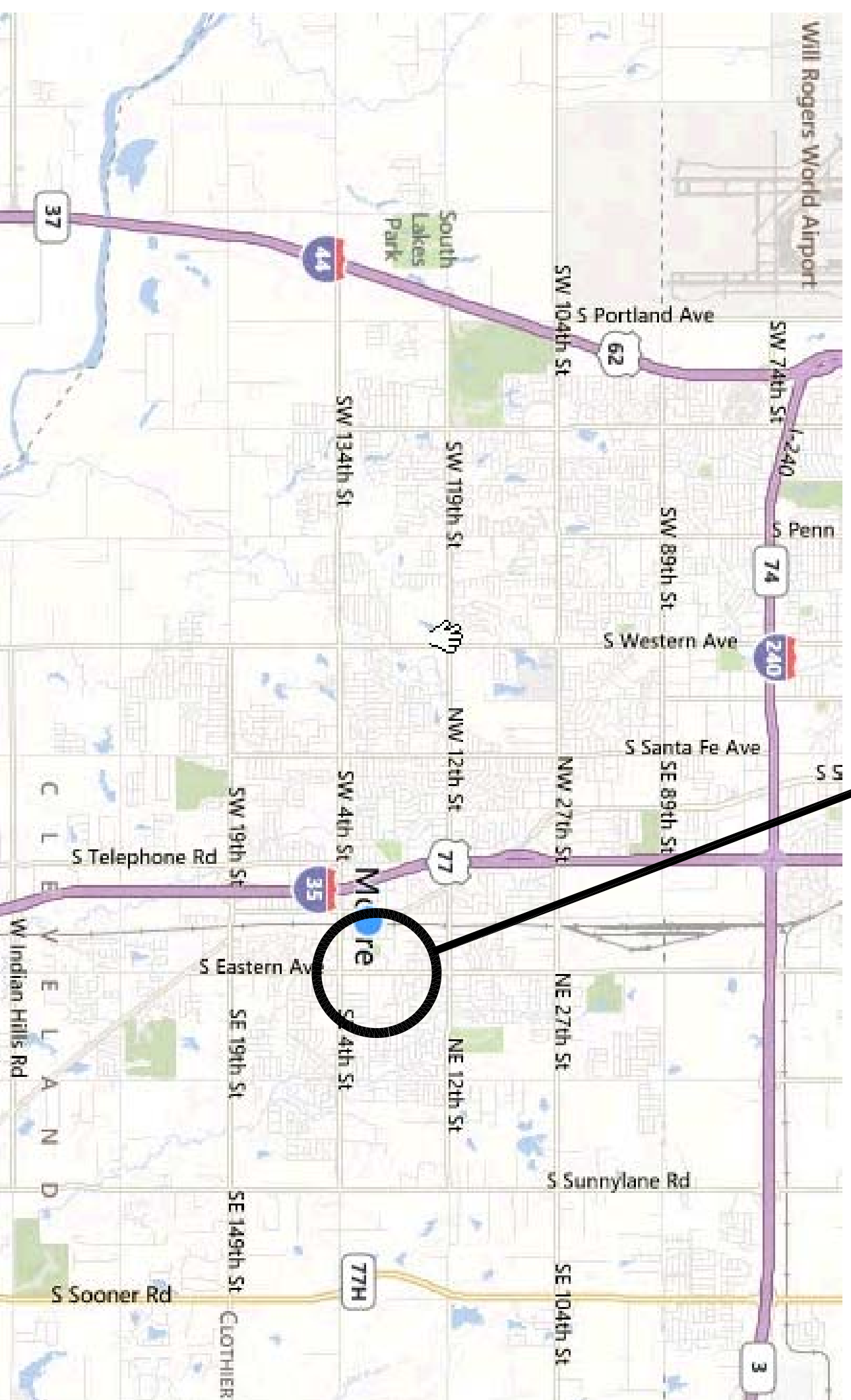

VICINITY MAP

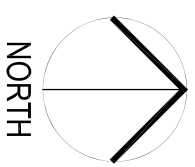

MOORE PUBLIC SCHOOLS
CHILD CARE CENTER
201 N. EASTERN AVE.
MOORE, OKLAHOMA 73160

OWNERSHIP USE OF DOCUMENTS:
AGP EXPRESSLY RESERVES ITS
COPYRIGHT AND OTHER PROPERTY
RIGHTS OF ALL PLANS AND DRAWINGS
DESIGNED AND/OR PRODUCED. PLANS
AND DRAWINGS ARE NOT TO BE
REPRODUCED IN ANY FORM OR MANNER
WITHOUT THE EXPRESSED WRITTEN
CONSENT OF AGP.

G100

Sheet No.:

CHILD CARE FACILITY
201 N. EASTERN AVE.

MOORE
PUBLIC SCHOOLS



DC	drawn by	
MA	checked by	
	date	OCTOBER 2024
revisions		

10/22/24

CEDAR CREEK
CIVIL
KFC ENGINEERING
STRUCTURAL
SALAS O'BRIEN
MECHANICAL/ELECTRICAL