

GENERAL NOTES

- 1. COORDINATE WORKS WITH ALL TRADES.
- 2. MAINTAIN A MINIMUM OF 10'-0" HORIZONTAL CLEARANCE BETWEEN ALL EXHAUST AIR OUTLETS AND ANY FRESH AIR INTAKES.

AGP

the Abila Griffin
Partnership L.L.C.

201 N. BROADWAY
SUITE 210
MOORE, OK. 73160
405.735.3477
AGP@theAGP.net
www.theAGP.net

WDB ENGINEERING
CIVIL

SALAS O'BRIEN
MECHANICAL / ELECTRICAL



KF

drawn by

DMG

checked by

MAY 2023

date

revisions

MOORE PUBLIC SCHOOLS
BOARD OF EDUCATION
MOORE, OKLAHOMA



LOCKER ROOM
ADDITION
MOORE WEST
JUNIOR HIGH SCHOOL

sheet no:

M102

OWNERSHIP USE OF DOCUMENTS:



2600 Van Buren St., Suite 2635
Norman, OK 73072
Salas O'Brien Registration: CA# 7058
Expiration Date: 6/30/2025
Salas O'Brien Project Number: 2023-04636-00

AGP EXPRESSLY RESERVES ITS
COPYRIGHT AND OTHER PROPERTY
RIGHTS OF ALL PLANS AND DRAWINGS
DESIGNED AND/OR PRODUCED. PLANS
AND DRAWINGS ARE NOT TO BE
REPRODUCED IN ANY FORM OR MANNER
WITHOUT THE EXPRESSED WRITTEN
CONSENT OF AGP.

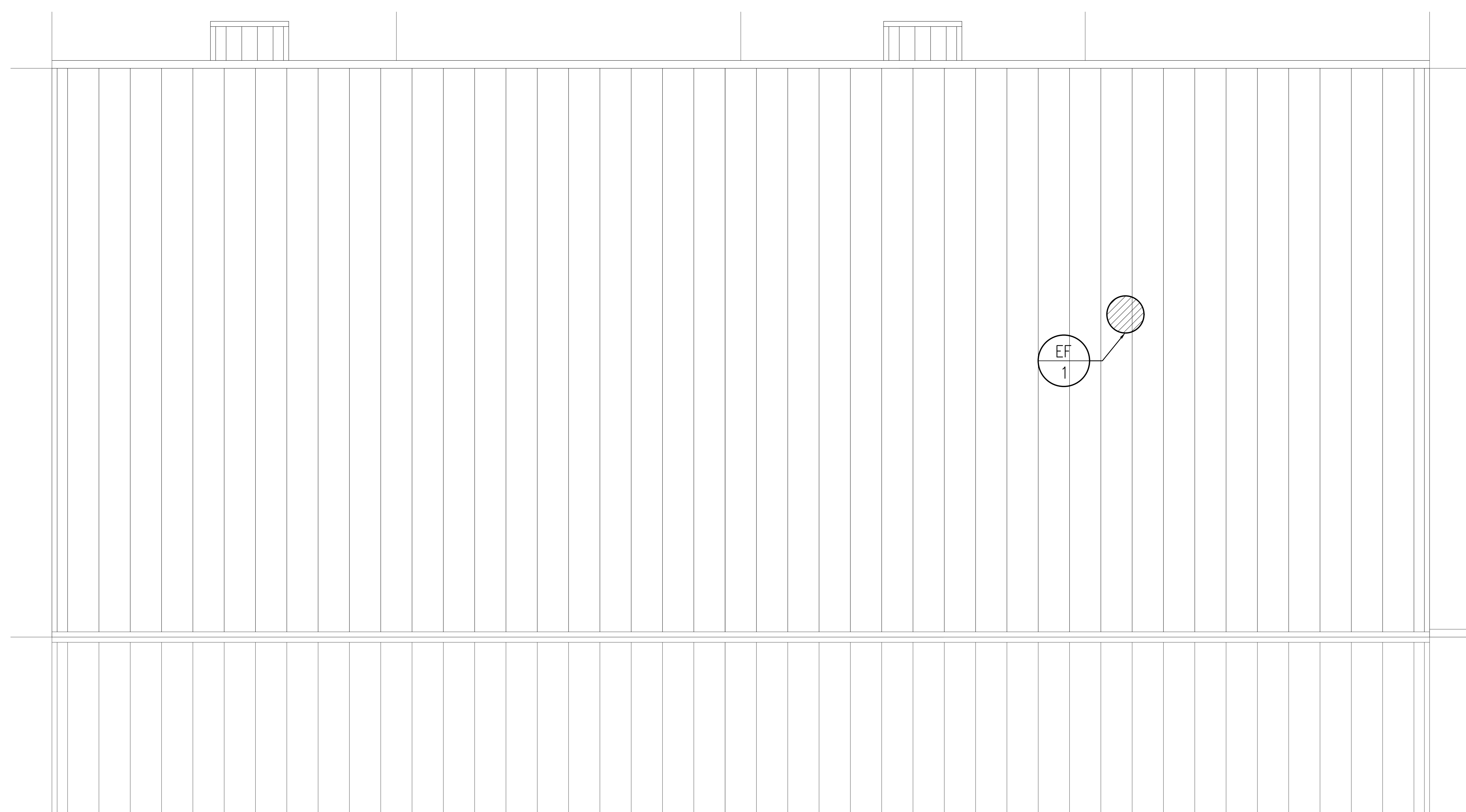

1 MECHANICAL ROOF PLAN

SCALE: 1/16" = 1'-0"



NORTH