



CG
drawn by
MA
checked by
MAY 2023
date
revisions

MOORE PUBLIC SCHOOLS
BOARD OF EDUCATION
MOORE, OKLAHOMA



LOCKER ROOM
ADDITION
MOORE WEST
JUNIOR HIGH SCHOOL

sheet no:

C700

OWNERSHIP USE OF DOCUMENTS:
AGP EXPRESSLY RESERVES ITS
COPYRIGHT AND OTHER PROPERTY
RIGHTS OF ALL PLANS AND DRAWINGS
DESIGNED AND/OR PRODUCED. PLANS
AND DRAWINGS ARE NOT TO BE
REPRODUCED IN ANY FORM OR MANNER
WITHOUT THE EXPRESSED WRITTEN
CONSENT OF AGP.

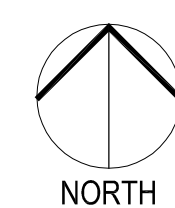
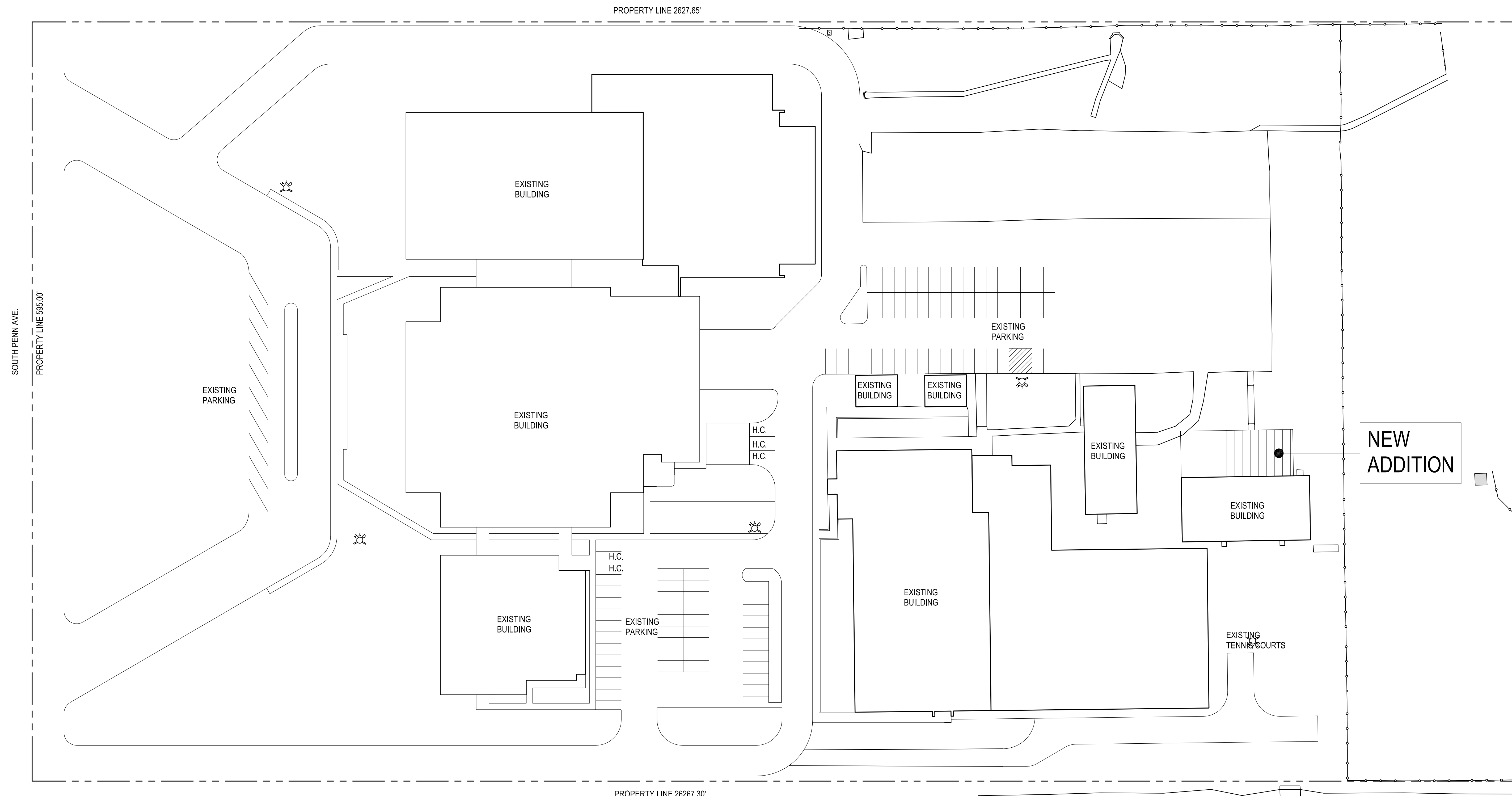

1

EXISTING PARKING
1" = 40'-0"

PARKING CALCULATIONS :
EXISTING PARKING SPACES 110 INCL. 5 H.C.
TOTAL BUILDING (NEW + EXIST.)
772 CLASSROOM SEATS + ADMINISTRATION / 10 = 78 TOTAL SPACES INCL. 5 H.C. REQUIRED