

MOB ENGINEERING

CIVIL

KFC ENGINEERING

STRUCTURAL

SALAS ORRIN

MECHANICAL/ELECTRICAL



4/25/22

CC
drawn by
MA

checked by

MARCH 2022

date

revisions

MOORE PUBLIC SCHOOLS
BOARD OF EDUCATION
MOORE, OKLAHOMA



CLASSROOM ADDITION
MOORE WEST
JUNIOR HIGH SCHOOL

Sheet no.

A109

OWNERSHIP USE OF DOCUMENTS:

AGP EXPRESSLY RESERVES ITS
COPYRIGHT AND OTHER PROPERTY
RIGHTS OF ALL PLANS AND DRAWINGS
DESIGNED AND/OR PRODUCED BY
AGP AND/OR ANY OF ITS AFFILIATES
REPRODUCED IN ANY FORM OR MANNER
WITHOUT THE EXPRESSED WRITTEN
CONSENT OF AGP.

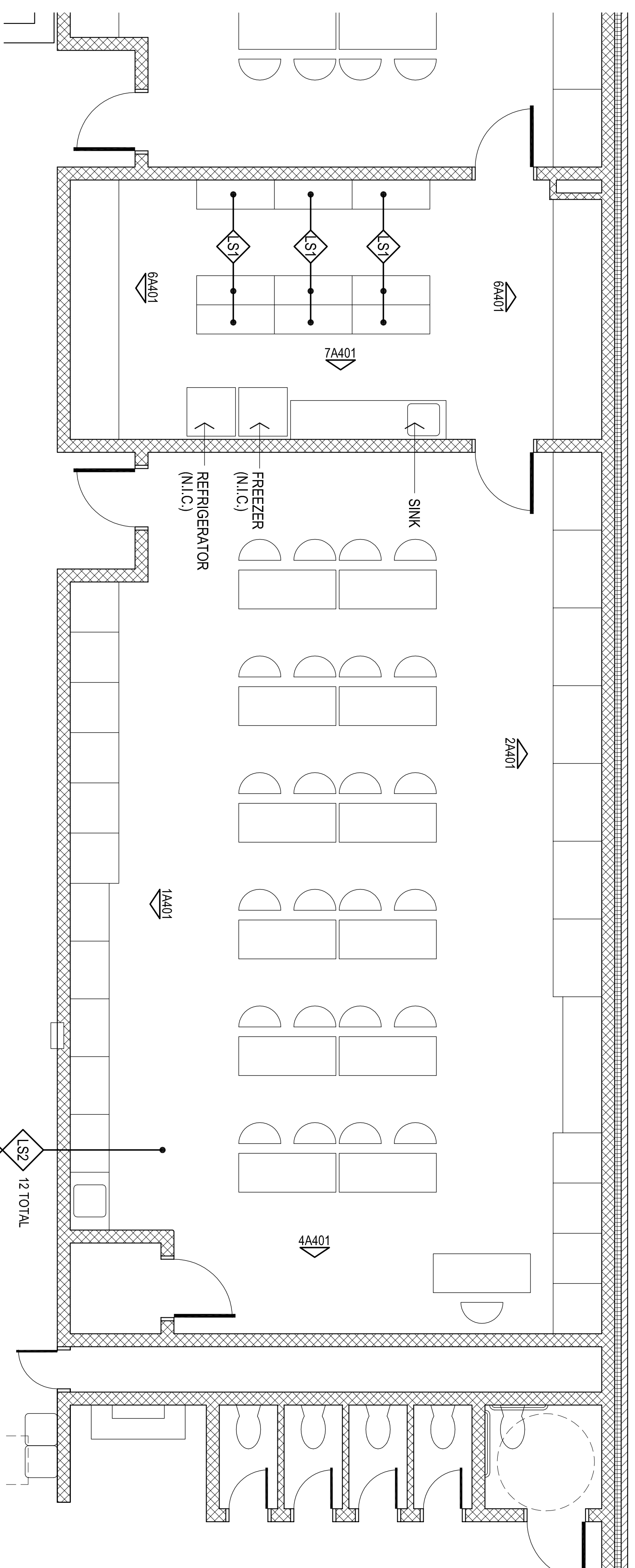

1 ENLARGED FLOOR PLAN - TYPICAL LAB EQUIPMENT & STORAGE ROOM

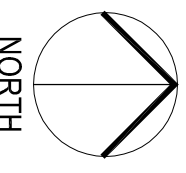

1/4" = 1'-0"

ITEM NO.	EQ	QTY	DESCRIPTION	MANUFACTURER		COLOR	REMARKS
				NAME	MODEL NO.		
LS1	●	●	LAB CABINETS	KEWANEE	S20W841648-5014	RE: SPECS	BY OTHERS
LS2	●	●	LAB TABLE			RE: SPECS	BY OTHERS
LS3	●	●	STOOL			RE: SPECS	BY OTHERS
LS4	●	●	TEACHER'S CHAIR			RE: SPECS	BY OTHERS
LS5	●	●	TEACHER'S DESK			RE: SPECS	BY OTHERS

2 LAB EQUIPMENT SCHEDULE - LAB & STORAGE ROOMS

PROVIDED FOR INFORMATION ONLY

