

FIRE PROTECTION ABBREVIATIONS			
AG	ABOVE GRADE	FT	FOOT (FEET)
ADD	ADDENDUM	GAL	GALLON
ADDL	ADDITIONAL	GC	GENERAL CONTRACTOR
ADJ	ADJUSTABLE	GPM	GALLONS PER MINUTE
AFF	ABOVE FINISH FLOOR	MC	MECHANICAL CONTRACTOR
AFG	ABOVE FINISH GRADE	MECH	MECHANICAL
ALT	ALTERNATE	MIN	MINIMUM
BG	BELOW GRADE	NTS	NOT TO SCALE
CI	CAST IRON	PC	PLUMBING CONTRACTOR
COL	COLUMN	PLBG	PLUMBING
CW	COLD WATER	QTY	QUANTITY
DN	DOWN	SCH	SCHEDULE
EC	ELECTRICAL CONTRACTOR	SPEC	SPECIFICATIONS
FD	FLOOR DRAIN	SS	STAINLESS STEEL
FDC	FIRE DEPARTMENT CONNECTION	TEMP	TEMPERATURE
FLR	FLOOR	TYP	TYPICAL
FP	FIRE PROTECTION	W/	WITH

FIRE PROTECTION SYMBOL LEGEND	
	SHUTOFF VALVE
	CHECK VALVE
	DOUBLE CHECK VALVE
	END CAP
	FIRE DEPARTMENT CONNECTION(FDC)
	BELL

FIRE PROTECTION PIPING LINETYPES	
LINETYPE	DESCRIPTION
	NEW - ABOVE GRADE
	NEW - BELOW GRADE

- ### FIRE PROTECTION GENERAL NOTES
- CONTRACTOR SHALL PROVIDE DESIGN FOR SPRINKLER HEAD MODIFICATION AND ADDITION OF HEADS PER REVISED AREAS.
 - COORDINATE INSTALLATION OF SPRINKLER PIPING AND ALL COMPONENTS WITH OTHER TRADES, OWNER, AND GENERAL CONTRACTOR.
 - FIRE PROTECTION SYSTEM TO COMPLY WITH NFPA 13, INSURANCE CARRIER AND ALL APPLICABLE STATE AND LOCAL CODES.
 - CUTTING OF STRUCTURAL AND/OR ARCHITECTURAL MEMBERS TO BE DONE ONLY WITH THE WRITTEN APPROVAL OF THE ARCHITECT AND STRUCTURAL ENGINEER.
 - PROVIDE MINIMUM 10 PSI SAFETY FACTOR.
 - WORKING DRAWINGS INDICATING SPRINKLER HEAD LOCATIONS AND EXPOSED AND CONCEALED PIPING ROUTING SHALL BE PROVIDED TO THE ARCHITECT/ENGINEER PRIOR TO INSTALLATION FOR APPROVAL.
 - FIRE PROTECTION CONTRACTOR IS RESPONSIBLE FOR ORGANIZING A COORDINATION MEETING WITH OTHER TRADES AND OWNER PRIOR TO INSTALLATION.
 - SYSTEM PIPING LOCATION: WET SYSTEM PIPING SHALL BE INSTALLED AT HIGHEST ELEVATION POSSIBLE. PIPING SHALL BE INSTALLED ABOVE ALL MECHANICAL EQUIPMENT, DUCTWORK, AND ALL PLUMBING SYSTEM PIPING. PROVIDE ADEQUATE CLEARANCE TO MECHANICAL UNITS. FIRE PROTECTION CONTRACTOR SHALL COORDINATE FIRE PROTECTION PIPING PRIOR TO INSTALLATION.
 - PROPERLY TORQUE MECHANICAL TEES TO MANUFACTURER'S RECOMMENDATIONS.
 - FIRE PROTECTION PLANS ARE FOR REFERENCE ONLY. OCCUPANCIES AND AREAS OF PROTECTION NOTED ON THE PLANS SHALL BE CONFIRMED WITH NFPA 13 AND AUTHORITIES HAVING JURISDICTION. THIS CONTRACTOR SHALL COMPLY WITH ANY CODE REQUIREMENTS AS REQUIRED.
 - SEMI-RECESSED PENDANT SPRINKLER HEADS SHALL HAVE WHITE FINISH.
 - UPRIGHT SPRINKLER HEADS SHALL BE BRASS. PROVIDE PROTECTIVE GUARD FOR HEAD.
 - FIRE SEAL ALL PENETRATIONS THRU RATED STRUCTURES TO MAINTAIN FIRE RATING.

FIRE PROTECTION SHEET INDEX	
F101	FIRE PROTECTION PLAN

KEYED NOTES	
	COORDINATE EXISTING SPRINKLER HEADS WITH NEW MECHANICAL EQUIPMENT AND ANY NEW LIGHT FIXTURES. EXTEND FIRE SPRINKLER PIPING WHERE REQUIRED FOR NEW SPRINKLER HEAD LOCATIONS.

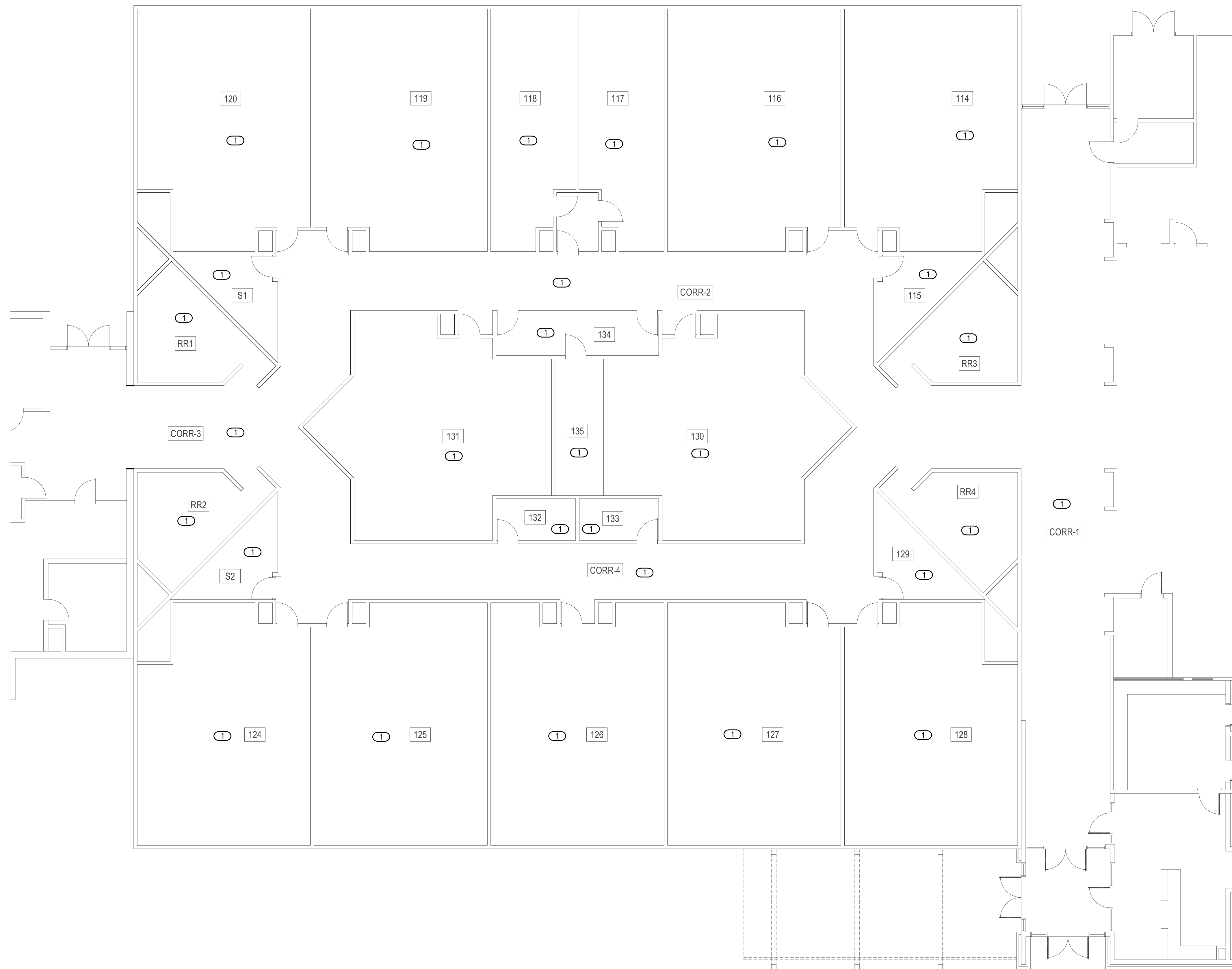

SALAS O'BRIEN
MECHANICAL / ELECTRICAL



KS
drawn by
KP
checked by
AUGUST 2024
date
revisions



HOUCHIN ELEMENTARY
HVAC UPGRADE

sheet no:

F101

1 FIRE PROTECTION PLAN

SCALE: 1/8" = 1'-0"



Salas O'Brien
2900 S. Telephone Road, Suite 120
Moore, OK 73160
Salas O'Brien Registration: CA# 7058
Expiration Date: 6/30/2025
Salas O'Brien Project Number: 2024-03104-00

OWNERSHIP USE OF DOCUMENTS:
AGP EXPRESSLY RESERVES ITS COPYRIGHT AND OTHER PROPERTY RIGHTS OF ALL PLANS AND DRAWINGS DESIGNED AND/OR PRODUCED. PLANS AND DRAWINGS ARE NOT TO BE REPRODUCED IN ANY FORM OR MANNER WITHOUT THE EXPRESSED WRITTEN CONSENT OF AGP.