

GENERAL NOTES:

1. RE: MECH & ELEC. FOR ADDITIONAL DEMOLITION NOTES CONTRACTOR TO COORDINATE ALL ROOF MOUNTED ITEMS & PENETRATIONS W/ APPLICABLE TRADES
2. CONTRACTOR TO COORDINATE ROOF VENT PENETRATIONS W/ ARCHITECT.
3. PROVIDE @ ALL ROOF PENETRATIONS - PENETRATION DAM / SEALER POCKETS AS PER 4A103
4. REMOVE EXISTING AIR HANDLER UNIT AND ASSOCIATED PIPING. EXISTING PIPE SUPPORTS THAT PENETRATE THE ROOFING SYSTEM ARE TO REMAIN. REPAIR / PATCH EXISTING ROOFING SYSTEM AS NEEDED TO PROVIDE WATER TIGHT SYSTEM. RE: MECHANICAL PLANS FOR ADDITIONAL INFORMATION.
5. PREPARE EXISTING ROOF PENETRATIONS & CURB TO RECEIVE NEW PREFINISHED METAL CAP WITH INSULATION. COORDINATE W/ ARCHITECT.
6. PREPARE EXISTING ROOF PENETRATIONS AT EXISTING EXHAUST FAN TO BE RELOCATED. RE: MECHANICAL. PROVIDE METAL CAP WITH INSULATION AT EXISTING CURB TO REMAIN. COORDINATE W/ ARCHITECT.
7. CONTRACTOR TO FIELD VERIFY DIMENSIONS AND PIPE SUPPORTS QUANTITIES.
8. APPROX. AREA OF REROOF WORK. COORDINATE WITH CONTRACTOR. PROVIDE INSULATION (TAPERED WHERE REQUIRED) COVER BOARD AND ROOFING SYSTEM TO MATCH EXISTING. PROVIDE POSITIVE DRAINAGE TO EXISTING ROOF DRAINS / ROOF EDGE.
9. REMOVE EXISTING STEEL BEAM SUPPORTS AT EXISTING RTU. PREPARE ROOFING SYSTEM & STRUCTURE TO RECEIVE NEW CURB. RE: STRUCTURAL & MECHANICAL SHEETS

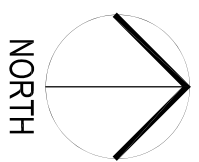

ROOF PLAN  
1/8" = 1'-0"

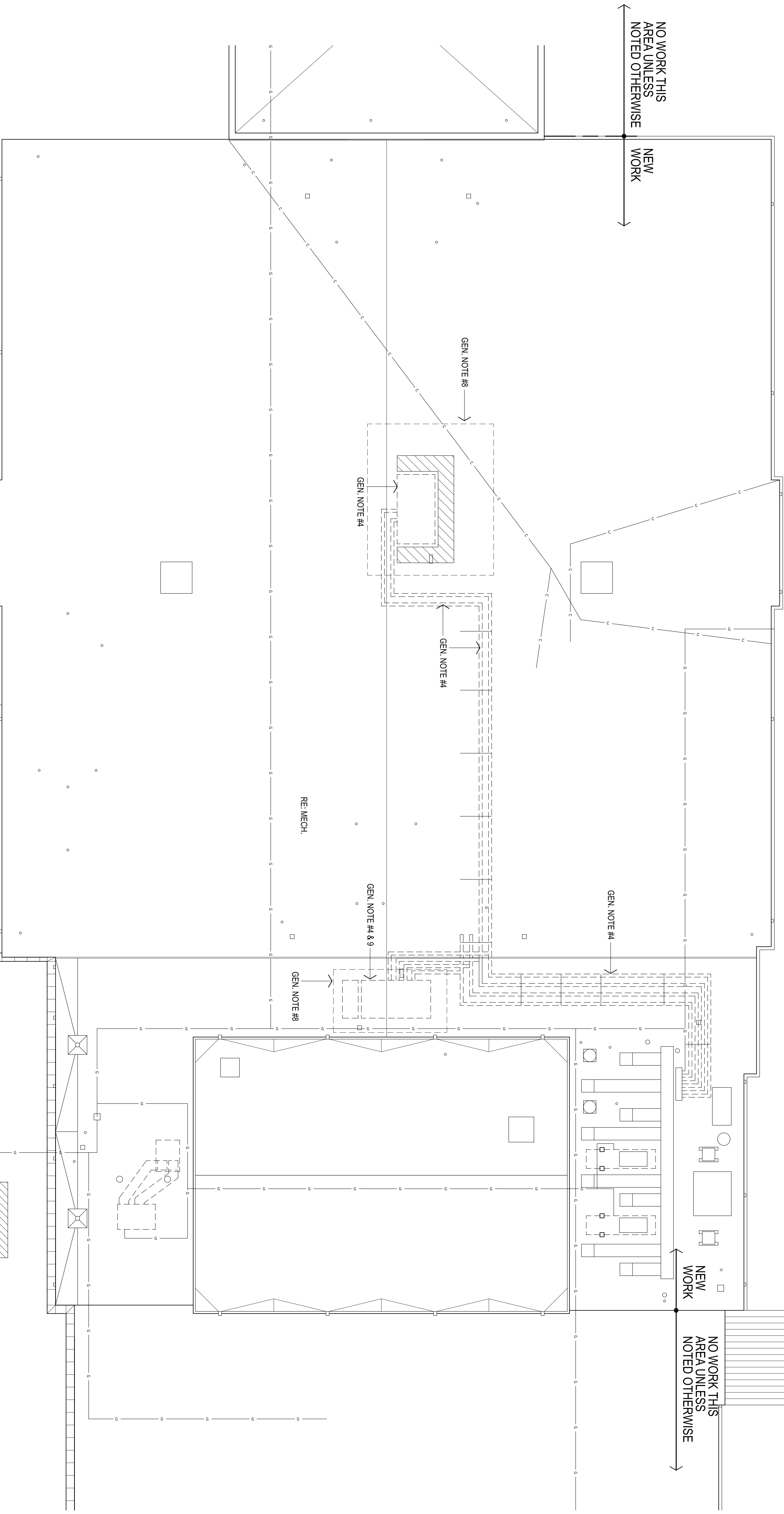

the Abia Griffin Partnership L.L.C.

313 S. E. 5th Street  
MOORE, OK. 73160  
405.735.3477  
AGP@theAGP.net  
www.theAGP.net

KFC ENGINEERING  
STRUCTURAL

SALAS O'BRIEN  
MECHANICAL / ELECTRICAL



CG	drawn by
MA	checked by
AUGUST 2024	date
	revisions



MOORE PUBLIC SCHOOLS

HOUGHIN ELEMENTARY  
HVAC UPGRADE

A103

Sheet no.:  
OWNERSHIP USE OF DOCUMENTS:  
AGP EXPRESSLY RESERVES ITS COPYRIGHT AND OTHER PROPERTY RIGHTS OF ALL PLANS AND DRAWINGS DESIGNED AND/OR PRODUCED. PLANS AND DRAWINGS ARE NOT TO BE REPRODUCED IN ANY FORM OR MANNER WITHOUT THE EXPRESS WRITTEN CONSENT OF AGP.