

GENERAL NOTES:

1. UNLESS NOTED OTHERWISE ALL ROOMS TO RECEIVE NEW 2'X2' LAY-IN CEILING & GRID.
2. @ WORK AREA - REINSTALL ALL EXISTING ELECTRICAL, (EXCLUDING EXISTING LIGHT FIXTURES), SPEAKERS, FIRE PROTECTION, ETC. PROVIDE ALL MATERIALS NECESSARY FOR A COMPLETE INSTALLATION
3. REMOVE EXISTING LIGHT FIXTURES AS REQUIRED BY CODE. RE: ELECTRICAL FOR NEW LIGHT FIXTURE INFORMATION
4. REMOVE EXISTING MECHANICAL DEVICES AS REQUIRED BY CODE. RE: MECHANICAL FOR NEW DEVICES.
5. REFER PLUMBING AND MECHANICAL SHEETS FOR ROOF PENETRATION LOCATIONS. PROVIDE ALL ROOFING MATERIALS REQUIRED TO MEET MFR. REQUIREMENTS FOR WARRANTY. PROVIDE WATER TIGHT INSTALLATION.
6. CONTRACTOR TO MOVE FURNITURE AS NECESSARY FOR INTERIOR HVAC AND CEILING WORK.
7. PROTECT EXISTING SMARTBOARDS AS DIRECTED BY MFS PERSONNEL. REPLACE ALL DAMAGED DEVICES.
8. CONTRACTOR SHALL THOROUGHLY CLEAN EXISTING AFFECTED AREAS AFTER COMPLETION OF WORK.
9. REMOVE EXISTING FUR-DOWN AND ADJUST CEILING HEIGHT AND ALL CEILING DEVICES. FIRE SUPPRESSION, ETC. FOR NEW CEILING HEIGHT.
10. AT ROOM# 117 & 118 - EXISTING CEILING SYSTEM 'PUNGS' OVER THE TOP OF EXISTING WALL. PROTECT GYP. BD. PARTITION AS REQUIRED FOR NEW 2'X2' ACOUSTICAL LAY-IN CEILING.
11. RELOCATE / ADJUST EXISTING FIRE SUPPRESSION SYSTEM HEADS AS REQUIRED FOR NEW WORK. RE: FIRE PROTECTION SHEETS

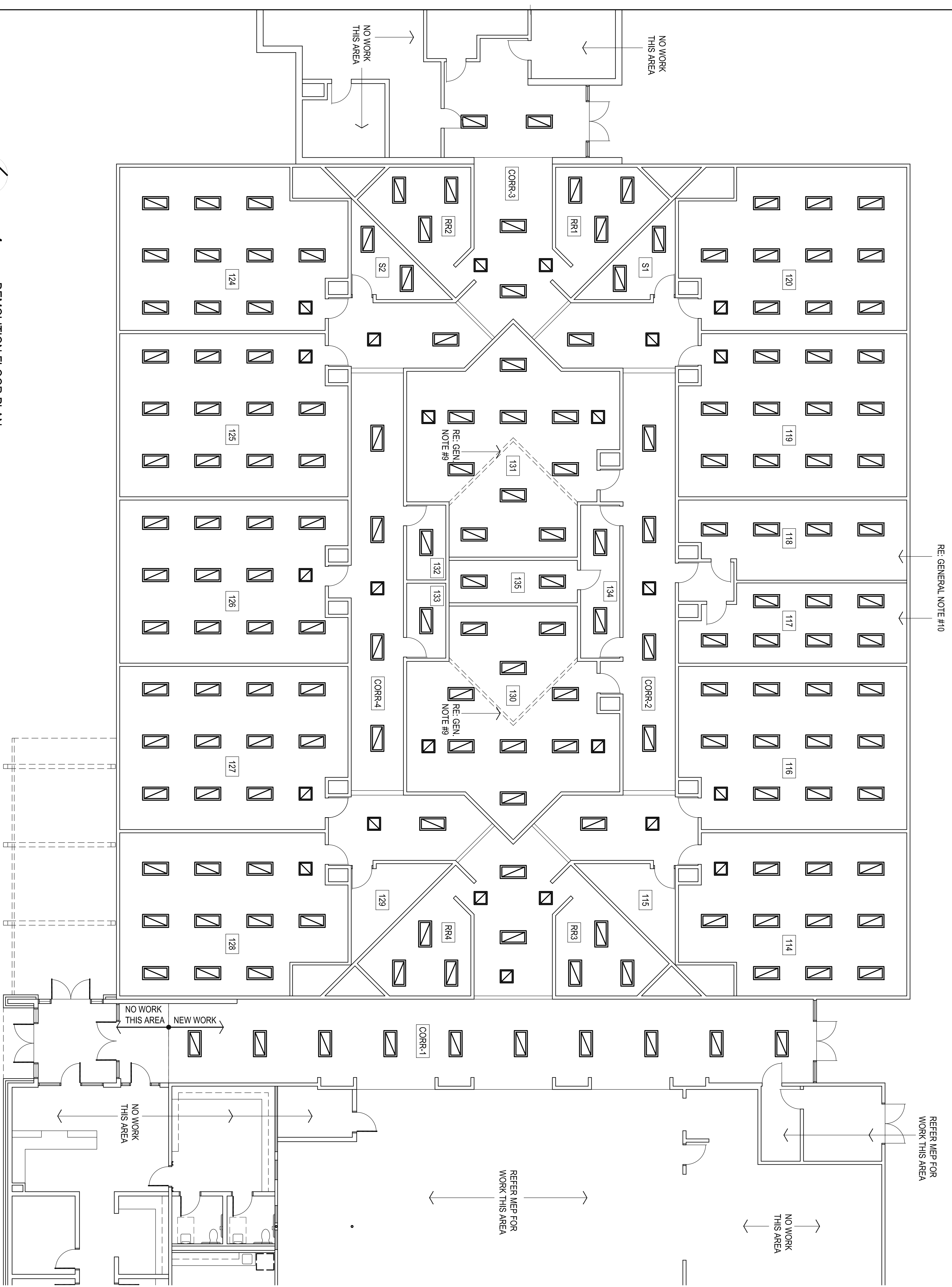

DEMOLITION FLOOR PLAN
1/8" = 1'-0"

