

## ABBREVIATIONS

|   |            |                                |
|---|------------|--------------------------------|
| ② | ABV        | ABOVE                          |
|   | ACOU.      | ACUSTICAL                      |
|   | ADJ.       | ADJUSTABLE                     |
|   | ANCH.      | ANCHOR                         |
|   | APPROX.    | APPROXIMATE                    |
|   | BD.        | BOARD                          |
|   | BLG.       | BLOCKING                       |
|   | BL.        | BOTTOM                         |
|   | BOT.       | BOTTOM                         |
|   | CLG.       | CENTERLINE                     |
|   | CONC.      | CONCRETE                       |
|   | CMU        | CONCRETE MASONRY UNIT          |
|   | COL.       | COLUMN                         |
|   | CONT.      | CONTINUOUS                     |
|   | D.F.       | DRINKING FOUNTAIN              |
|   | DM.        | DIMENSION                      |
|   | DR.        | DOOR                           |
|   | DWG.       | DRAWING                        |
|   | DWL.       | DOWEL                          |
|   | EA.        | EACH                           |
|   | ELECT.     | ELECTRICAL                     |
|   | ELEV.      | ELEVATION                      |
|   | EQ.        | EQUAL                          |
|   | EXP.       | EXPANSION JOINT                |
|   | E.W.       | EACH WAY                       |
|   | EXI.       | EXISTING                       |
|   | EXT.       | EXTERIOR                       |
|   | FD.        | FLOOR DRAIN                    |
|   | FE.        | FIRE EXTINGUISHER              |
|   | FEC.       | FIRE EXTINGUISHER CABINET      |
|   | FEL.       | FIRE EXTINGUISHER              |
|   | FIN.       | FINISH FLOOR LINE              |
|   | FRMG.      | FRAMING                        |
|   | GA.        | GAUGE                          |
|   | GB.        | GRAB BAR                       |
|   | GALV.      | GALVANIZED                     |
|   | GYP.       | GYP-SUM BOARD                  |
|   | BO.        | HANDICAP                       |
|   | HWID.      | HARDWOOD                       |
|   | HOVR.      | HARDWARE                       |
|   | HORIZ.     | HORIZONTAL                     |
|   | HT.        | HEIGHT                         |
|   | INSUL.     | INSULATION                     |
|   | JST.       | JOIST                          |
|   | JT.        | JOINT                          |
|   | LAV.       | LAVATORY                       |
|   | MAT.       | MATERIAL                       |
|   | MAX.       | MAXIMUM                        |
|   | Mech.      | MECHANICAL                     |
|   | MFG.       | MANUFACTURING                  |
|   | MFR.       | MANUFACTURER                   |
|   | MIN.       | MINIMUM                        |
|   | MISC.      | MISCELLANEOUS                  |
|   | MTL.       | METAL                          |
|   | N.I.C.     | NOT IN CONTRACT                |
|   | N.O./#     | NUMBER NOT TO SCALE            |
|   | N.T.S.     | NOT TO SCALE                   |
|   | O.C.       | ON CENTER                      |
|   | OPG.       | OPENING                        |
|   | OP.        | OPPOSITE                       |
|   | PP.        | PAPER POLE                     |
|   | PREFN.     | PREFINISHED                    |
|   | P.T.       | PAPER TOWEL                    |
|   | P.W./P.LY. | PLY WOOD                       |
|   | REDO.      | REDEMUR                        |
|   | RM.        | ROOM                           |
|   | S.B.       | SPLASH BLOCK                   |
|   | SCHED.     | SCHEDULE                       |
|   | STD.       | STANDARD                       |
|   | STL.       | STEEL                          |
|   | S.U.       | SPACE UNDER                    |
|   | T.C.       | TOP OF CURB                    |
|   | T.P.H.     | TYPICAL                        |
|   | TYP.       | TYPICAL UNLESS NOTED OTHERWISE |
|   | UNO.       | UNLESS NOTED OTHERWISE         |
|   | VTR.       | VENT THROUGH ROOF              |
|   | W.C.       | WATERCLOSET                    |
|   | WD.        | WOOD                           |
|   | WWF.       | WELDED WIRE FABRIC             |

## MATERIALS LEGEND

|  |  |
|--|--|
|  | MASONRY VENEER                                     |
|  | C.M.U.   |
|  | CONCRETE   |
|  | FRAME PARTITION, METAL STUDS                       |
|  | GYPSUM BOARD                                       |
|  | PARTICLE BOARD                                     |
|  | RIGID INSULATION                                   |
|  | WOOD BLOCKING / FRAMING, CONTINUOUS                |
|  | WOOD BLOCKING, DISCONTINUOUS                       |
|  | FINISH WOOD  |
|  | SMALL SCALE STRUCTURAL STEEL / MISCELLANEOUS METAL |
|  | LARGE SCALE STRUCTURAL STEEL                       |
|  | BATT INSULATION                                    |
|  | ACOUSTICAL CEILING TILE                            |
|  | EARTH FILL   |

## FOR PLANS AND DETAILS

## FOR DETAILS

## SYMBOLS LEGEND

|  |  |
|--|--|
|  | EXISTING SPOT ELEVATION                  |
|  | FINISH SPOT ELEVATION                    |
|  | EXISTING GRADE CONTOUR                   |
|  | FINISH GRADE CONTOUR                     |
|  | EXISTING TREE TO BE PROTECTED            |
|  | EXISTING TREE TO BE REMOVED              |
|  | PROJECT LIMITS                           |
|  | CHAINLINK FENCE                          |
|  | BARBED WIRE FENCE                        |
|  | CONCRETE PAVING                          |
|  | ASPHALT PAVING                           |
|  | CONCRETE SIDEWALK                        |
|  | EXISTING PAVING/SIDEWALK TO REMAIN       |
|  | EXISTING PAVING TO BE REMOVED            |
|  | NEW BUILDING                             |
|  | EXISTING BUILDING - NO WORK              |
|  | ROOM NUMBER                              |
|  | ROOM NUMBER, LARGE                       |
|  | SCALE PLAN REFERENCE                     |
|  | ROOM NUMBER/INTERIOR ELEVATION REFERENCE |
|  | WALL SECTION/DETAIL CUT MARK             |
|  | LARGE SCALE DETAIL MARK                  |
|  | STRUCTURAL GRID COORDINATES              |
|  | BUILDING SECTION CUT MARK                |
|  | DOOR NUMBER                              |
|  | WINDOW MARK                              |
|  | FRAME MARK                               |
|  | GLAZING MATERIAL MARK                    |
|  | EQUIPMENT MARK                           |
|  | EXTERIOR ELEVATION MARK                  |
|  | TEST HOLE                                |
|  | BENCH MARK/BUILDING ELEVATION (SECTION)  |

## GENERAL NOTES:

- ALL REQUIRED HANDICAP ACCESSIBLE ITEMS TO COMPLY WITH AMERICANS WITH DISABILITIES ACT AND ARCHITECTURAL BARRIERS ACT ACCESSIBILITY GUIDELINES.
- THE CONTRACTOR SHALL NOT USE ANY LEAD-BASED PAINT OR ASBESTOS CONTAINING MATERIAL ON THIS PROJECT
- THESE CONTRACT DOCUMENTS INCLUDING BUT NOT LIMITED TO THE DRAWINGS, PROJECT MANUAL AND ANY SUBSEQUENT ADDENDA ARE ISSUED AS A "WHOLE" AND SHALL BE BID AS SUCH. EACH DISCIPLINE / SUBCONTRACTOR SHALL REVIEW THE ENTIRE SET OF CONTRACT DOCUMENTS AND INCLUDE APPLICABLE WORK IN THEIR BID REGARDLESS OF LOCATION WITHIN THE CONTRACT DOCUMENTS. REVIEWING ONLY PORTION OF THE CONTRACT DOCUMENTS SHALL NOT ABSOLVE THE CONTRACTOR OR SUBCONTRACTOR OF THE REQUIREMENT TO PERFORM THE WORK OF THEIR RESPECTIVE DISCIPLINES.
- LOCATIONS OF EXISTING BUILDINGS, SITE FEATURES, & UNDERGROUND UTILITIES HAVE BEEN OBTAINED FROM EXISTING AVAILABLE SOURCES. THE CONTRACTOR IS TO FIELD VERIFY EXISTING LOCATIONS PRIOR TO STARTING CONSTRUCTION AND NOTIFY THE ARCHITECT IMMEDIATELY IF ANY EXISTING BUILDING OR SITE FEATURE CONFLICTS WITH THE NEW CONSTRUCTION.
- THE CONTRACTOR SHALL VERIFY ALL EXISTING SITE UTILITIES AND PROTECT DURING CONSTRUCTION. COORDINATE NEW UTILITY REQUIREMENTS WITH APPLICABLE UTILITY COMPANIES (WATER, GAS, ELECTRICITY, SANITARY, SEWER, TELEPHONE, CABLE, SITE DRAINAGE AND OTHERS, AS REQUIRED). COMPLY WITH ALL APPLICABLE REGULATIONS. INCLUDE ALL CONNECTION FEES AND OTHER CHARGES IN BID.
- REFER TO MECHANICAL AND ELECTRICAL DRAWINGS FOR UTILITY INFORMATION.
- REFER TO MECHANICAL AND ELECTRICAL DRAWINGS FOR ADDITIONAL REQUIREMENTS AND CONCRETE TO BE PROVIDED BY CONTRACTOR.
- GENERAL CONTRACTOR TO VERIFY LOCATIONS OF EXISTINGS, ENCUMBRANCES AND SET BACKS PRIOR TO STARTING CONSTRUCTION
- CONFLICTS BETWEEN DRAWINGS AND SPECIFICATIONS SHALL BE BROUGHT TO ARCHITECT'S ATTENTION. FAILURE TO BID ITEMS NOTED ON DRAWINGS AND OMITTED FROM SPECIFICATIONS DOES NOT REMOVE RESPONSIBILITY TO PROVIDE AND INSTALL SUCH.

## GENERAL NOTES (CONT.):

- CONSTRUCTION STAGING AREA & VEHICLE ACCESS SHALL BE CONFIRMED WITH OWNER, AND CONSTRUCTION MANAGER IF APPLICABLE. PRIOR TO CONSTRUCTION, FINISH GRADE AT BUILDING PERIMETERS SHALL BE 6" BELOW FINISH FLOOR UNLESS SPECIFICALLY NOTED OTHERWISE ON CIVIL DRAWINGS. DEVELOP POSITIVE DRAINAGE AWAY FROM NEW AND/OR EXISTING BUILDINGS).
- ALL GRID LINES IDENTIFIED BY A LETTER OR NUMBER ARE PARALLEL UNLESS OTHERWISE NOTED.
- SIZES OF HOUSEKEEPING PADS AND BAYS FOR MECHANICAL EQUIPMENT ARE APPROXIMATE. CONTRACTOR SHALL VERIFY EXACT LOCATION AND REQUIRED SIZE OF ALL CONCRETE PADS AND BAYS WITH EQUIPMENT MANUFACTURERS BEFORE POURING. ALL PADS TO BE PROVIDED BY THE CONTRACTOR.
- CONTRACTOR SHALL COORDINATE THE INSTALLATION OF THE VARIOUS TRADE ITEMS WITHIN THE SPACE ABOVE THE CEILINGS INCLUDING, BUT NOT LIMITED TO STRUCTURAL MEMBERS AND SPRAY-ON INSULATION OR FIREPROOFING, MECHANICAL DUCTS AND BATT INSULATION, CONDUITS, RACKWAY, SPRINKLER SYSTEMS, LIGHT FIXTURES, CEILING SYSTEMS, AND ANY SPECIAL STRUCTURAL SUPPORTS REQUIRED) AND SHALL BE RESPONSIBLE FOR MAINTAINING THE FINISH CEILING HEIGHT ABOVE THE FINISH FLOOR INDICATED IN THE DRAWINGS AND FINISH SCHEDULE.
- ALL METAL STUDS WALLS WHERE PLUMBING OCCURS OR STRUCTURAL COLUMNS ARE LOCATED SHALL BE MINIMUM 6" METAL STUDS. NOTIFY ARCHITECT OF ANY DISCREPANCIES OR CONFLICTS.
- PROVIDE AND INSTALL ACCESS PANELS, WHERE REQUIRED BY BUILDING CODE OR FOR THE PROPER OPERATION OF MECHANICAL OR ELECTRICAL EQUIPMENT AND AS SHOWN ON THE DRAWINGS. CONTRACTOR SHALL COORDINATE SIZE, LOCATION, AND TYPE OF ACCESS PANEL WITH OTHER CONTRACTORS' WORK AND RECEIVE APPROVAL OF THE ARCHITECT. ACCESS PANEL SHALL BE AS SPECIFIED.
- 3/4" FIRE-RETARDANT TREATED PLYWOOD BACKING 8'-0" HIGH SHALL BE PROVIDED AND INSTALLED ON ALL WALLS OF TELEPHONE AND ELECTRICAL ROOMS UNLESS SPECIFICALLY SHOWN OTHERWISE ON ELECTRICAL DRAWINGS.
- ALL WOOD WITHIN THIS PROJECT (I.E. PLYWOOD, BLOCKING, ETC.) SHALL BE FIRE-RETARDANT TREATED.
- FOR ILLUSTRATION AND DEFINITION OF TYPICAL SYMBOLS USED ON THE ARCHITECTURAL DRAWINGS, SEE "SYMBOLS AND ABBREVIATIONS" SHEET. ADDITIONAL SYMBOLS NOT SHOWN OR DEFINED THERE MAY OCCUR AND ARE DEFINED ON OTHER DRAWINGS.
- REFER TO SPECIFICATIONS FOR ADDITIONAL PAINT ITEMS NOT SHOWN ON ROOM FINISH SCHEDULE.
- THE SPECIFICATIONS AND ALL CONSULTANT DRAWINGS ARE SUPPLEMENTAL TO THE ARCHITECTURAL DRAWINGS. IT SHALL BE THE CONTRACTOR'S RESPONSIBILITY TO COORDINATE WITH THE ARCHITECTURAL DRAWINGS BEFORE THE INSTALLATION OF ANY OF THE CONSULTANTS' WORK AND TO BRING ANY DISCREPANCIES OR CONFLICTS TO THE ARCHITECT'S ATTENTION FOR CLARIFICATION. IMPROPERLY INSTALLED WORK SHALL BE CORRECTED BY THE CONTRACTOR AT NO EXPENSE TO THE ARCHITECT. HIS CONSULTANTS OR THE OWNER.
- THE ARCHITECTURAL DRAWINGS ARE A PART OF A LARGER SET OF DRAWINGS WHICH, WHEN COMPLETE, CONSISTS OF ALL DRAWINGS LISTED BY THE INDEX OF DRAWINGS. THE WORK DESCRIBED BY THE DRAWINGS OF ANY ONE DISCIPLINE MAY BE AFFECTED BY THE WORK DESCRIBED ON DRAWINGS OF ANOTHER DISCIPLINE AND MAY REQUIRE REFERENCE TO DRAWINGS OF ANOTHER DISCIPLINE. PARTIAL SETS OF DRAWINGS SHALL NOT BE DISTRIBUTED AND UTILIZED BY THE CONTRACTOR. IT IS THE CONTRACTOR'S RESPONSIBILITY TO REVIEW AND COORDINATE THE WORK OF ALL SUBCONTRACTORS, TRADES, AND SUPPLIERS WITH THE REQUIREMENTS OF THE CONTRACT BEFORE COMMENCING CONSTRUCTION AND TO ASSURE THAT ALL PARTIES ARE AWARE OF ALL REQUIREMENTS, REGARDLESS OF WHERE THE REQUIREMENTS OCCUR IN THE CONTRACT DOCUMENTS.
- THE ARCHITECTURAL DRAWINGS ESTABLISH AND COORDINATE THE FINISHED APPEARANCE AND EXACT LOCATIONS OF ALL EXPOSED ELEMENTS OF THE WORK, INCLUDING THAT WORK WHICH IS ILLUSTRATED PRIMARILY ON DRAWINGS OF OTHER DISCIPLINES. LOCATIONS SHOWN ON OTHER DRAWINGS ARE SCHEMATIC. UNLESS OTHERWISE NOTED ON THE ARCHITECTURAL DRAWINGS, THE ARCHITECTURAL DRAWINGS TAKE PRECEDENCE FOR THE FINISHED APPEARANCE AND EXACT LOCATION OF ALL PARTS OF THE WORK. EXCEPTIONS: DIMENSIONED LOCATIONS SHOWN ON DRAWINGS OF OTHER DISCIPLINES SHALL GOVERN ONLY WHERE: (A) SPECIFICALLY AND INDIVIDUALLY INDICATED BY SYMBOL, KEYED NOTE, OR NOTATION ON THE ARCHITECTURAL DRAWINGS; (B) OCCURRING WITHIN A ROOM OR OTHER IDENTIFIED SPACE FOR WHICH ARCHITECTURAL SHEET OR SCHEDULE NOTES INDICATE THAT DIMENSIONS PROVIDED ELSEWHERE SHALL GOVERN; (C) OCCURRING WITHIN A ROOM OR OTHER IDENTIFIED SPACE FOR WHICH ARCHITECTURAL SHEET OR SCHEDULE NOTES INDICATE THAT DIMENSIONS PROVIDED ELSEWHERE SHALL GOVERN; (D) OCCURRING WITHIN A ROOM OR OTHER IDENTIFIED SPACE FOR WHICH ARCHITECTURAL SHEET OR SCHEDULE NOTES INDICATE THAT DIMENSIONS PROVIDED ELSEWHERE SHALL GOVERN.
- WORK NOT SPECIFICALLY INDICATED AS A PART OF THE DRAWINGS BUT REASONABLY IMPLIED TO BE SIMILAR TO WORK SHOWN ON THE DRAWINGS IN CORRESPONDING AND OTHER PLACES SHALL BE CONSTRUCTED SIMILARLY.
- PROVIDE FIRE EXTINGUISHERS WITH A RATING OF NOT LESS THAN 2A WITHIN 75 FOOT TRAVEL DISTANCE TO ALL PORTIONS OF THE BUILDING. PROVIDE PORTABLE FIRE EXTINGUISHERS AS THE BUILDING IS CONSTRUCTED.

## PROJECT LOCATION

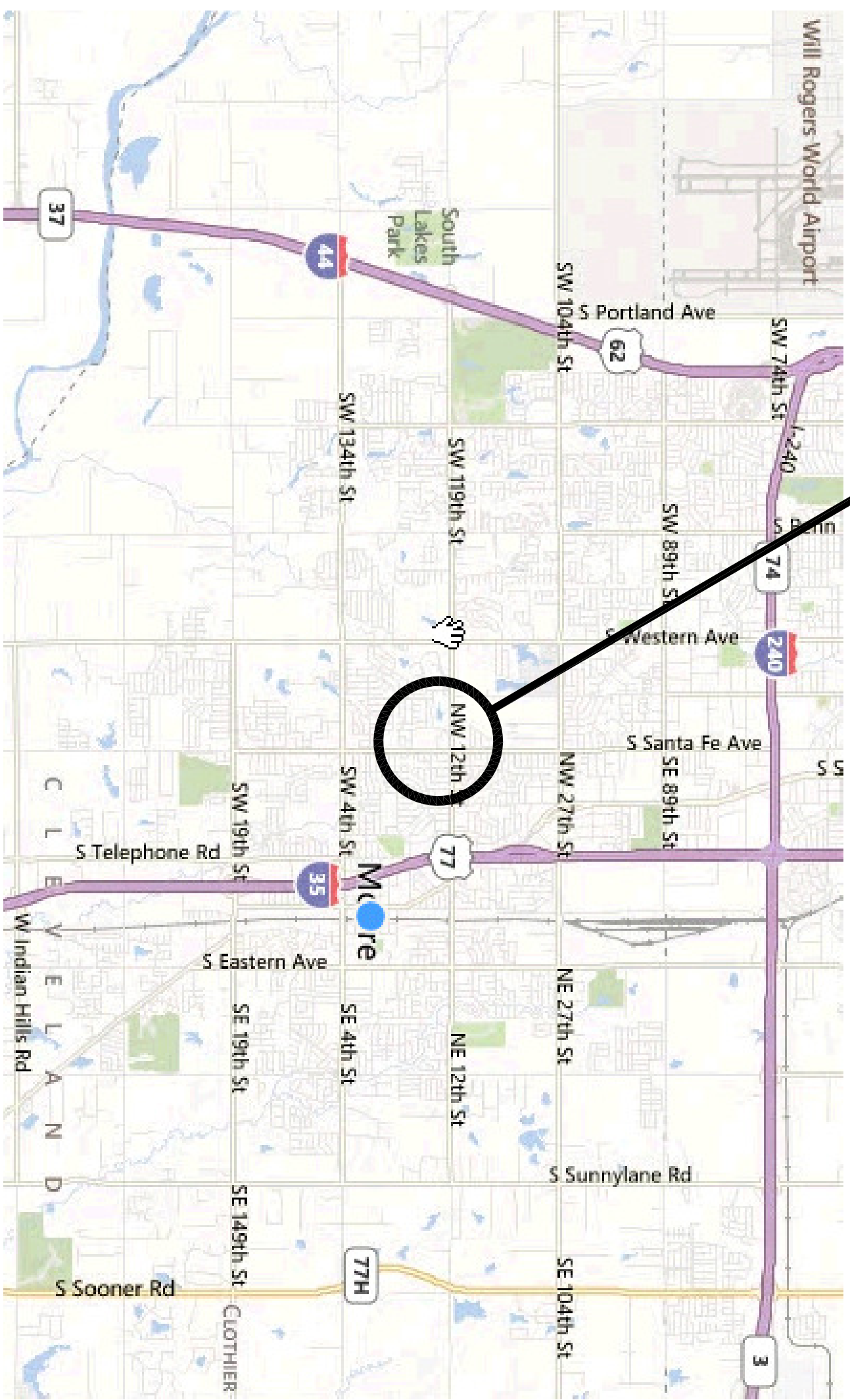

## VICINITY MAP

HIGHLAND WEST JUNIOR HIGH SCHOOL  
901 N. SANTA FE  
MOORE, OKLAHOMA 73160

