

CEDAR CREEK
CIVIL

KFC ENGINEERING
STRUCTURAL

SALAS O'BRIEN
MECHANICAL / ELECTRICAL



KP

drawn by

KP

checked by

JULY 2023

date

revisions

MOORE PUBLIC SCHOOLS
BOARD OF EDUCATION
MOORE, OKLAHOMA



CLASSROOM ADDITION
HIGHLAND WEST
JUNIOR HIGH SCHOOL

sheet no:

F103

OWNERSHIP USE OF DOCUMENTS:

AGP EXPRESSLY RESERVES ITS
COPYRIGHT AND OTHER PROPERTY
RIGHTS OF ALL PLANS AND DRAWINGS
DESIGNED AND/OR PRODUCED. PLANS
AND DRAWINGS ARE NOT TO BE
REPRODUCED IN ANY FORM OR MANNER
WITHOUT THE EXPRESSED WRITTEN
CONSENT OF AGP.

GENERAL NOTES

1. COORDINATE WORK WITH ALL OTHER TRADES ON SITE.
2. FIELD VERIFY EXISTING CONDITIONS PRIOR TO COMMENCING WORK.
3. FIRE SEAL ALL PENETRATIONS THRU RATED STRUCTURES TO MAINTAIN FIRE RATING.
4. REFER TO NOTES ON SHEET F000.
5. COORDINATE INSPECTORS TEST DRAIN LOCATION WITH ALL TRADES ON SITE.

KEYED NOTES

- ① LIGHT HAZARD NEW ADDITION AREA. REFER TO ARCHITECTURAL PLANS FOR CEILING TYPE.

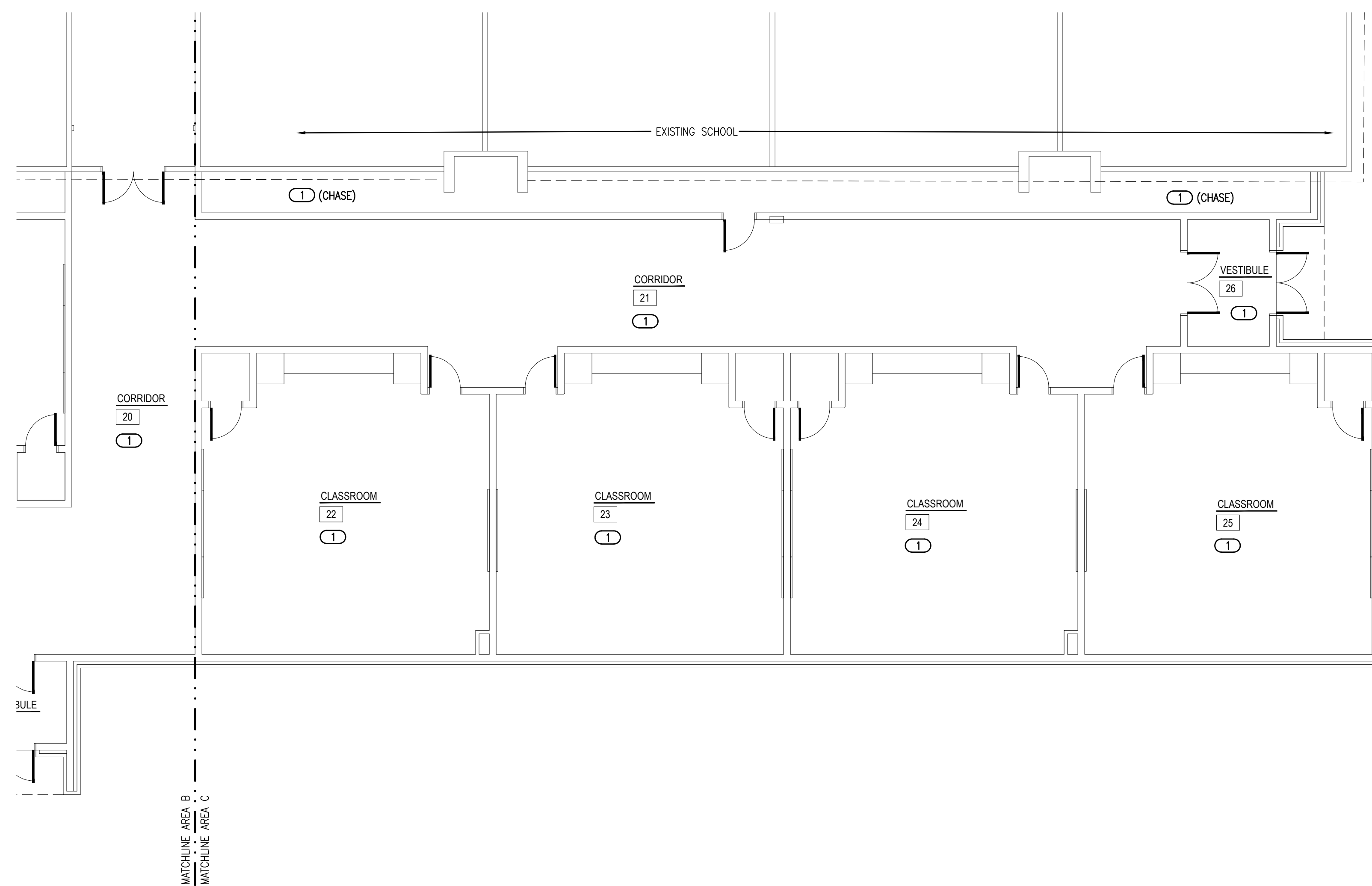

1 FIRE PROTECTION PLAN - AREA C
SCALE: 1/8" = 1'-0"

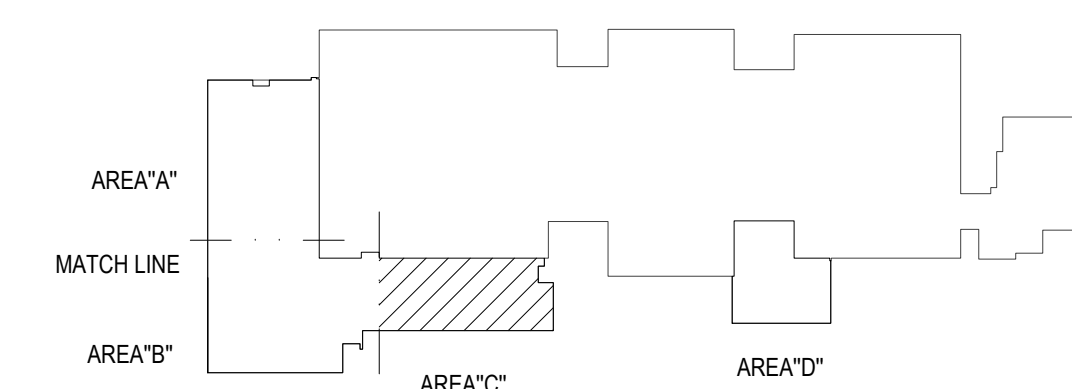

KEY PLAN

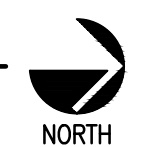

Salas O'Brien
2600 Van Buren St., Suite 2635
Norman, OK 73072
Salas O'Brien Registration: CA# 7058
Expiration Date: 6/30/2025
Salas O'Brien Project Number: 2023-02792-00