

**1 ELECTRICAL POWER PLAN - AREA A**  
SCALE: 1/8" = 1'-0"

- POWER GENERAL NOTES**
- COORDINATE EXACT LOCATIONS OF DEVICES SHOWN WITH OTHER EQUIPMENT. COORDINATE EXACT LOCATION OF CEILING MOUNTED DEVICES WITH LIGHTS, HVAC EQUIPMENT, AND OTHER DEVICES.
  - COORDINATE WITH MECHANICAL CONTRACTOR AND PROVIDE ALL RELAYS, CONNECTIONS, AND ALL DEVICES NECESSARY TO INTERLOCK EXHAUST FANS, DAMPERS, ETC WITH PROPER CONTROL DEVICES.
  - COORDINATE EXACT LOCATION OF MECHANICAL EQUIPMENT WITH MECHANICAL CONTRACTOR.

- KEYED NOTES**
- RECEPTACLE FOR SMART BOARD (BY OWNER) IN A RECESSED BACK BOX. REFER TO DETAIL 'E501/5' FOR ADDITIONAL INFORMATION.
  - PROVIDE 120V DROP CORD RECEPTACLE FOR GENERAL USE. COORDINATE FINAL LOCATIONS AND REQUIREMENTS WITH OWNER/ARCHITECT PRIOR TO ROUGH-IN. REFER TO DETAIL 'E501/9' FOR ADDITIONAL INFORMATION.
  - PROVIDE 120V RECEPTACLES FOR FRIDGE & FREEZER. COORDINATE FINAL LOCATIONS AND REQUIREMENTS WITH ARCHITECT/OWNER PRIOR TO ROUGH-IN. ADJUST CONNECTION AS REQUIRED FOR A COMPLETE INSTALLATION.
  - PROVIDE 120V RECEPTACLE FOR WATER COOLER. COORDINATE EXACT LOCATIONS AND REQUIREMENTS WITH OWNER/ARCHITECT PRIOR TO ROUGH-IN.
  - PROVIDE 120V RECEPTACLE FOR WATER HEATER. COORDINATE EXACT LOCATIONS AND REQUIREMENTS WITH PLUMBING CONTRACTOR PRIOR TO ROUGH-IN.
  - PROVIDE 120V CONNECTION FOR CIRCULATION PUMP. CP-1 SHALL SERVE BOTH WH-1 & WH-2. COORDINATE EXACT LOCATION AND REQUIREMENTS WITH PLUMBING CONTRACTOR PRIOR TO ROUGH-IN.
  - PROVIDE 120V CONNECTION FOR TRAP PRIMER LOCATED ON WALL 4'-0" AFF. COORDINATE EXACT LOCATION AND REQUIREMENTS WITH PLUMBING CONTRACTOR PRIOR TO ROUGH-IN.
  - APPROXIMATE LOCATION OF TEACHERS DESK. COORDINATE FINAL LOCATION AND REQUIREMENTS WITH OWNER/ARCHITECT PRIOR TO ROUGH-IN. REFER TO DETAIL 'E501/5' FOR ADDITIONAL INFORMATION.
  - PROVIDE DEDICATED CIRCUIT CONNECTION FOR 3D PRINTER. COORDINATE EXACT LOCATION AND REQUIREMENTS WITH OWNER/ARCHITECT PRIOR TO ROUGH-IN.

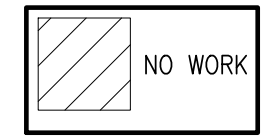

**AGP**  
the Abila Griffin  
Partnership L.L.C.

201 N. BROADWAY  
SUITE 210  
MOORE, OK. 73160  
405.735.3477  
AGP@theAGP.net  
www.theAGP.net

CEDAR CREEK  
CIVIL

KFC ENGINEERING  
STRUCTURAL

SALAS O'BRIEN  
MECHANICAL / ELECTRICAL



GT  
drawn by

TVO  
checked by

JULY 2023  
date

revisions

MOORE PUBLIC SCHOOLS  
BOARD OF EDUCATION  
MOORE, OKLAHOMA



CLASSROOM ADDITION  
HIGHLAND WEST  
JUNIOR HIGH SCHOOL

sheet no:

**E201**

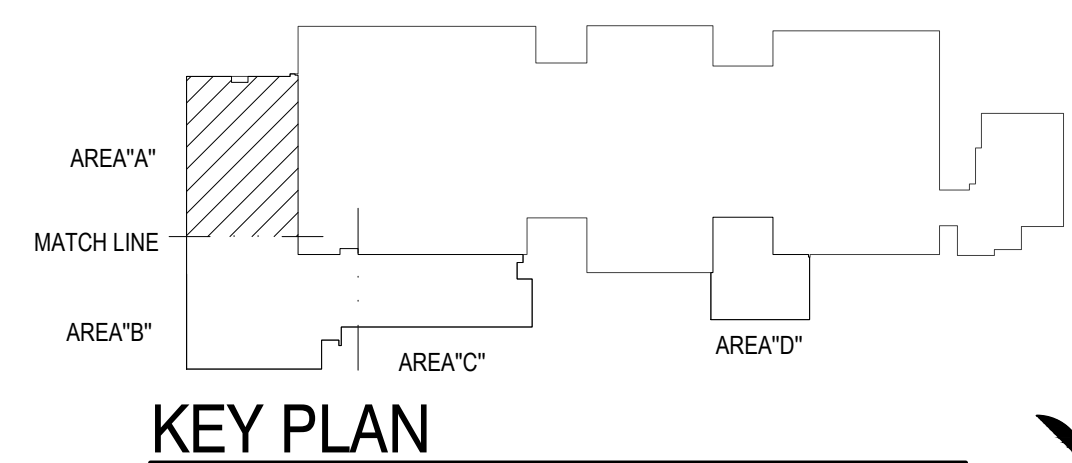

**Salas O'Brien**

2600 Van Buren St., Suite 2635  
Norman, OK 73072  
Salas O'Brien Registration: CA# 7058  
Expiration Date: 6/30/2025  
Salas O'Brien Project Number: 2023-02792-00

OWNERSHIP USE OF DOCUMENTS:  
AGP EXPRESSLY RESERVES ITS  
COPYRIGHT AND OTHER PROPERTY  
RIGHTS OF ALL PLANS AND DRAWINGS  
DESIGNED AND/OR PRODUCED. PLANS  
AND DRAWINGS ARE NOT TO BE  
REPRODUCED IN ANY FORM OR MANNER  
WITHOUT THE EXPRESSED WRITTEN  
CONSENT OF AGP.