

EXISTING BUILDING
NO WORK UNLESS
NOTED OTHERWISE

← NEW ADDITION

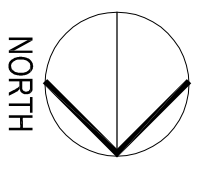
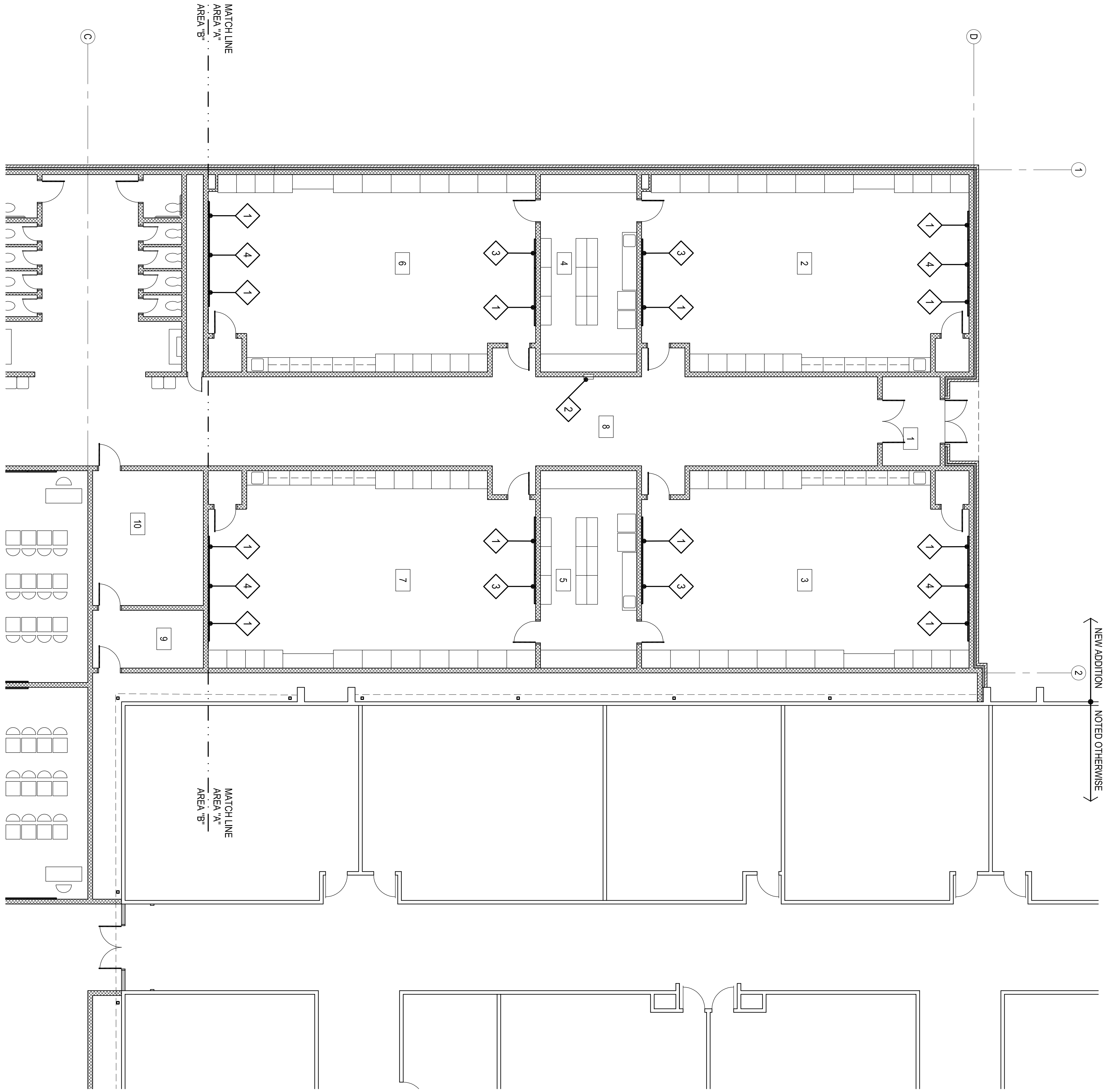

1
EQUIPMENT FLOOR PLAN - AREA "A"
1/8" = 1'-0"

ITEM NO.	FI	OF/CI	DESCRIPTION	MANUFACTURER		REMARKS
				NAME	MODEL NO.	
1	●		MARKERBOARD -4'-0"	BEST-RITE CHALKBOARD CO.	RE: SPECS	W/ CHALK RAIL
2	●		FIRE EXTINGUISHER & CABINET	JL INDUSTRIES	RE: SPECS	
3	●		TACKBOARD - 8'-0"	BEST-RITE CHALKBOARD CO.	RE: SPECS	
4		●	SMARTBOARD			BY OWNER
5		●	TOILET PAPER HOLDER			
6		●	PAPER TOWEL DISPENSER			
7		●	SOAP DISPENSER			

NOTE:
ALL CHALKBOARDS & TACKBOARDS MOUNTED @ EXTERIOR WALLS SHALL HAVE "STAND-OFF" MOUNTING BRACKETS TO PREVENT CONDENSATION BEHIND BOARDS.

2 EQUIPMENT SCHEDULE

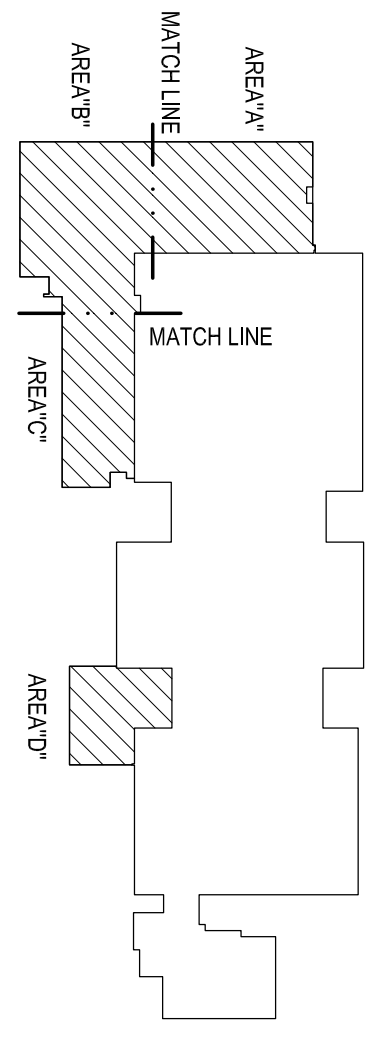
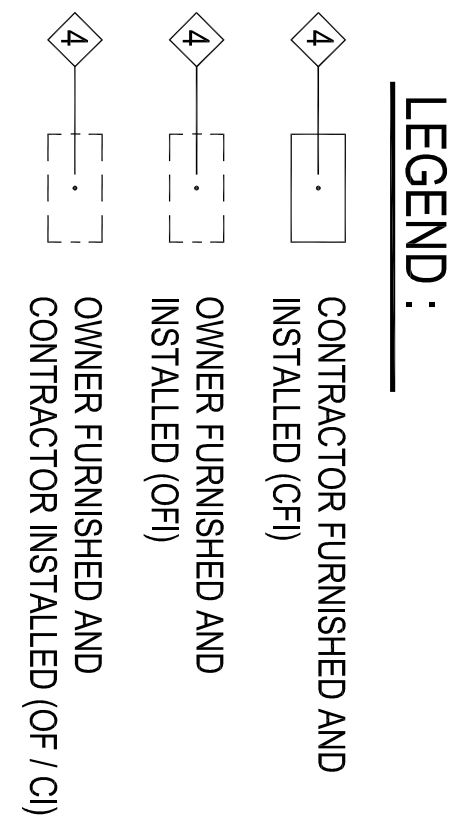

KEY PLAN

AGP
the Abila Griffin
Partnership L.L.C.
201 N. BROADWAY
SUITE 210
MOORE, OK. 73160
405.735.3477
AGP@theAGP.net
www.theAGP.net

CEDAR CREEK
CIVIL
KFC ENGINEERING
STRUCTURAL
SALAS ORRIEN
MECHANICAL/ELECTRICAL



CC _____
drawn by _____
MA _____
checked by _____
DATE JULY 2023
DESIGNER _____
REVISIONS _____

MOORE PUBLIC SCHOOLS
BOARD OF EDUCATION
MOORE, OKLAHOMA



CLASSROOM ADDITION
HIGH AND WEST
JUNIOR HIGH SCHOOL

Sheet No. **A120**

EQUIPMENT PLAN
OWNERSHIP USE OF DOCUMENTS:
AGP EXPRESSLY RESERVES ITS
COPYRIGHT AND OTHER PROPERTY
RIGHTS OF ALL PLANS AND DRAWINGS
DESIGNED AND/OR PRODUCED BY
AGP. ANY REPRODUCTION OR
REPRODUCTION IN ANY FORM OR MANNER
WITHOUT THE EXPRESSED WRITTEN
CONSENT OF AGP.