



7/31/23

CC
drawn by
MA
checked by
JULY 2023
date
revisions

MOORE PUBLIC SCHOOLS
BOARD OF EDUCATION
MOORE, OKLAHOMA

MOORE Public Schools
LEARNING FOR LIFE

CLASSROOM ADDITION
HIGHLAND WEST
JUNIOR HIGH SCHOOL

Sheet No.

A114

ROOF PLAN

OWNERSHIP USE OF DOCUMENTS:

AGP EXPRESSLY RESERVES ITS
COPYRIGHT AND OTHER PROPERTY
RIGHTS OF ALL PLANS AND DRAWINGS
DESIGNED AND/OR PRODUCED BY
AGP AND ITS AFFILIATES. THESE
DRAWINGS ARE TO BE USED ONLY IN
CONFORMANCE WITH THE
WITHOUT THE EXPRESSED WRITTEN
CONSENT OF AGP.

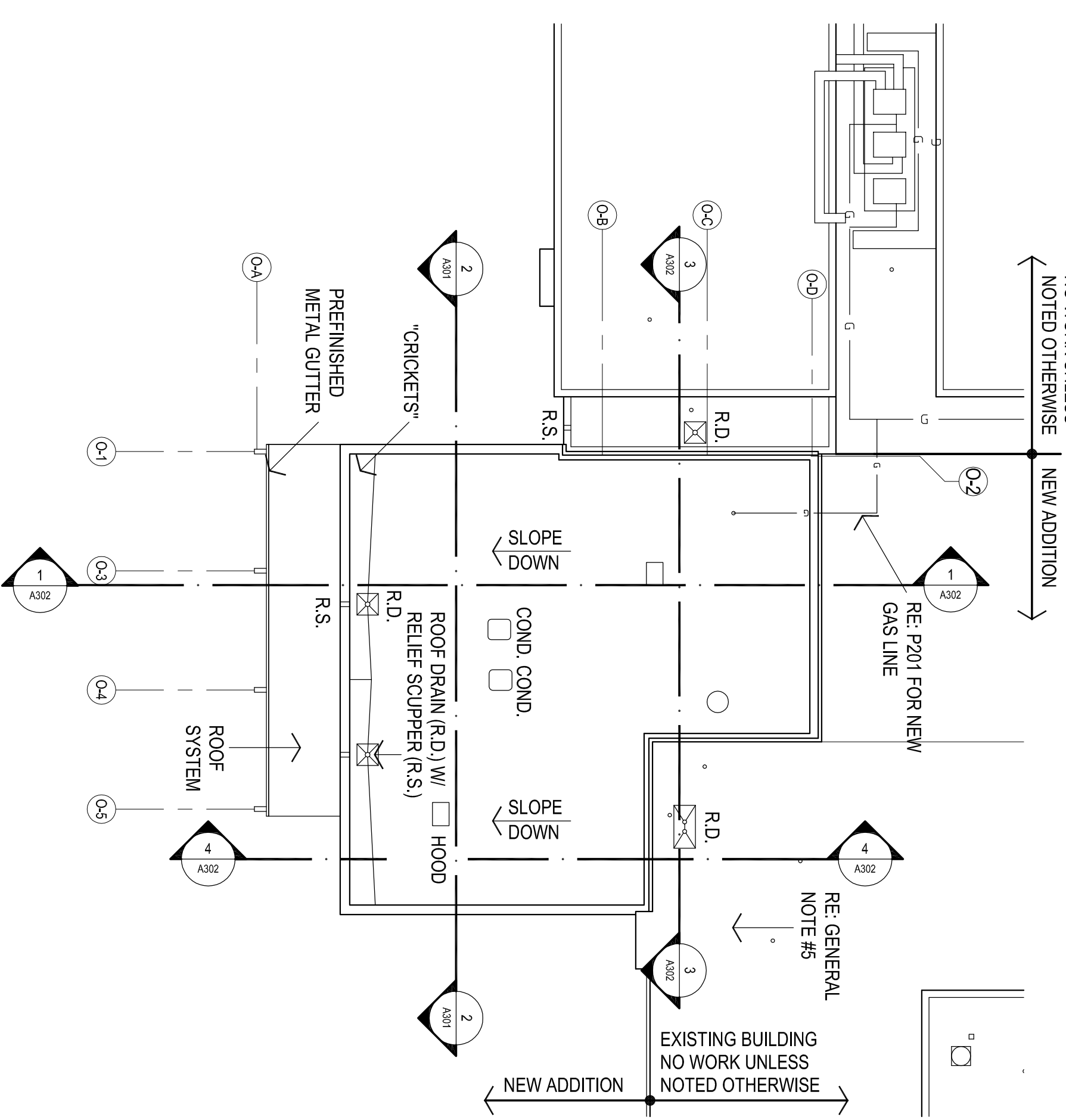

2

ROOF PLAN - OFFICE AREA "D"

1/16" = 1'-0"

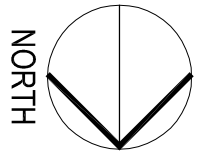
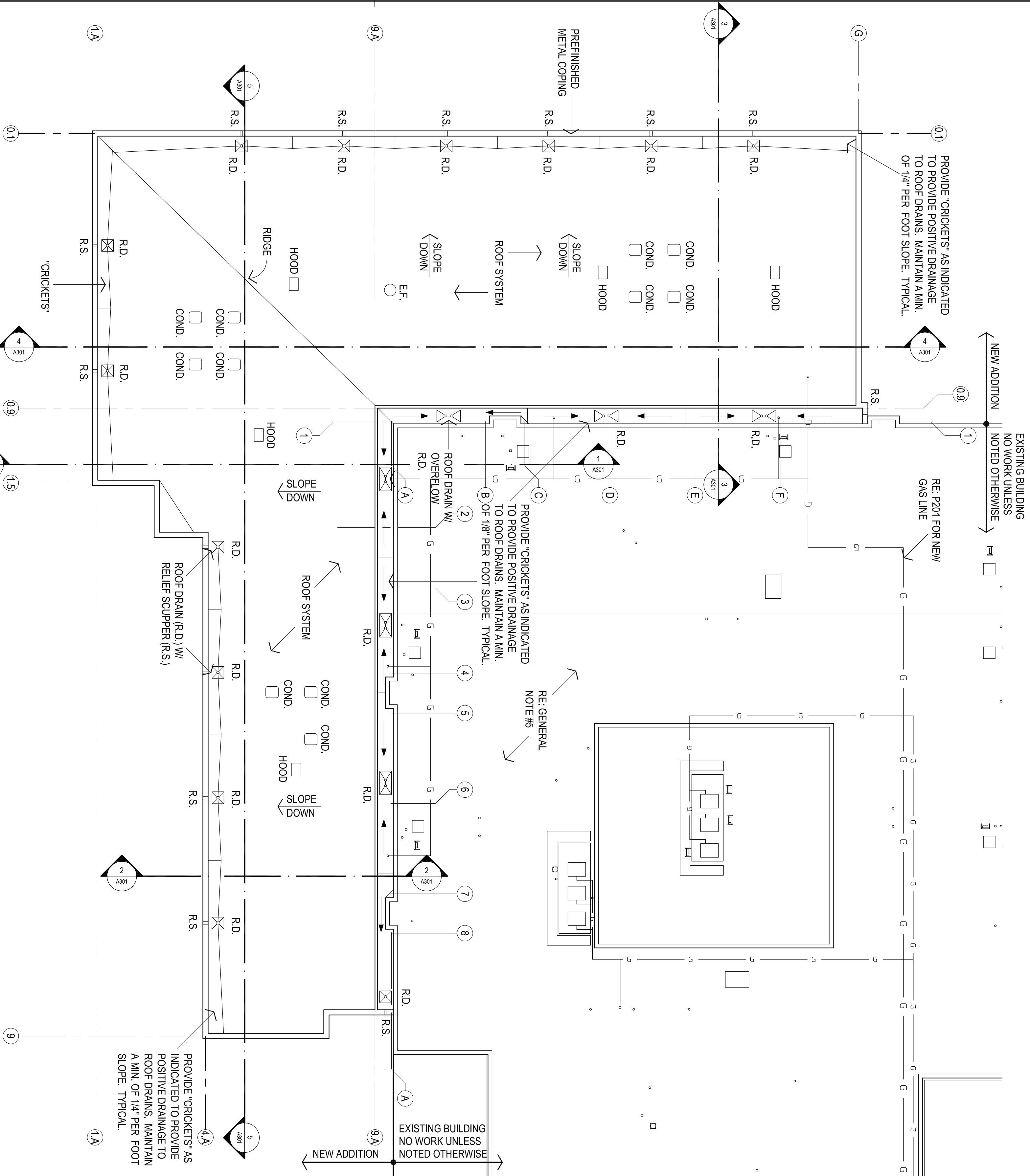

1

ROOF PLAN - CLASSROOM AREAS "A", "B" & "C"

1/16" = 1'-0"

- NOTES:
1. RE: MECH & ELEC. FOR ADDITIONAL ROOF MOUNTED ITEMS. CONTRACTOR TO COORDINATE ALL ROOF MOUNTED ITEMS & PENETRATIONS W/ APPLICABLE TRADES
 2. CONTRACTOR TO COORDINATE ROOF VENT PENETRATIONS W/ ARCHITECT.
 3. INDICATES NEW WALKWAY PAD LOCATIONS - CUT PADS INTO 5'-0" MAX LENGTHS & PLACE 2' APART TO COVER AREAS INDICATED.
 4. PROVIDE @ ALL ROOF PENETRATIONS - PENETRATION DAM / SEALER POCKETS AS PER 6A115
 5. PROVIDE NEW "CRICKET" AT EXISTING ROOF SYSTEM TO PROVIDE POSITIVE DRAINAGE TO ROOF EDGE / NEW SCUPPER. MAINTAIN A MIN. OF .18" PER FOOT SLOPE. PROVIDE NEW WOOD BLOCKING, EDGE METAL, ETC. FOR A COMPLETE INSTALLATION. MODIFY EXISTING ROOF SYSTEM AS REQUIRED TO INSTALL NEW OVERLAY AND TAPERED INSULATION TO PROVIDE POSITIVE DRAINAGE TO NEW SCUPPER COORDINATE W/ ARCHITECT

