

- GENERAL NOTES**
- COORDINATE WORK WITH ALL TRADES ON SITE.
 - MAINTAIN MINIMUM OF 10'-0" CLEAR BETWEEN EXHAUST AND INTAKE VENTS WITH MECHANICAL EQUIPMENT AND OTHER ROOF OPENINGS.
 - FIELD VERIFY EXISTING CONDITIONS PRIOR TO COMMENCING WORK.
 - ALL ABOVE GRADE EXTERIOR NATURAL GAS PIPE SHALL BE CLEANED AND DEGREASED PRIOR TO BEING PRIMED THEN PAINTED YELLOW WITH WEATHER RESISTANT ZINC RICH PAINT.
 - PIPE IDENTIFICATION SHALL BE THE WORD "NATURAL GAS" IN BLACK LETTERS AT 5 FT INTERVALS USING PLASTIC PIPE MARKERS OR STENCILED PAINTED LETTERS.
 - ALL GAS PIPE SHALL COMPLY WITH IFGC. BRANCH LINES SHALL TAP OFF TOP OF GAS MAINS AND INSTALL SHUT-OFF VALVE ON BRANCH LINE.
 - ROUTE NATURAL GAS LINE (2 PSI) ON ROOF. PROVIDE MIRO INDUSTRIES MODEL 3-RAH-8 ROOF TOP SUPPORTS OR APPROVED EQUAL. INSTALL AT MAXIMUM OF 10'-0" APART (CENTER TO CENTER) ON ALL 1 1/4" NATURAL GAS PIPING OR LARGER. REFER TO GENERAL NOTES FOR PAINTING GAS LINE. SEE PIPE SUPPORT DETAIL 10/PS01.
 - MODIFY EXISTING GAS METER DISCHARGE LINE FOR CONNECTION OF NEW 2" GAS LINE. PROVIDE NATURAL GAS PRESSURE REGULATOR AS REQUIRED TO PROVIDE 2 PSI PRESSURE FOR NEW GAS LINE. COORDINATE WORK WITH GAS COMPANY (ONG). FIELD VERIFY GAS METER DISCHARGE PRESSURE.

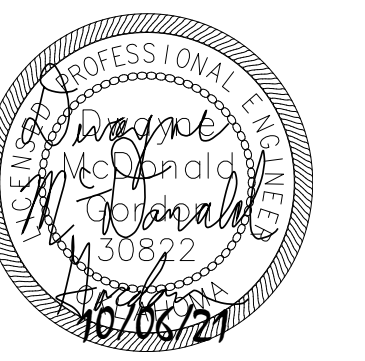

KPP
drawn by
AL
checked by
SEPTEMBER 2021
date
revisions

MOORE PUBLIC SCHOOLS
BOARD OF EDUCATION
MOORE, OKLAHOMA

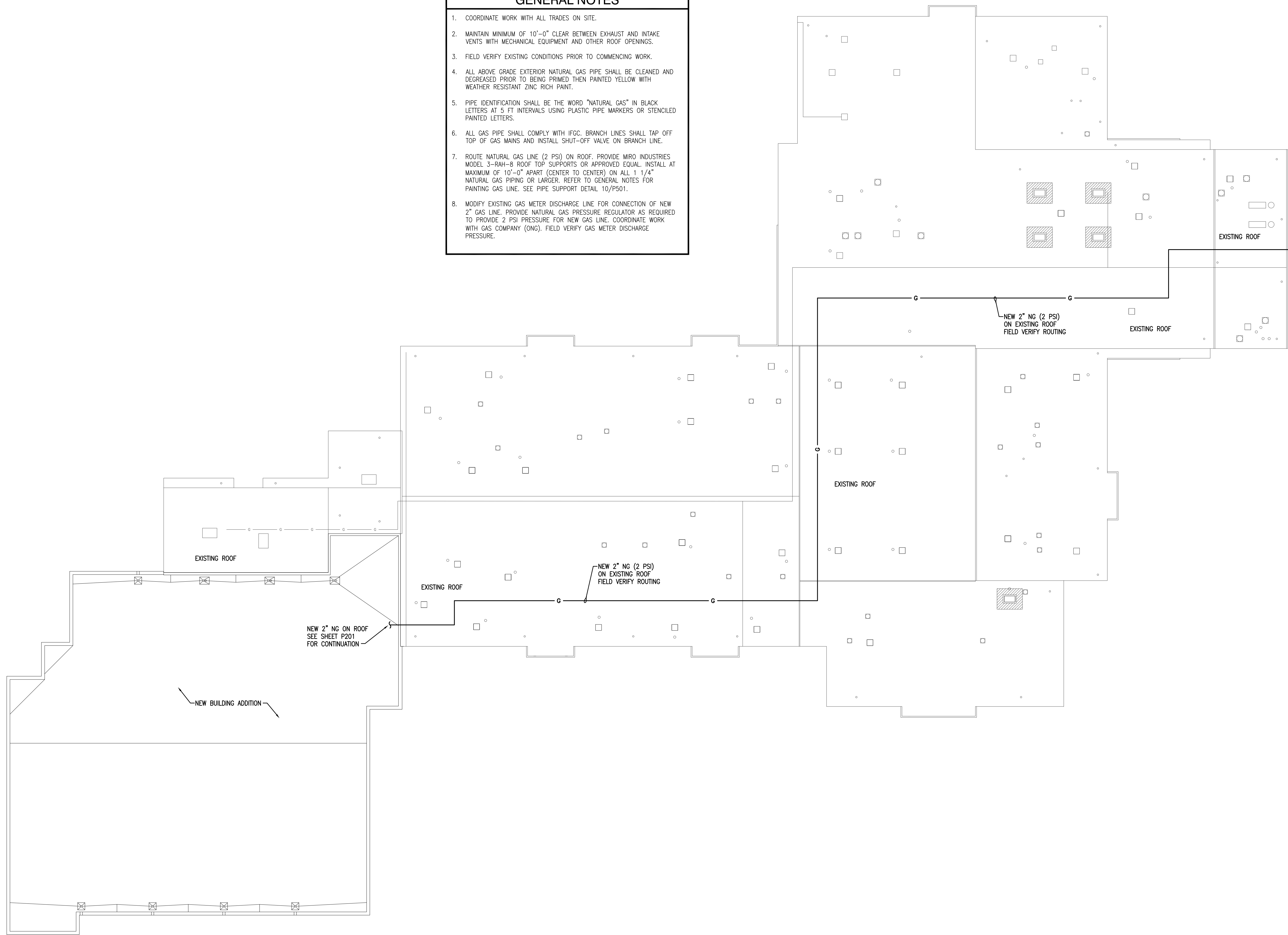

CLASSROOM ADDITION
HIGHLAND EAST
JUNIOR HIGH SCHOOL

sheet no:

P200

1 PLUMBING PLAN - ROOF - OVERALL
1" = 20'-0"

