



8/14/24

CG	
drawn by	
MA	
checked by	
date	JULY 2024
revisions	



MOORE
PUBLIC SCHOOLS

EARL WINE
ELEMENTARY SCHOOL
MEDIA CENTER

Sheet No: **C600**

OWNERSHIP USE OF DOCUMENTS:
APP EXPRESSLY RESERVES ITS
COPYRIGHT AND OTHER PROPERTY
RIGHTS OF ALL PLANS AND DRAWINGS
DESIGNED AND/OR PRODUCED. PLANS
AND DRAWINGS ARE NOT TO BE
REPRODUCED IN ANY FORM OR MANNER
WITHOUT THE EXPRESS WRITTEN
CONSENT OF AGP.

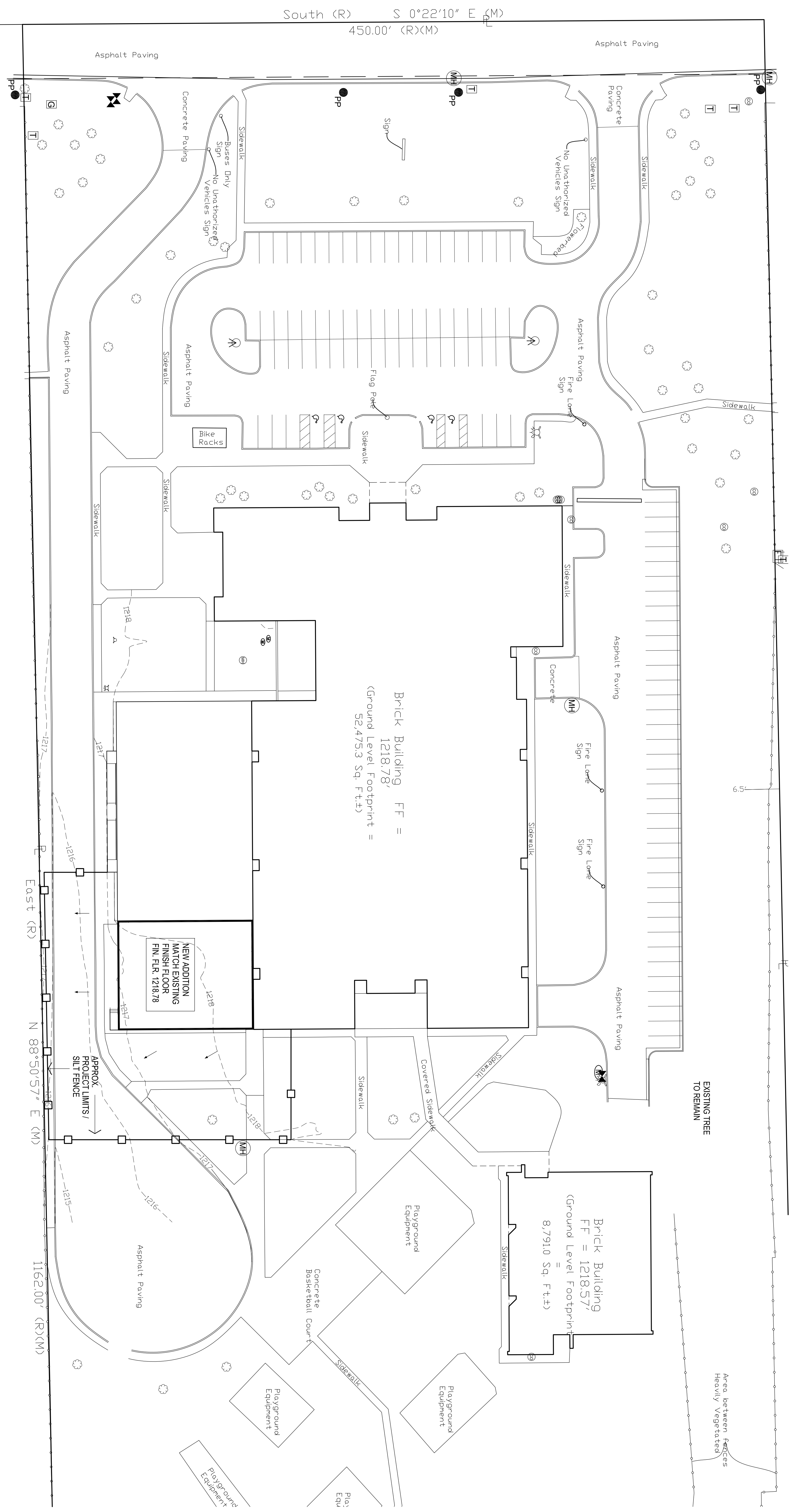

EROSION CONTROL SITE PLAN
1" = 30'-0"

EROSION CONTROL GENERAL NOTES

1. INSTALL PERIMETER EROSION CONTROL DEVICES PRIOR TO REMOVING TOP SOIL OR BEGINNING GRADING ACTIVITIES.
2. INSTALL STABILIZED CONSTRUCTION ENTRANCE IN AN AREA DRAINING INTO THE POLLUTION CONTROL SYSTEM
3. AFTER ALL PRECIPITATION OF 0.5 INCHES OR GREATER, EROSION CONTROL FACILITIES SHALL BE INSPECTED AND MAINTAINED AS NECESSARY. COMPLETED INSPECTION FORMS SHALL BE KEPT ON SITE AND MADE AVAILABLE TO THE INSPECTOR UPON REQUEST.
4. THE CONTRACTOR SHALL INSPECT ALL EROSION CONTROL MEASURES AT LEAST ONCE EVERY 7 DAYS. COMPLETED INSPECTION FORMS SHALL BE KEPT ON SITE AND MADE AVAILABLE TO THE INSPECTOR UPON REQUEST.
5. THE CONTRACTOR SHALL BE RESPONSIBLE FOR THE REPAIR OR REPLACEMENT OF ALL EROSION CONTROL DEVICES DAMAGED DUE TO CONSTRUCTION.
6. A COPY OF THE EROSION CONTROL SITE PLAN MUST BE KEPT ON SITE AT ALL TIMES AND MADE AVAILABLE TO THE INSPECTOR UPON REQUEST.
7. MAINTAIN ALL FACILITIES UNTIL ALL PAVEMENT AND/OR GROUND COVER IS ESTABLISHED. ANY DISTURBED AREA WHICH WILL NOT SEE CONSTRUCTION ACTIVITY FOR 21 DAYS OR MORE SHALL BE TEMPORARILY OR PERMANENTLY STABILIZED WITHIN 14 DAYS OF THE LAST DISTURBANCE.
8. A PERSON IN RESPONSIBLE CHARGE SHALL BE AVAILABLE DURING CONSTRUCTION HOURS TO SUPERVISE IMPLEMENTATION AND MAINTENANCE OF THE POLLUTION PREVENTION PLAN AND TO ASSIST WITH INSPECTIONS BY ANY REGULATORY AGENCY.
9. AFTER COMPLETION OF CONSTRUCTION, REMOVE ALL CONTROL DEVICES & MATERIALS. FILL, COMPACT & GRADE ALL DISTURBED SOIL & RE-SOD.

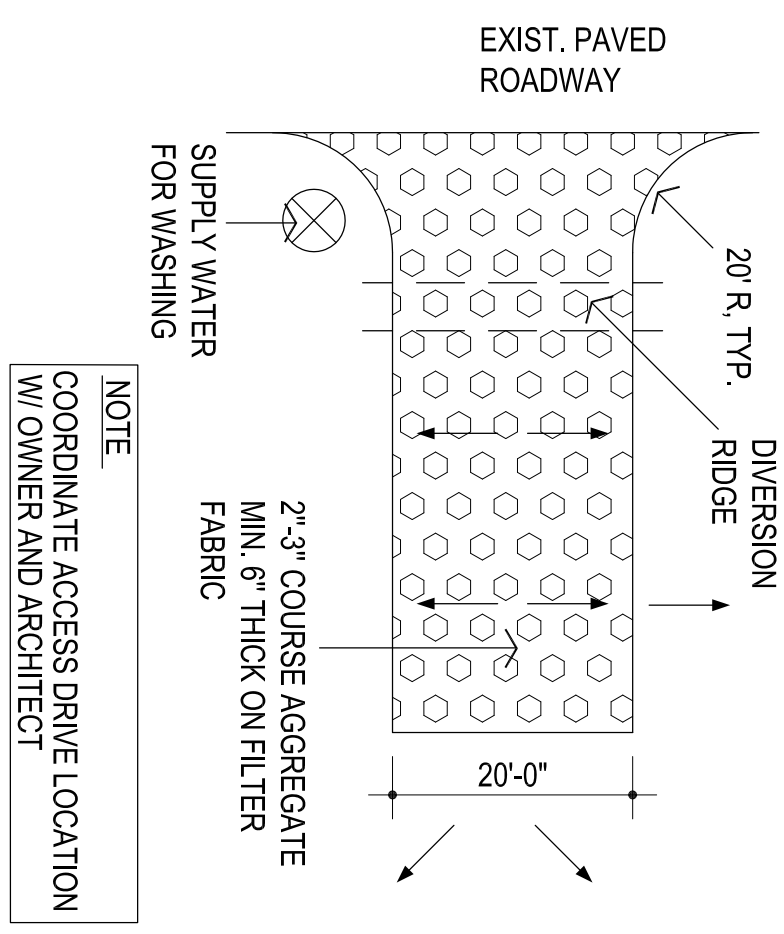

1. THE ENTRANCE SHALL BE MAINTAINED IN A CONDITION THAT WILL PREVENT TRACKING OR FLOWING OF SEDIMENT ONTO PUBLIC RIGHTS-OF-WAY. THIS MAY REQUIRE TOP DRESSING, REPAIR AND/OR CLEANOUT OF ANY MEASURES USED TO TRAP SEDIMENT.
2. WHEN NECESSARY, WHEELS SHALL BE CLEANED PRIOR TO ENTRANCE ONTO PUBLIC RIGHT-OF-WAY.
3. WHEN WASHING IS REQUIRED, IT SHALL BE DONE ON AN AREA STABILIZED WITH CRUSHED STONE THAT DRAINS INTO AN APPROVED SEDIMENT TRAP OR SEDIMENT BASIN.
4. USE SANDBAGS, STRAW BALES OR OTHER APPROVED METHODS TO CHANNELIZE RUNOFF TO BASIN AS REQ'D.
5. DIVERSION RIDGE REQUIRED WHERE GRADE EXCEEDS 2%.

