

8/14/24

CG	
drawn by	
MA	
checked by	
date	JULY 2024
revisions	



**MOORE**  
PUBLIC SCHOOLS

EARL YVINE  
ELEMENTARY SCHOOL  
MEDIA CENTER

**C300**

OWNERSHIP USE OF DOCUMENTS:  
AGP EXPRESSLY RESERVES ITS  
COPYRIGHT AND OTHER PROPERTY  
RIGHTS OF ALL PLANS AND DRAWINGS  
DESIGNED AND/OR PRODUCED. PLANS  
AND DRAWINGS ARE NOT TO BE  
REPRODUCED IN ANY FORM OR MANNER  
WITHOUT THE EXPRESS WRITTEN  
CONSENT OF AGP.

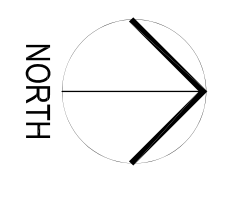
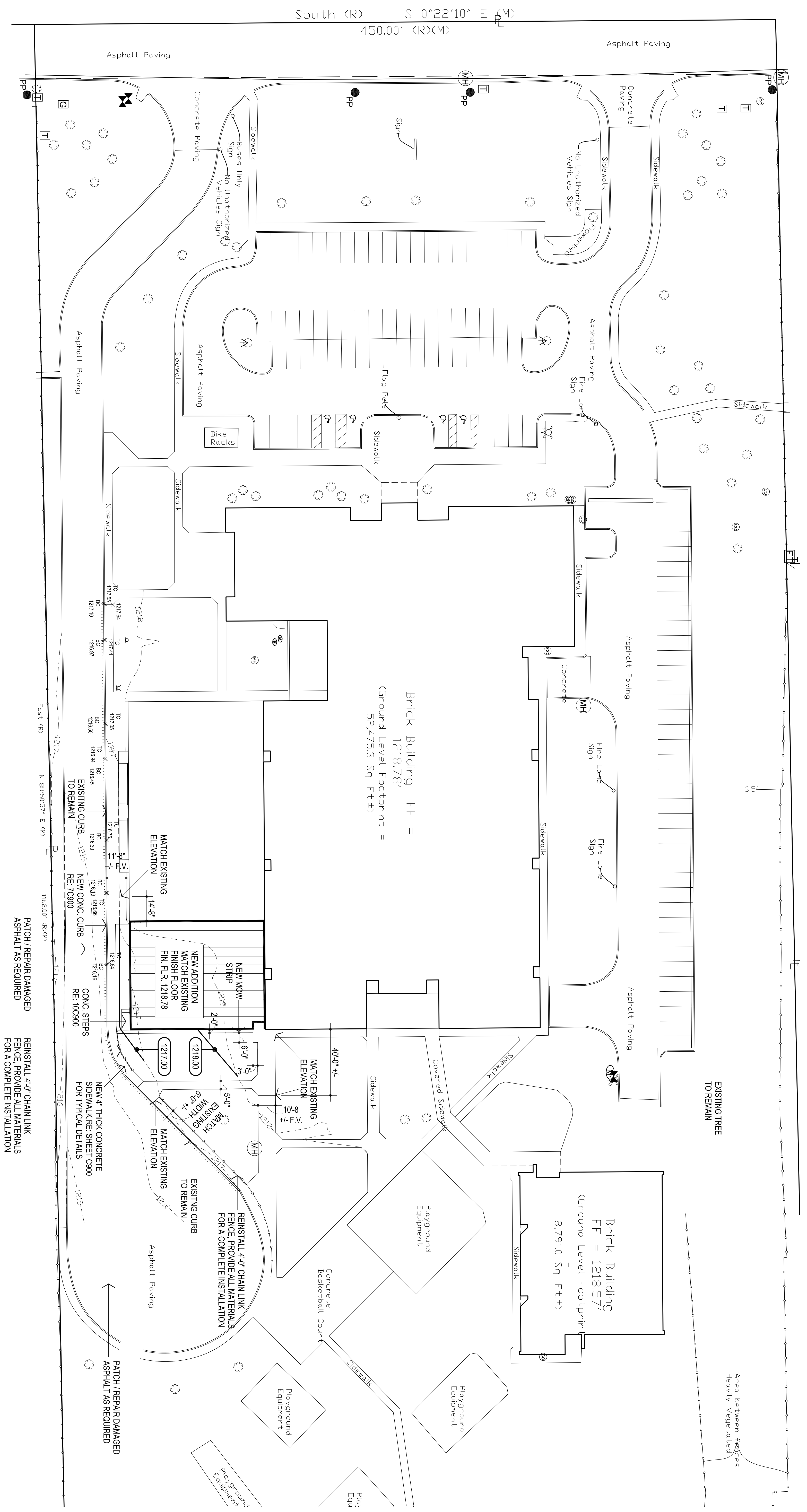

**1**  
PAVING SITE PLAN  
1" = 30'-0"

- NOTE:
- AS PER EXISTING DOCUMENTATION THE EXISTING GRADING IS ADEQUATE TO PROVIDE POSITIVE DRAINAGE AWAY FROM NEW ADDITION FIELD VERIFY & COORDINATE WITH ARCHITECT SET FINAL GRADING ELEVATIONS AS REQUIRED TO INSURE A MAXIMUM SLOPE OF 1:20 FROM NEW DOORS
  - AFTER COMPLETION OF GRADING CONTRACTOR SHALL FINE GRADE ALL DISTURBED SOIL W/ IN PROJECT LIMITS & PREPARE FOR NEW SOD. COORDINATE W/ OWNER & ARCHITECT.
  - PROVIDE "FIRE LANE NO PARKING" MATCH EXISTING - COORDINATE WITH ARCHITECT & AHJ