

Brick Building FF =
1218.78'

(Ground Level Footprint =
52,475.3 Sq. Ft.±)

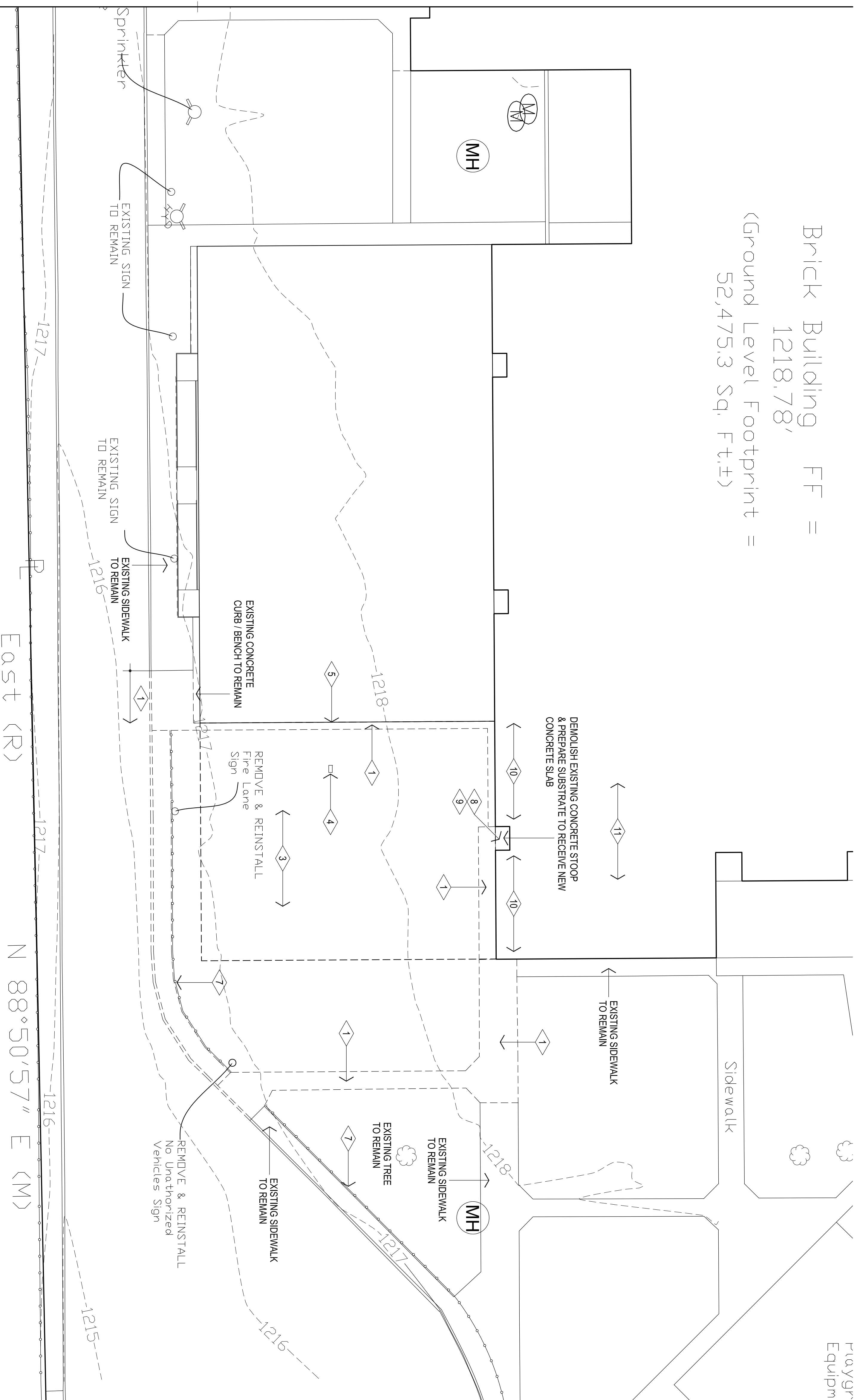

Pruygrc
Equipment

- GENERAL NOTES:**
1. FILL GRADE & PREPARE ALL EXCAVATED AREAS TO RECEIVE NEW SITE FEATURES.
 2. CONTRACTOR TO VISIT SITE PRIOR TO PREPARING BID, & VERIFY ALL ITEMS TO BE DEMOLISHED. ANY ADDITIONAL ITEMS REQUIRING DEMOLITION THAT ARE NOT INCLUDED IN THESE DOCUMENTS SHOULD BE BROUGHT TO THE IMMEDIATE ATTENTION OF THE ARCHITECT AND INCLUDED IN THE BASE BID.
 3. EXISTING UNDERGROUND UTILITY LOCATIONS & CONTOUR INFORMATION HAVE BEEN OBTAINED FROM THE BEST AVAILABLE SOURCES. THE CONTRACTOR SHALL FIELD VERIFY ALL EXISTING CONDITIONS PRIOR TO COMMENCING WORK & COORDINATE W/ ARCHITECT.
 4. CONTRACTOR IS TO FIELD VERIFY ALL EXISTING ELEVATIONS PRIOR TO STARTING EARTHWORK - AND ADJUST ACCORDINGLY AS DIRECTED BY THE ARCHITECT.
 5. DURING ALL EXISTING UTILITY REVISIONS - TEMPORARY SERVICE IS TO BE PROVIDED @ ALL EFFECTED BUILDINGS.
 6. ALL SALVAGEABLE ITEMS TO REMAIN OWNERS PROPERTY & SHALL BE STORED OR DISPOSED OF AS PER OWNERS INSTRUCTIONS.
 7. CONSTRUCTION SHALL MEET ALL APPLICABLE ORDINANCES, REGULATIONS & STANDARDS REQUIRED BY THE CITY OF OKLAHOMA CITY, OKLAHOMA.
 8. CONSTRUCTION SHALL MEET ALL APPLICABLE REQUIREMENTS OF THE AMERICANS W/ DISABILITIES ACT INCLUDING ANY SUPPLEMENTAL REQUIREMENTS BY THE CITY OF OKLAHOMA CITY, OKLAHOMA.
 9. CONTRACTOR SHALL COORDINATE ACCESS TO SITE W/ OWNER PRIOR TO STARTING WORK. OBTAIN APPROVAL FROM OWNER FOR ON-SITE MATERIAL STORAGE, ETC. CONTRACTOR SHALL PROVIDE PROPER SEPARATION BTWN. WORK & STUDENTS.
 10. COORDINATE LOCATION OF CONSTRUCTION FENCE W/ ARCHITECT & OWNER PRIOR TO STARTING WORK. RE: 10890 FOR EROSION CONTROL PLAN.

DEMOLITION NOTES:

1. DEMOLISH EXISTING CONCRETE SIDEWALKS TO LIMITS INDICATED. FILL & COMPACT VOIDS & PREPARE FOR MEDIA CENTER ADDITION. WHERE APPLICABLE, PROTECT EXISTING CONCRETE CURBS TO REMAIN. REPAIR/ REPLACE ANY CURB DAMAGED DURING CONSTRUCTION W/ NEW TO MATCH EXISTING.
2. REMOVE EXISTING SIGN POLE & FOUNDATION COMPLETELY - FILL AND COMPACT VOIDS.
3. THE CONTRACTOR SHALL FIELD VERIFY, INVENTORY & REMOVE ANY SPRINKLER SYSTEM HEADS, PIPING & ASSOCIATED ITEMS WHICH INTERFERE W/ THE NEW BUILDING ADDITION. THE CONTRACTOR SHALL MODIFY REMAINING SYSTEM AS NECESSARY AFTER CONSTRUCTION OF NEW ADDITION TO PROPER WORKING ORDER COORDINATE W/ ARCHITECT.
4. REMOVE EXISTING STORM WATER CLEAN OUT AND PROTECT EXISTING TO REMAIN, RE: C500 & PLUMBING
5. REMOVE EXISTING WALL HYDRANT, RE: PLUMBING
6. REMOVE ALL EXISTING WALL MOUNTED ITEMS TO BE SALVAGED. RE: ELECTRICAL & COORDINATE W/ ARCHITECT & OWNER.
7. REMOVE EXISTING 4'-0" CHAIN LINK FENCE & FOUNDATIONS COMPLETELY - FILL AND COMPACT VOIDS. PROTECT EXISTING FENCE TO BE REINSTALLED. PROVIDE ALL MATERIALS FOR A COMPLETE INSTALLATION.
8. REMOVE EXISTING H.M. FRAME & FRP DOORS AN PREPARE AREA TO RECEIVE NEW WOOD TRIM.
9. REMOVE EXISTING SOFHT AND PREPARE AREA TO RECEIVE NEW GYP. BD. CEILING
10. AT BRICK VENEER TO REMAIN. CLEAN VENEER TO REMOVE ALL STAINS
11. CAREFULLY REMOVE & REINSTALL EXISTING CEILING TILES AS REQUIRED FOR NEW FIRE SUPPRESSION, FIRE ALARM, TECHNOLOGY & ELECTRICAL WORK. RE: MEP & F SHEETS FOR COORDINATION.

AGP
the Abia Griffin
Partnership L.L.C.

313 S. E. 5th Street
MOORE, OK. 73160
405.735.3477
AGP@theAGP.net
www.theAGP.net

KFC ENGINEERING
STRUCTURAL

SALAS O'BRIEN
MECHANICAL / ELECTRICAL



CG
drawn by
MA
checked by
JULY 2024
date
revisions



MOORE
PUBLIC SCHOOLS

EARL WINE
ELEMENTARY SCHOOL
MEDIA CENTER

C200

Sheet No.:
OWNERSHIP USE OF DOCUMENTS:
AGP EXPRESSLY RESERVES ITS
COPYRIGHT AND OTHER PROPERTY
RIGHTS OF ALL PLANS AND DRAWINGS
DESIGNED AND/OR PRODUCED. PLANS
AND DRAWINGS ARE NOT TO BE
REPRODUCED IN ANY FORM OR MANNER
WITHOUT THE EXPRESSED WRITTEN
CONSENT OF AGP.