

ABBREVIATIONS

ABV	ABOVE	ABOVE	HARDWOOD
ACQUST.	ACQUSTICAL	HARDWARE	HARDWARE
ADU.	ADJUSTABLE	HORIZ.	HORIZONTAL
ANCH.	ANCHOR	HT.	HEIGHT
APPROX.	APPROXIMATE	INSUL.	INSULATION
BD.	BOARD	JST.	JOIST
BLG.	BLOCKING	JT.	JUNCTION
BL.	BEAM	L.V.	LAVATORY
BOT.	BOTTOM	MAT.	MATERIAL
C.	CENTERLINE	MAX.	MAXIMUM
CL.G.	CEILING	MECH.	MECHANICAL
CONC.	CONCRETE	MFG.	MANUFACTURING
CMU	CONCRETE MASONRY UNIT	MFR.	MANUFACTURER
COL.	COLUMN	MIS.	MISCELLANEOUS
CONT.	CONTINUOUS	MISC.	MISCELLANEOUS
D.F.	DRINKING FOUNTAIN	N.L.C.	NOT IN CONTRACT
DM.	DIMENSION	NO./#	NUMBER NOT TO SCALE
DR.	DOOR	N.T.S.	NOT TO SCALE
DWG.	DRAWING	O.C.	ON CENTER
DWL.	DOWEL	OPN.G.	OPENING
E.A.	EACH	OP.	OPPOSITE
ELECT.	ELECTRICAL	P.P.	POWER POLE
ELEV.	ELEVATION	PREFN.	PREFINISHED
EQ.	EQUAL	P.T.	PAPER TOWEL
E.I.	EXPANSION JOINT	P.W./PLY WD.	PLYWOOD
E.W.	EACH WAY	RE.D.	REQUIRED
EXST.	EXISTING	RE.D.	REQUIRED
EXT.	EXTERIOR	R.M.	ROOM
FE.	FIRE EXTINGUISHER	S.B.	SCHEDULE
FEC.	FIRE EXTINGUISHER CABINET	SCHD.	SCHEDULE
FEL.	FINISH FLOOR LINE	STL.	STEEL
FIN.	FINISH	S.U.	SAWJOINT
FRMG.	FRAMING	T.C.	TOP OF CURB
GA.	GAUGE	T.P.H.	TYPICAL
G.B.	GALVANIZED	TYP.	TYPICAL
GALV.	GALVANIZED	UNO.	UNLESS NOTED OTHERWISE
GYP.	GYP-SUM BOARD	VTR.	VENT THROUGH ROOF
H.C.	HANDICAP	W.C.	WATERCLOSET
		WD.	WOOD
		WWF.	WELDED WIRE FABRIC

MATERIALS LEGEND

	MASONRY VENEER
	C.M.U.
	CONCRETE
	FRAME PARTITION, METAL STUDS
	FOR DETAILS
	GYP-SUM BOARD
	PARTICLE BOARD
	RIGID INSULATION
	WOOD BLOCKING / FRAMING, CONTINUOUS
	WOOD BLOCKING, DISCONTINUOUS
	FINISH WOOD
	SMALL SCALE STRUCTURAL STEEL / MISCELLANEOUS METAL
	LARGE SCALE STRUCTURAL STEEL
	BATT INSULATION
	ACOUSTICAL CEILING TILE
	EARTH FILL

SYMBOLS LEGEND

	EXISTING SPOT ELEVATION
	FINISH SPOT ELEVATION
	EXISTING GRADE CONTOUR
	FINISH GRADE CONTOUR
	EXISTING TREE TO BE PROTECTED
	EXISTING TREE TO BE REMOVED
	PROJECT LIMITS
	CHANLINK FENCE
	BARBED WIRE FENCE
	CONCRETE PAVING
	ASPHALT PAVING
	CONCRETE SIDEWALK
	EXISTING PAVING/SIDEWALK TO REMAIN
	EXISTING PAVING TO BE REMOVED
	NEW BUILDING
	EXISTING BUILDING - NO WORK
	ROOM NUMBER
	ROOM NUMBER, LARGE SCALE PLAN REFERENCE
	ROOM NUMBER, INTERIOR ELEVATION REFERENCE
	WALL SECTION/DETAIL CUT MARK
	LARGE SCALE DETAIL MARK
	STRUCTURAL GRID COORDINATES
	BUILDING SECTION CUT MARK
	DOOR NUMBER
	WINDOW MARK
	FRAME MARK
	GLAZING MATERIAL MARK
	EQUIPMENT MARK
	EXTERIOR ELEVATION MARK
	TEST HOLE
	BENCH MARK/BUILDING ELEVATION (SECTION)

GENERAL NOTES:

- ALL REQUIRED HANDICAP ACCESSIBLE ITEMS TO COMPLY WITH AMERICANS WITH DISABILITIES ACT AND ARCHITECTURAL BARRIERS ACT ACCESSIBILITY GUIDELINES.
- THE CONTRACTOR SHALL NOT USE ANY LEAD-BASED PAINT OR ASBESTOS CONTAINING MATERIAL ON THIS PROJECT.
- THESE CONTRACT DOCUMENTS INCLUDING BUT NOT LIMITED TO THE DRAWINGS, PROJECT MANUAL, AND ANY SUBSEQUENT ADDENDA ARE ISSUED AS A "WHOLE" AND SHALL BE BID AS SUCH. EACH DISCIPLINE / SUBCONTRACTOR SHALL REVIEW THE ENTIRE SET OF CONTRACT DOCUMENTS AND INCLUDE APPLICABLE WORK IN THEIR BID REGARDLESS OF LOCATION WITHIN THE CONTRACT DOCUMENTS. REVIEWING ONLY A PORTION OF THE CONTRACT DOCUMENTS SHALL NOT ABSOLVE THE CONTRACTOR OR SUBCONTRACTOR OF THE REQUIREMENT TO PERFORM THE WORK OF THEIR RESPECTIVE DISCIPLINES.
- LOCATIONS OF EXISTING BUILDINGS, SITE FEATURES, & UNDERGROUND UTILITIES HAVE BEEN OBTAINED FROM EXISTING AVAILABLE SOURCES. THE CONTRACTOR IS TO FIELD VERIFY EXISTING LOCATIONS PRIOR TO STARTING CONSTRUCTION AND NOTIFY THE ARCHITECT IMMEDIATELY IF ANY EXISTING BUILDING OR SITE FEATURE CONFLICTS WITH THE NEW CONSTRUCTION.
- THE CONTRACTOR SHALL VERIFY ALL EXISTING UTILITIES AND PROTECT DURING CONSTRUCTION. COORDINATE NEW UTILITY REQUIREMENTS WITH APPLICABLE UTILITY COMPANIES (WATER, GAS, ELECTRICITY, SANITARY, SEWER, TELEPHONE, CABLE, SITE DRAINAGE AND OTHERS AS REQUIRED). COMPLY WITH ALL APPLICABLE REGULATIONS. INCLUDE ALL CONNECTION FEES AND OTHER CHARGES IN BID.
- NOT USED
- NOT USED
- NOT USED
- CONFLICTS BETWEEN DRAWINGS AND SPECIFICATIONS SHALL BE BROUGHT TO ARCHITECTS ATTENTION. FAILURE TO BID ITEMS NOTED ON DRAWINGS AND OMITTED FROM SPECIFICATIONS DOES NOT REMOVE RESPONSIBILITY TO PROVIDE AND INSTALL SUCH.

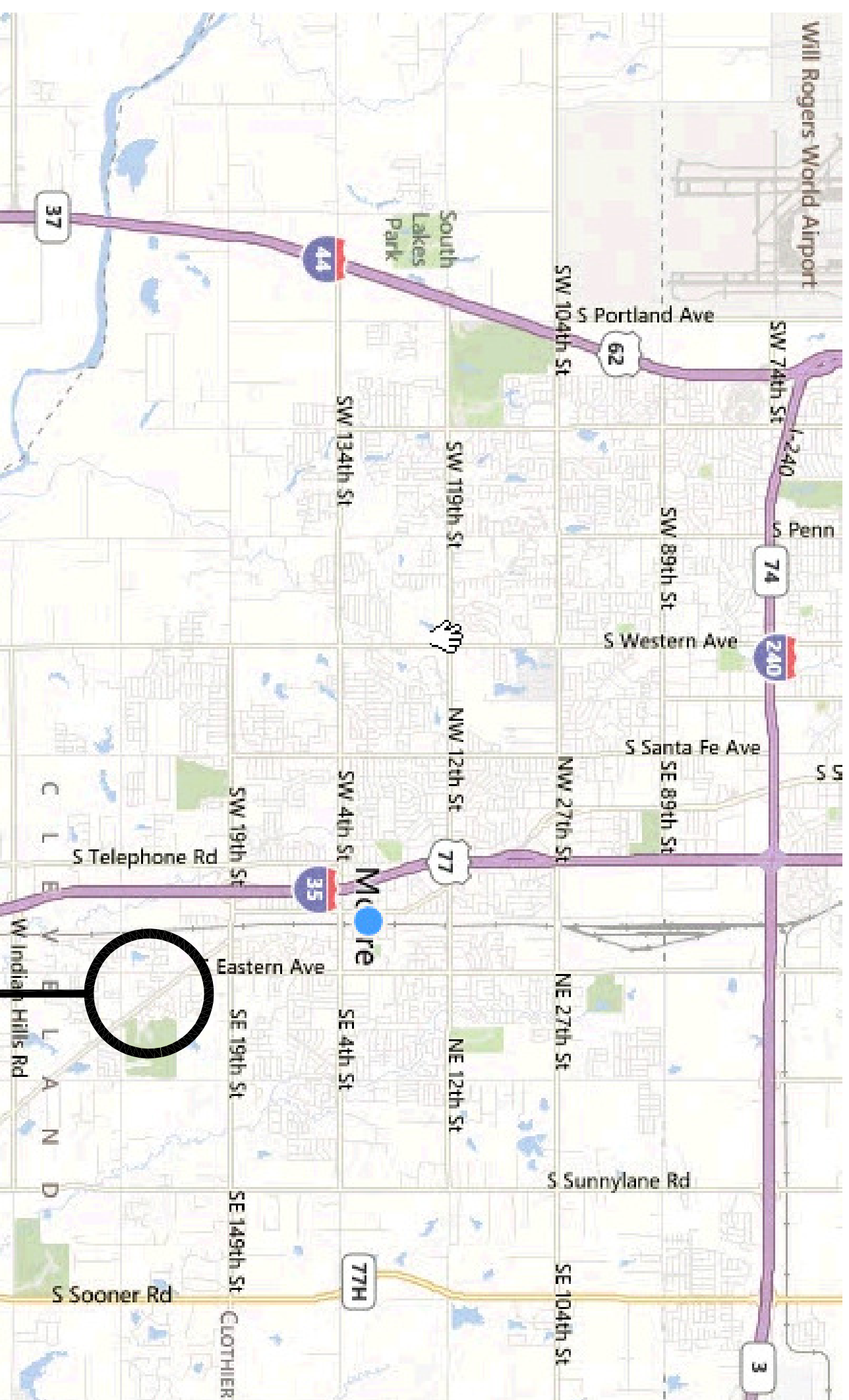

BROADMOORE ELEMENTARY SCHOOL
3401 SOUTH BROADWAY
MOORE, OKLAHOMA 73160

VICINITY MAP

PROJECT LOCATION

LEGAL DESCRIPTION

A PART OF THE SW 1/2 OF SECTION 25, T10N, R3W, 1M, CLEVELAND COUNTY, OKLAHOMA, MORE PARTICULARLY DESCRIBED AS FOLLOWS, COMMENCING AT THE S.W. CORNER OF THE SW 1/2 OF SAID SECTION 25, T10N, R3W, 1M.; THENCE N89° 40' 20" E. ON THE SOUTH LINE OF SAID S.W. 1/2 OF SECTION 25, T10N, R3W, 1M, A DISTANCE OF 1,317.25 FEET; THENCE N 0° 21' 12" W, A DISTANCE OF 103.0 FEET TO A TRUE POINT OF BEGINNING; THENCE N 0° 21' 12" W, A DISTANCE OF 582.36' TO THE S.E. CORNER OF BROADWAY TERRACE ADDITION A RECORDED PLAT; THENCE N0° 02' 09" W ON THE EAST LINE OF BOARD WAY TERRACE ADDITION A DISTANCE OF 131.74 FEET; THENCE N 89° 40' 21" E, A DISTANCE OF 381.40 FEET; THENCE S 37° 13' 17" E, BEING 50 FEET WEST AND PARALLEL TO THE CENTERLINE, U.S. HIGHWAY NO. 77 (SOUTH BROADWAY) A DISTANCE OF 892.0 FEET; THENCE S 89° 40' 21" A DISTANCE OF 977.94 FEET TO THE TRUE POINT OF BEGINNING. THIS TRACT CONTAINS 10.66 ACRES MORE OR LESS.



1/23/23

CS
drawn by
MA
checked by
JANUARY 2023
date
revisions

MOORE PUBLIC SCHOOLS
BOARD OF EDUCATION
MOORE, OKLAHOMA

MOORE Public Schools
LEARNING FOR LIFE

BROADMOORE
ELEMENTARY SCHOOL
2023 MILLWORK
REPLACEMENT

Sheet No.
G100

OWNERSHIP USE OF DOCUMENTS:
AGP EXPRESSLY RESERVES ITS
COPYRIGHT AND OTHER PROPERTY
RIGHTS OF ALL PLANS AND DRAWINGS
DESIGNED AND/OR PRODUCED BY AGP.
REPRODUCTION IN ANY FORM OR MANNER
WITHOUT THE EXPRESSED WRITTEN
CONSENT OF AGP.