

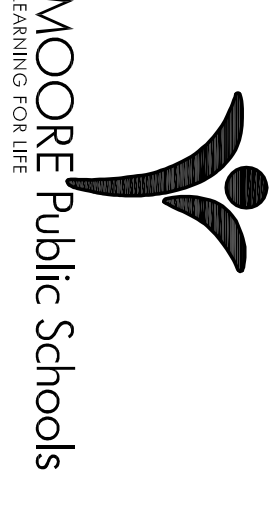

CS _____
drawn by _____
MA _____
checked by _____
JANUARY 2023
date _____
revisions _____

MOORE PUBLIC SCHOOLS
BOARD OF EDUCATION
MOORE, OKLAHOMA



BROADMOORE
ELEMENTARY SCHOOL
2023 MILLWORK
REPLACEMENT

Sheet No.

A102

OWNERSHIP USE OF DOCUMENTS:

AGP EXPRESSLY RESERVES ITS
COPYRIGHT AND OTHER PROPERTY
RIGHTS OF ALL PLANS AND DRAWINGS
DESIGNED AND/OR PRODUCED BY AGP.
REPRODUCTION IN ANY FORM OR MANNER
WITHOUT THE EXPRESSED WRITTEN
CONSENT OF AGP.



FLOOR PLAN
ROOM TYPE "C"
ROOM TYPE "D"
1/4" = 1'-0"

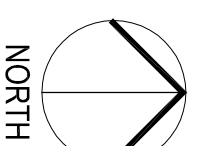

2

GENERAL DEMOLITION NOTES:

1. ALL SALVAGEABLE ITEMS TO REMAIN THE OWNERS PROPERTY & IS TO BE DISPOSED OF / STORED AS PER OWNERS INSTRUCTIONS.
2. CARE IS TO BE TAKEN TO PROTECT ALL EXISTING ITEMS TO REMAIN. THE CONTRACTOR IS RESPONSIBLE FOR REPLACING / REPAIRING ALL EXISTING TO REMAIN ITEMS THAT ARE DAMAGED DURING CONSTRUCTION.
3. THE SUBCONTRACTORS ARE RESPONSIBLE FOR VISITING THE SITE PRIOR TO SUBMITTING A BID & OBTAINING ALL PERTINENT INFORMATION RECD. TO PREPARE AN ACCURATE BID. VERIFY ALL DEMOLITION & NEW WORK REQUIRED. ANY REQUIRED ADDITIONAL WORK NOT INDICATED ON THE CONTRACT DOCUMENTS MUST BE BROUGHT TO THE IMMEDIATE ATTENTION OF THE GENERAL CONTRACTOR PRIOR TO BIDDING.
4. REFER 1A100 FOR LOCATIONS OF TYPE "C" & TYPE "D" ROOMS, INCLUDING "OPPOSITE" ROOMS.
5. VERIFY CLEARANCES FOR THERMOSTATS, SWITCHES, CALL BUTTONS, ETC. COORDINATE W/ ARCHITECT

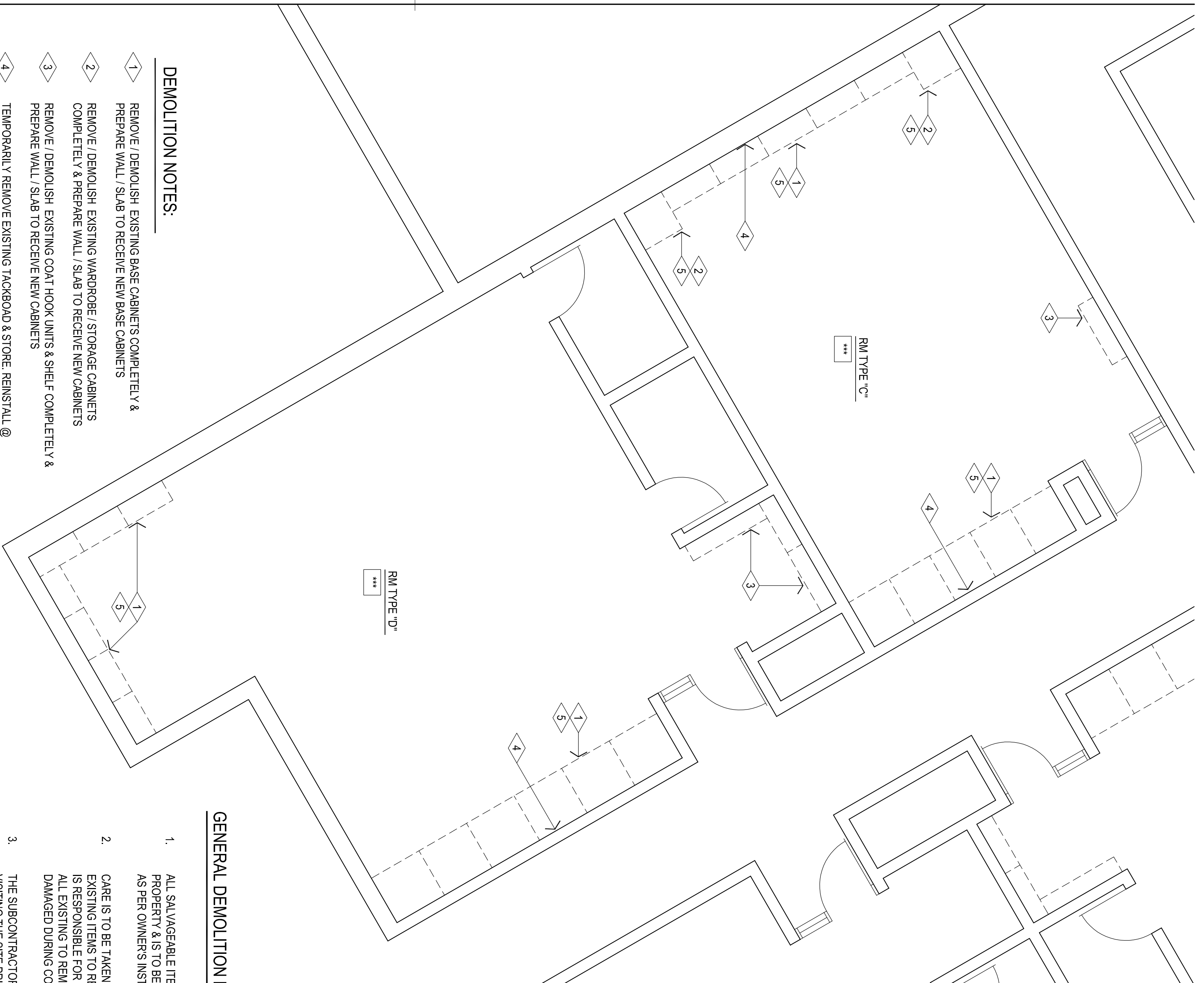

DEMOLITION FLOOR PLAN
ROOM TYPE "C"
ROOM TYPE "D"
1/4" = 1'-0"

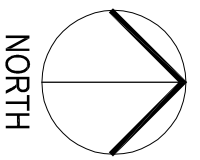

1

DEMOLITION NOTES:

1. REMOVE / DEMOLISH EXISTING BASE CABINETS COMPLETELY & PREPARE WALL / SLAB TO RECEIVE NEW BASE CABINETS
2. REMOVE / DEMOLISH EXISTING WARDROBE / STORAGE CABINETS COMPLETELY & PREPARE WALL / SLAB TO RECEIVE NEW CABINETS
3. REMOVE / DEMOLISH EXISTING COAT HOOK UNITS & SHELF COMPLETELY & PREPARE WALL / SLAB TO RECEIVE NEW CABINETS
4. TEMPORARILY REMOVE EXISTING TACKBOARD & STORE. REINSTALL @ SAME LOCATIONS AFTER INSTALLATION OF NEW BASE CABINETS & WARDROBE CABINETS / SHELVING UNITS
5. REMOVE EXISTING CARPET TILES AS NECESSARY TO INSTALL NEW CABINETS / SHELVING. COORDINATE NEW CARPET AND BASE INSTALLATION W/ OWNERS FLOORING INSTALLER